

LATERAL GUIDE
(TYPICAL EACH SIDE)

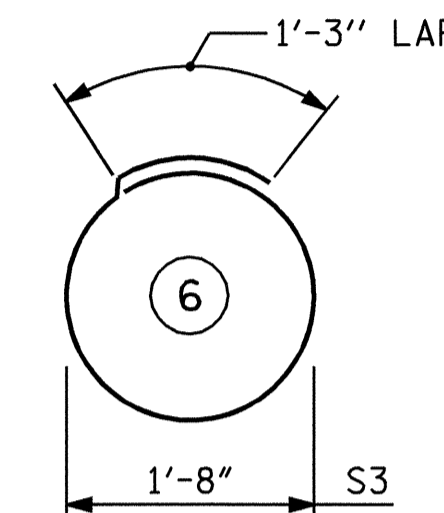
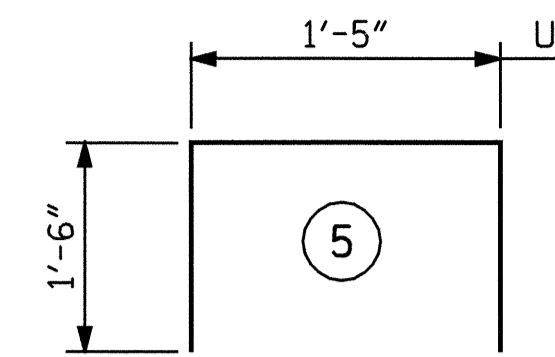
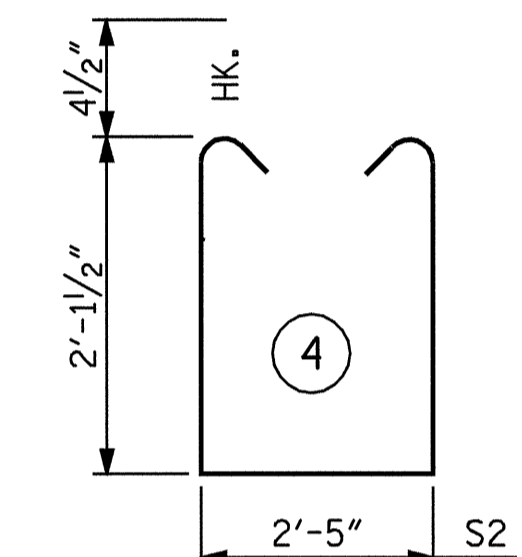
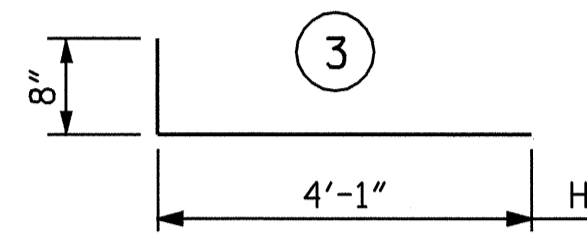
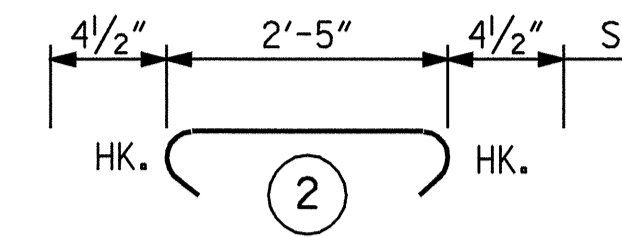
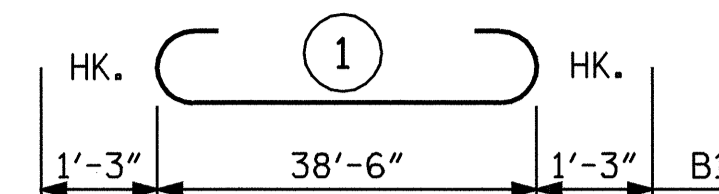

ALL BAR DIMENSIONS ARE OUT TO OUT.

BILL OF MATERIAL

END BENT #1

BAR	NO.	SIZE	TYPE	LENGTH	WEIGHT
B1	8	#9	1	41'-0"	1115
B2	2	#5	STR	38'-8"	81
B3	8	#4	STR	20'-7"	110
B4	10	#4	STR	2'-5"	16
D1	22	#6	STR	1'-6"	50
H1	24	#4	3	4'-9"	76
K1	12	#4	STR	2'-6"	20
S1	35	#4	2	3'-2"	74
S2	35	#4	4	7'-5"	173
S3	12	#4	6	6'-6"	52
U1	4	#4	5	4'-5"	12
V1	32	#4	STR	3'-11"	84

REINFORCING STEEL = 1863 LBS.

CLASS A CONCRETE BREAKDOWN

POUR #1 CAP & LOWER PART OF WINGS	10.6	C.Y.
POUR #2 UPPER PART OF WINGS	0.9	C.Y.
POUR #3 LATERAL GUIDES	0.1	C.Y.
TOTAL CLASS A CONCRETE	11.6	C.Y.

HP 12 X 53 STEEL PILES
No. 6 90 LIN. FT.

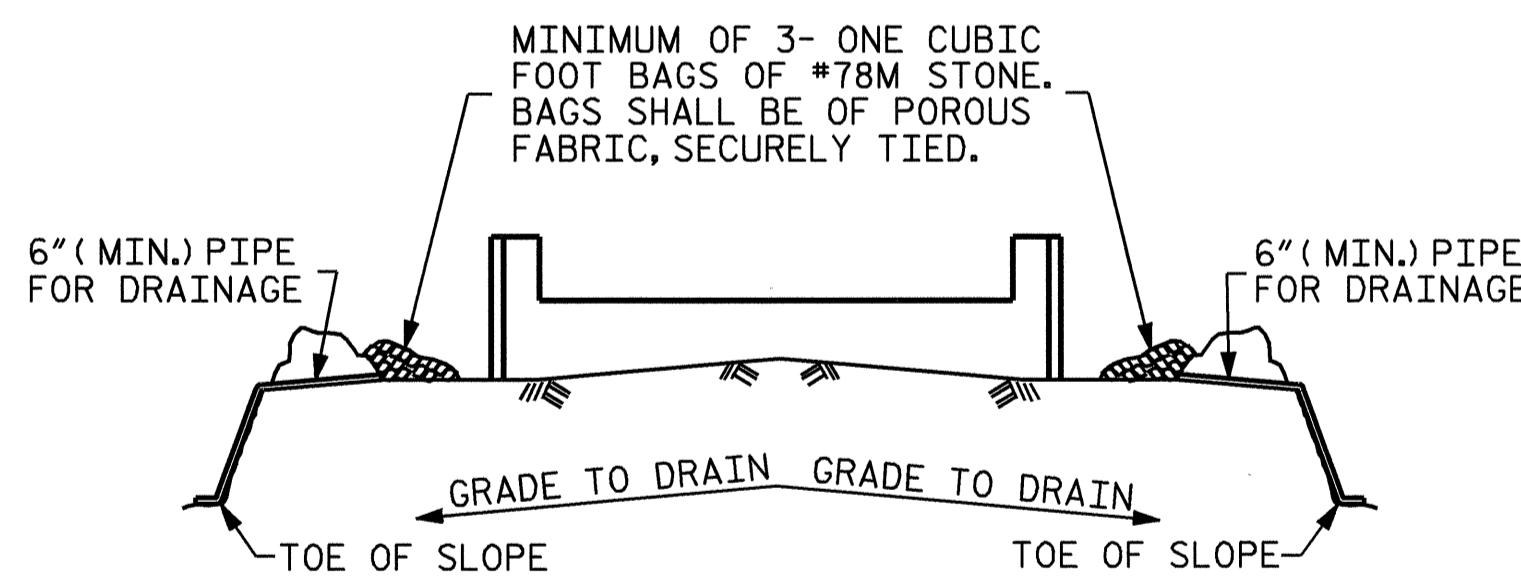

BAGGED STONE AND PIPE SHALL BE PLACED IMMEDIATELY AFTER COMPLETION OF END BENT EXCAVATION. PIPE MAY BE EITHER CONCRETE, CORRUGATED STEEL, CORRUGATED ALUMINUM ALLOY, OR CORRUGATED PLASTIC. PERFORATED PIPE WILL NOT BE ALLOWED.

BAGGED STONE SHALL REMAIN IN PLACE UNTIL THE ENGINEER DIRECTS THAT IT BE REMOVED. THE CONTRACTOR SHALL REMOVE AND DISPOSE OF SILT ACCUMULATIONS AT BAGGED STONE WHEN SO DIRECTED BY THE ENGINEER. BAGS SHALL BE REMOVED AND REPLACED WHENEVER THE ENGINEER DETERMINES THAT THEY HAVE DETERIORATED AND LOST THEIR EFFECTIVENESS.

NO SEPARATE PAYMENT WILL BE MADE FOR THIS WORK AND THE ENTIRE COST OF THIS WORK SHALL BE INCLUDED IN THE UNIT CONTRACT PRICE BID FOR THE SEVERAL PAY ITEMS.

TEMPORARY DRAINAGE AT END BENT

PROJECT NO. B-4515
FRANKLIN COUNTY
STATION: 15+37.00 -L-

SHEET 3 OF 3

STATE OF NORTH CAROLINA
DEPARTMENT OF TRANSPORTATION
RALEIGH

SUBSTRUCTURE
END BENT #1

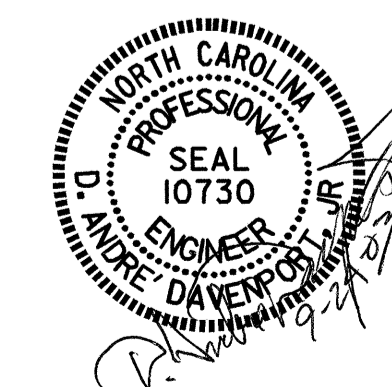

REVISIONS						SHEET NO.
NO.	BY:	DATE:	NO.	BY:	DATE:	S-13
1			3			TOTAL SHEETS
2			4			24

DRAWN BY : S.P. LAM DATE : 06-23-04
CHECKED BY : H.T. BARBOUR DATE : 07-04