

WOODS

-L-
Pls Sta 28+75.548
Θs = 157° 51' 9"
Ls = 60.000
LT = 40.002
ST = 20.002

-L-
Pls Sta 31+60.010
Δ = 34° 21' 11" (LT)
L = 524.628
R = 875.000

-L-
Pls Sta 33+90.174
Θs = 157° 51' 9"
Ls = 60.000
LT = 40.002
ST = 20.002

-LREV-
Pls Sta 28+62.544
Θs = 2° 56' 47.9"
Ls = 90.000
LT = 60.008
ST = 30.008

-LREV-
Pls Sta 31+46.653
Δ = 32° 23' 19" (LT)
L = 494.627
R = 875.000
Se = 0.06
DS = 105 km/h

-LREV-
Pls Sta 34+17.171
Θs = 2° 56' 47.9"
Ls = 90.000
LT = 60.008
ST = 30.008

PROJECT REFERENCE NO. R-977A	SHEET NO. 10
HIGHWAY DESIGN ENGINEER	HYDRAULICS ENGINEER

WILLIAM R. & LAURA K. DYER
DB 641 PG 1
DB 601 PG 165

L.F. & HELEN H. LOCHABY
DB 159 PG 136

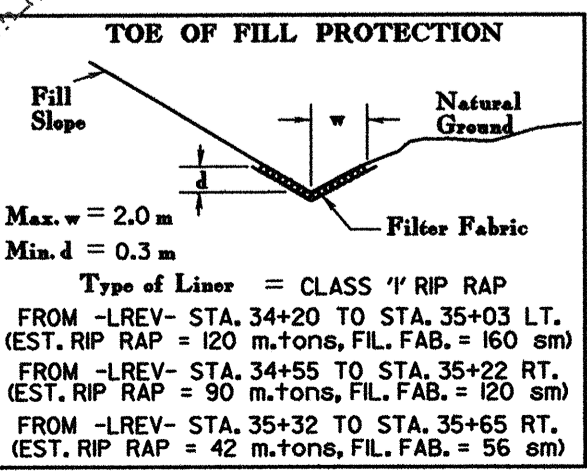
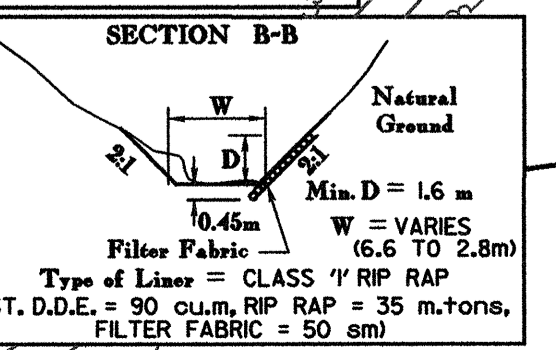
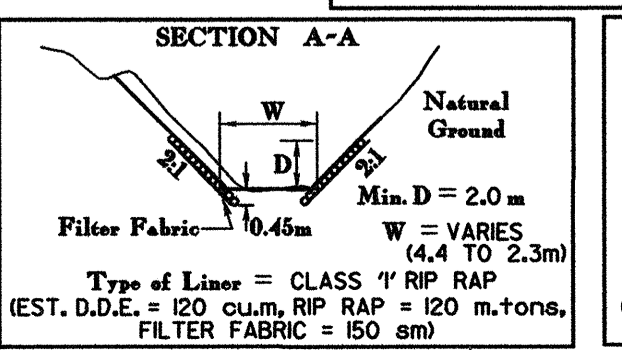
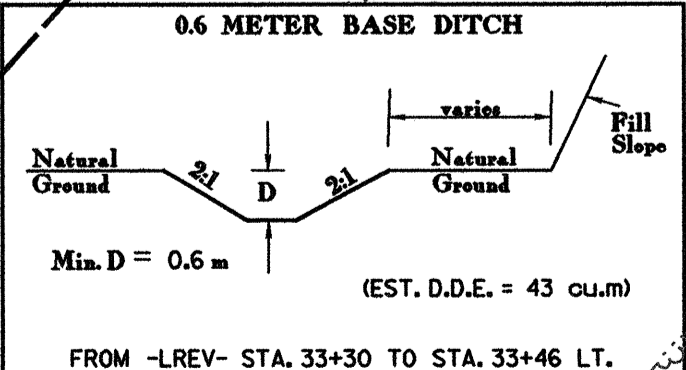
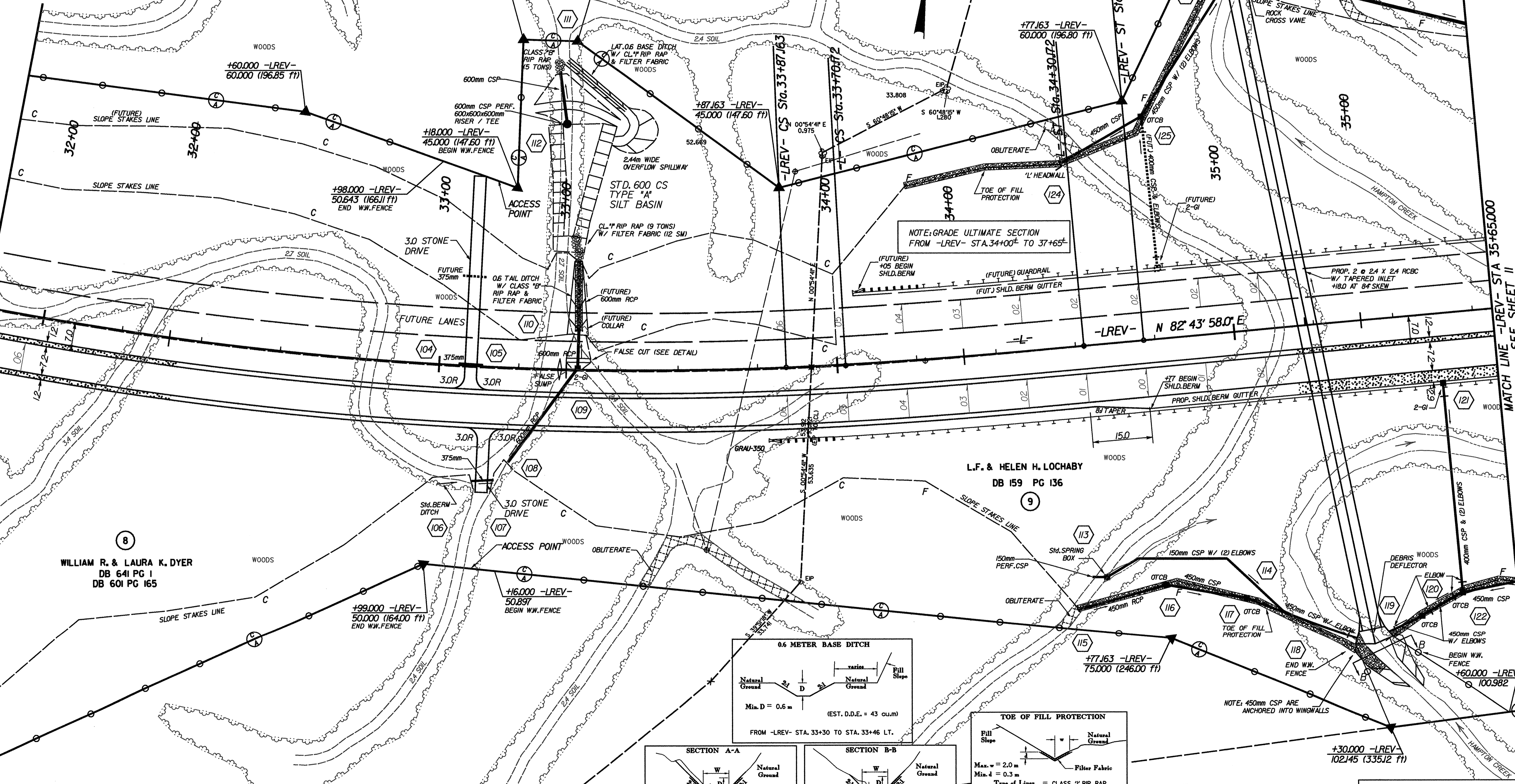

SEE SHEET 9
MATCH LINE -LREV- STA 31+85.000

MATCH LINE -LREV- STA 35+65.000
SEE SHEET 11

WILLIAM R. & LAURA K. DYER
DB 641 PG 1
DB 601 PG 165

L.F. & HELEN H. LOCHABY
DB 159 PG 136

SEE SHEET 37 FOR -LREV- PROFILES
SEE PROFILES FOR DITCH GRADES
SEE CULVERT PLANS C- TO C-

LOCHNER
H. W. LOCHNER, INC.
2840 PLAZA PLACE, SUITE 202
RALEIGH, NC 27612