

REVISIONS

NOTE: GRADE ULTIMATE SECTION FROM -LREV- STA. 45+80 TO 47+60

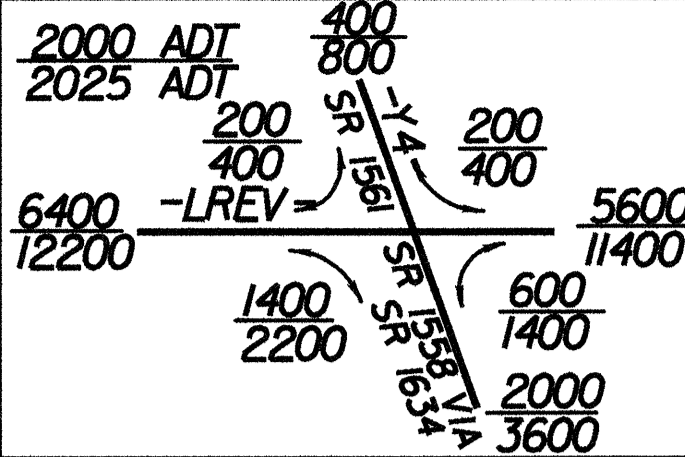

-LREV- Pls Sta 37+70.910 PI Sta 42+40.027 ... -LREV- Pls Sta 46+91.382 PI Sta 42+40.027 ... -LREV- Pls Sta 46+91.382 PI Sta 42+40.027 ...

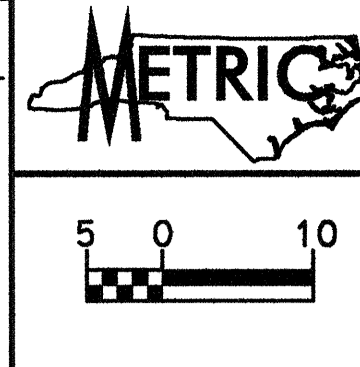
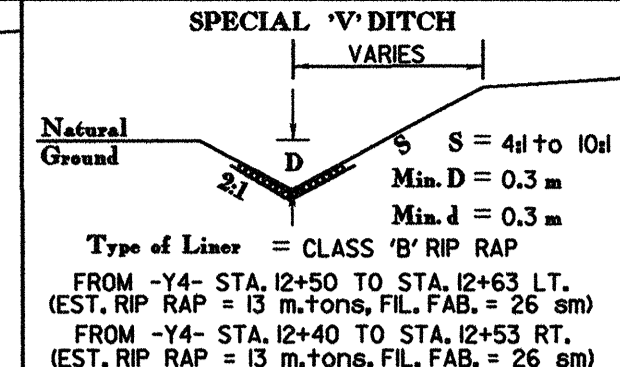
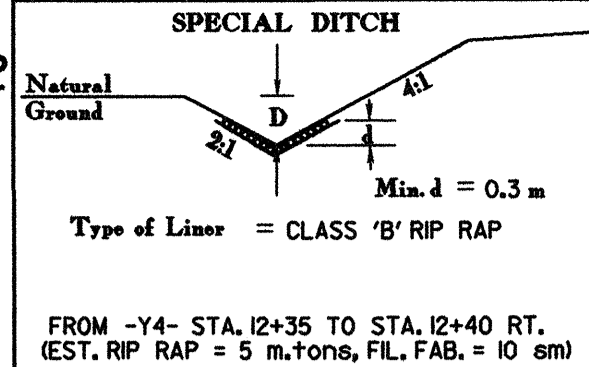

PROJECT REFERENCE NO. R-977A SHEET NO. 14. Includes professional engineer seals for North Carolina and project details.

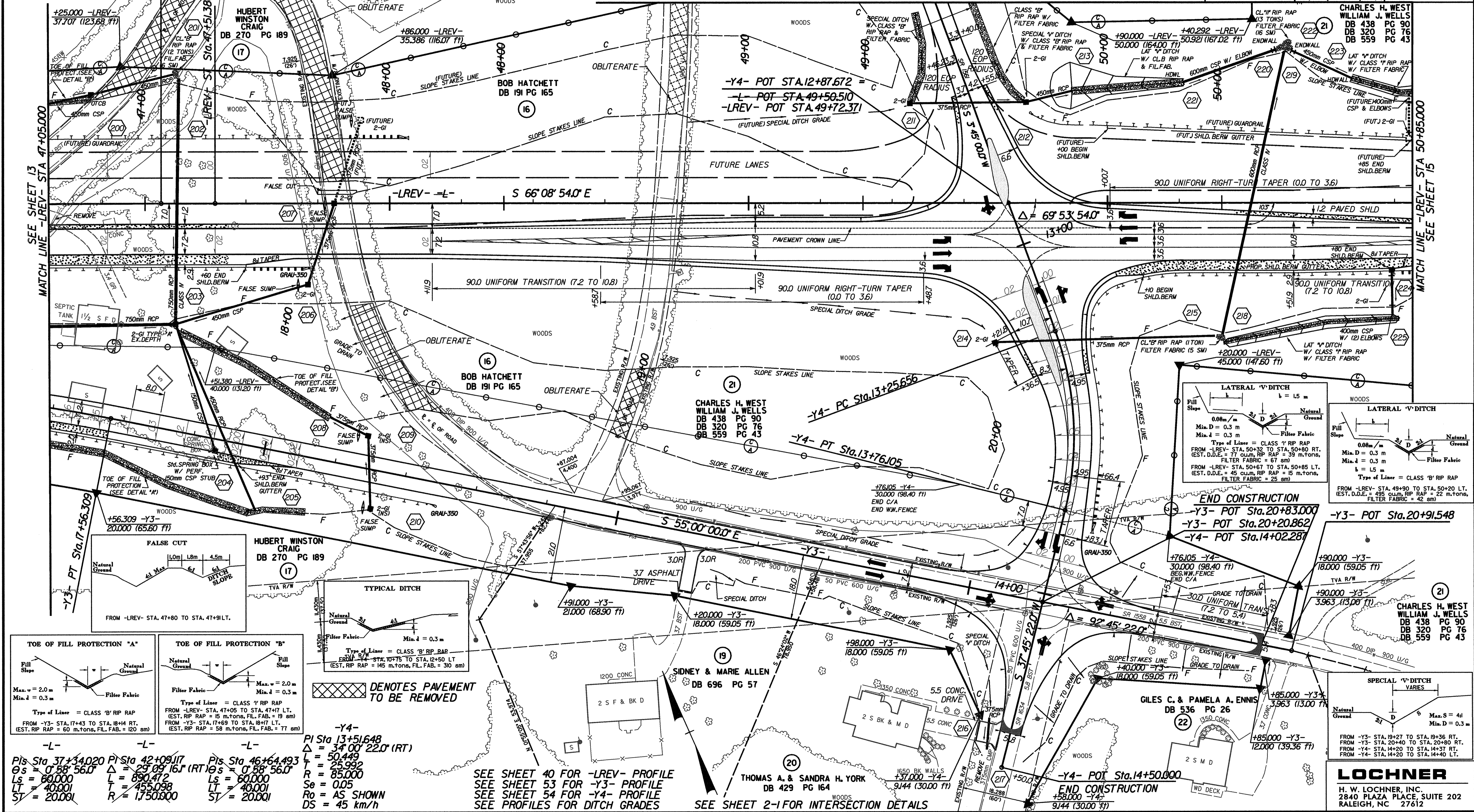

SEE SHEET 13 MATCH LINE -LREV- STA 47+05.000

MATCH LINE -LREV- STA 50+85.000 SEE SHEET 15

SEE SHEET 26 MATCH LINE -Y4- STA 12+28.533

NOTE: GRADE ULTIMATE SECTION FROM -LREV- STA. 50+00 TO 51+00

CONST. REV. R/W REV.

CHARLES H. WEST WILLIAM J. WELLS DB 438 PG 90 DB 320 PG 76 DB 559 PG 43

CHARLES H. WEST WILLIAM J. WELLS DB 438 PG 90 DB 320 PG 76 DB 559 PG 43

CHARLES H. WEST WILLIAM J. WELLS DB 438 PG 90 DB 320 PG 76 DB 559 PG 43

END CONSTRUCTION

-Y3- POT Sta. 20+83.000 -Y3- POT Sta. 20+20.862 -Y4- POT Sta. 14+02.287

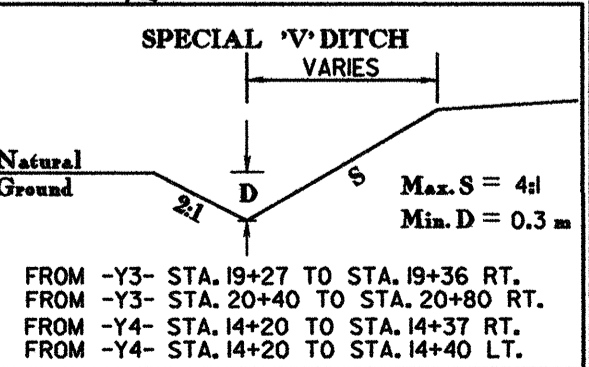

LOCHNER H. W. LOCHNER, INC. 2840 PLAZA PLACE, SUITE 202 RALEIGH, NC 27612

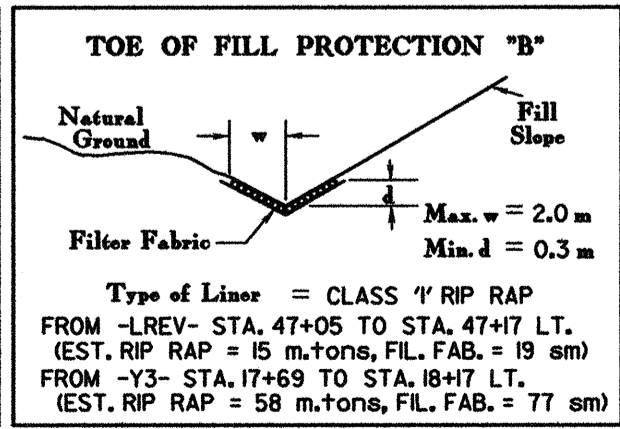
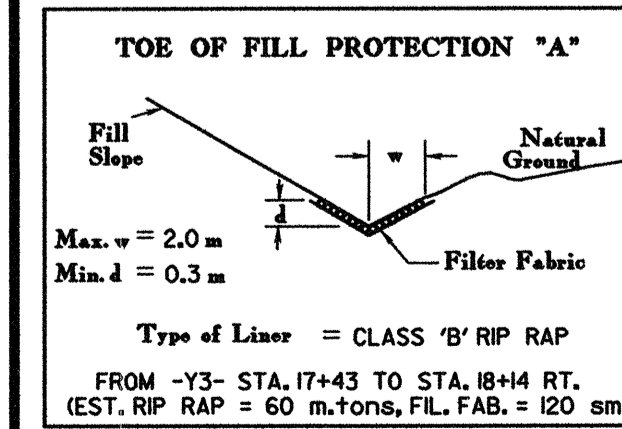

DENOTES PAVEMENT TO BE REMOVED

-L- Pls Sta 37+34.020 PI Sta 42+09.117 ... -L- Pls Sta 46+64.493 PI Sta 42+09.117 ...

-Y4- PI Sta 13+51.648 Δ = 34'00" 22.0 (RT) L = 50.449 ...

SEE SHEET 40 FOR -LREV- PROFILE SEE SHEET 53 FOR -Y3- PROFILE SEE SHEET 54 FOR -Y4- PROFILE SEE PROFILES FOR DITCH GRADES

SEE SHEET 2-1 FOR INTERSECTION DETAILS