

CONST. REV.

R/W REV.

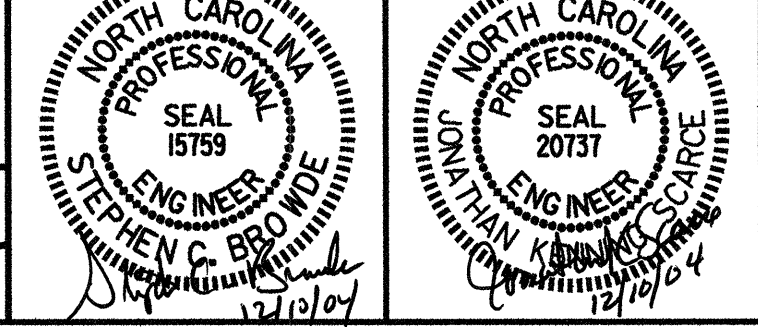

-LREV- -LREV- -LREV- -L- -L- -L-

Pts Sta 52+50.153 Pts Sta 55+58.285 Pts Sta 58+56.205 Pts Sta 52+13.333 Pts Sta 55+27.374 Pts Sta 58+29.386

$\theta_s = 2'12''47.3''$ $\Delta = 26'51''19.4''$ (LT) $\theta_s = 2'12''47.3''$ $\theta_s = 1'28''31.5''$ $\Delta = 28'19''50.9''$ (LT) $\theta_s = 1'28''31.5''$

$L_s = 90.000$ $L = 546.053$ $L_s = 90.000$ $L_s = 60.000$ $L = 576.053$ $L_s = 60.000$

$LT = 60.005$ $T = 278.137$ $LT = 60.005$ $LT = 40.001$ $T = 294.942$ $LT = 40.001$

$ST = 30.004$ $R = 1,165.000$ $ST = 30.004$ $ST = 20.001$ $R = 1,165.000$ $ST = 20.001$

$S_e = 0.05$ $DS = 105 \text{ km/h}$

NOTE: GRADE ULTIMATE SECTION FROM -LREV- STA. 55+60' TO 56+80'

NOTE: GRADE ULTIMATE SECTION FROM -LREV- STA. 57+65' TO 58+60'

WILLIAM J. WELLS
CHARLES H. WEST
DB 438 PG 90
DB 320 PG 76
DB 559 PG 43

WILLIAM J. WELLS
CHARLES H. WEST
DB 438 PG 90
DB 320 PG 76
DB 559 PG 43

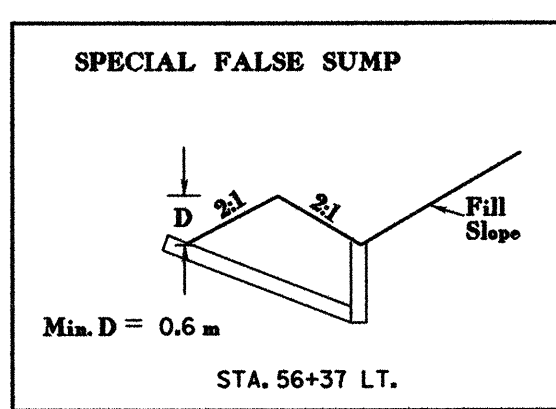
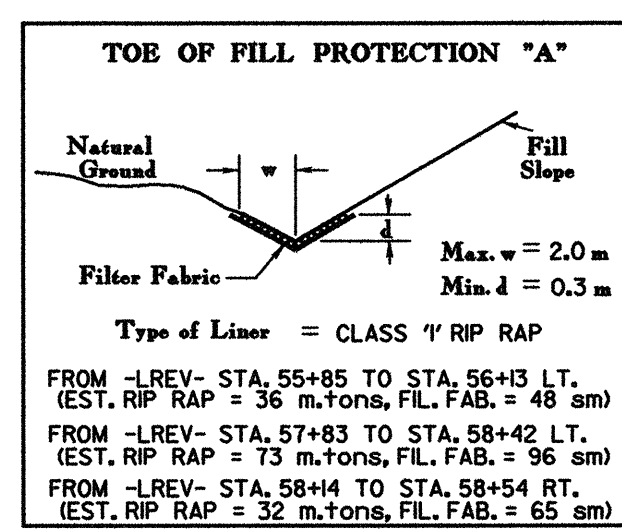
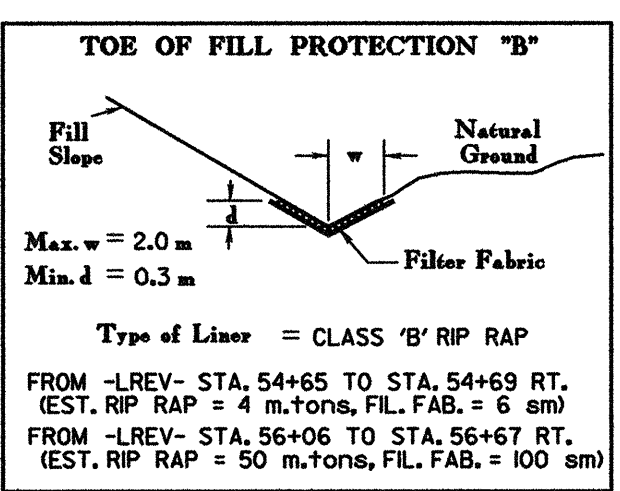
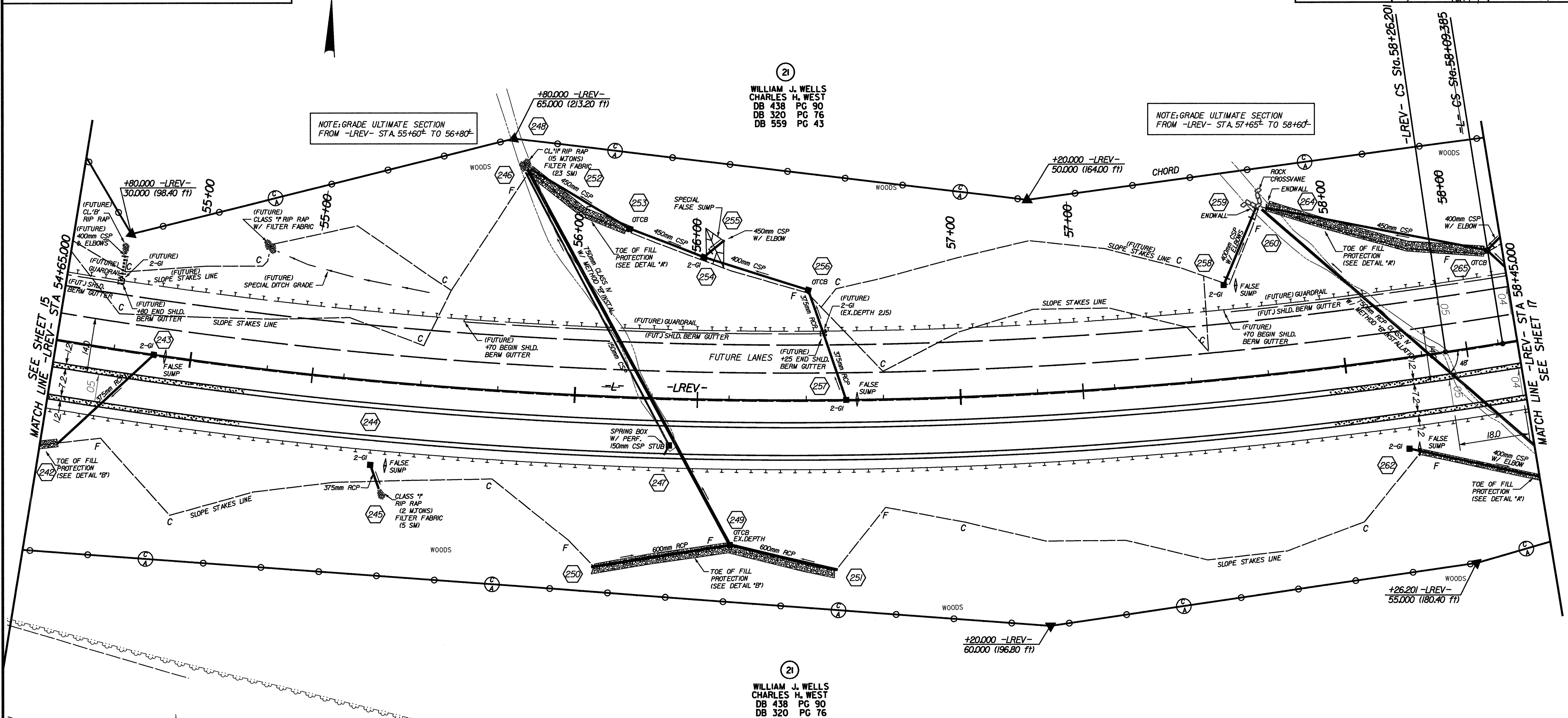

SEE SHEET 42 FOR -LREV- PROFILE
SEE PROFILES FOR DITCH GRADES