

NOTE: GRADE ULTIMATE SECTION FROM -LREV STA. 63+85± TO 65+35±

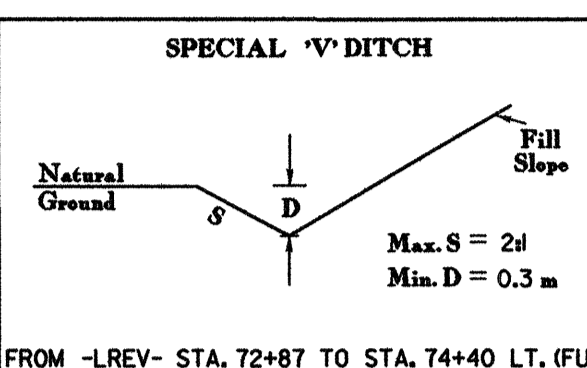
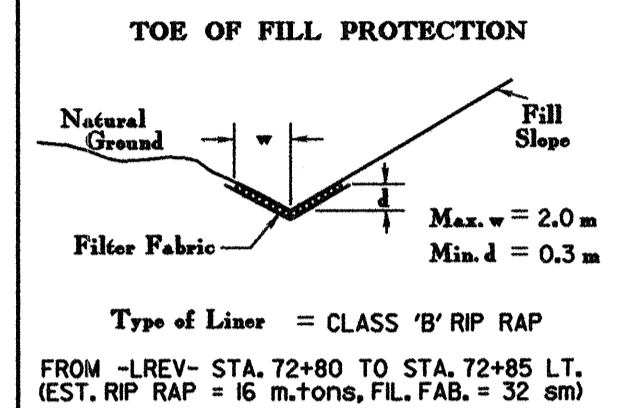

-Y5- PI Sta 13+61.403 Δ = 92° 51' 01.0" (RT) L = 48.616 T = 31.531 R = 30.000 Se = 0.04 Ro = 20.000 DS = 30 km/h	-Y5- PI Sta 12+62.149 Δ = 90° 00' 00.0" (LT) L = 47.124 T = 30.000 R = 30.000 Se = 0.04 Ro = AS SHOWN DS = 30 km/h
-Y5- PI Sta 11+75.025 Δ = 90° 00' 00.0" (LT) L = 47.124 T = 30.000 R = 30.000	-Y5- PI Sta 10+60.296 Δ = 84° 19' 32.0" (RT) L = 44.153 T = 27.167 R = 30.000
-LREV- PIs Sta 75+35.795 θs = 2° 12' 47.3" Ls = 90.000 LT = 60.005 ST = 30.004	-LREV- PI Sta 81+02.675 Δ = 49° 29' 05.4" (LT) L = 1,006.179 T = 536.885 R = 1,165.000 Se = 0.05 DS = 105 km/h
	-L- PIs Sta 86+01.973 θs = 2° 12' 47.3" Ls = 90.000 LT = 60.005 ST = 30.004

SEE SHEET 20
MATCH LINE -LREV- STA 72+70.000

MATCH LINE -LREV- STA 75+70.000
SEE SHEET 22

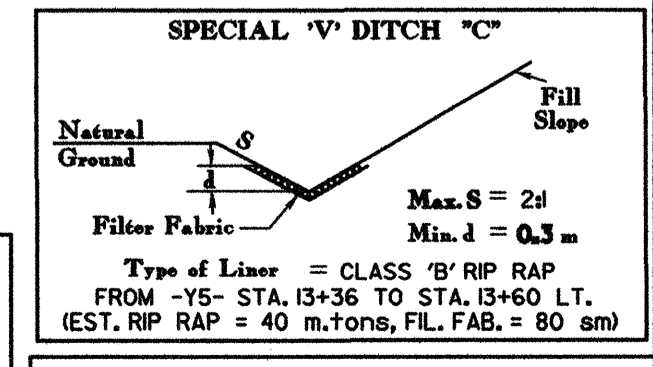
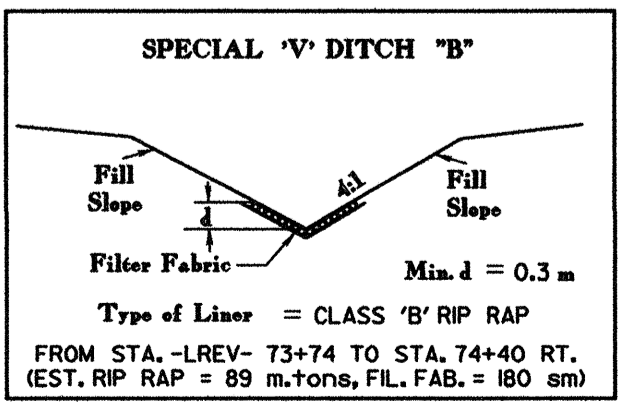
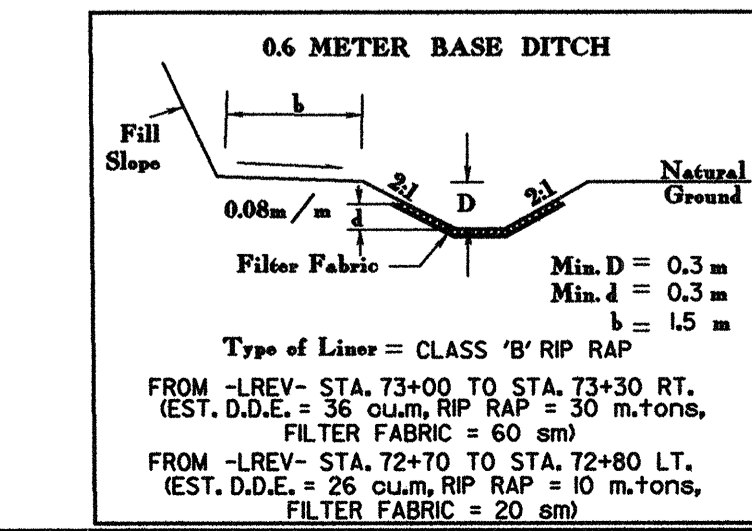
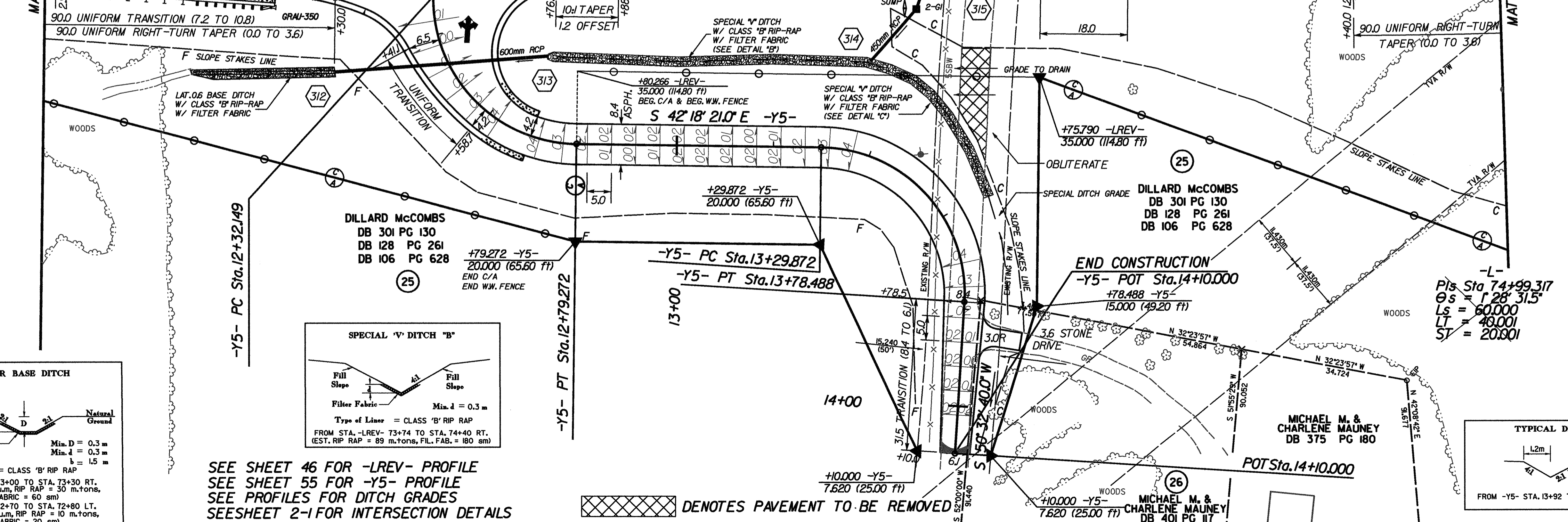

SEE SHEET 46 FOR -LREV- PROFILE
SEE SHEET 55 FOR -Y5- PROFILE
SEE PROFILES FOR DITCH GRADES
SEE SHEET 2-1 FOR INTERSECTION DETAILS

XXXXXX DENOTES PAVEMENT TO BE REMOVED

LOCHNER
H. W. LOCHNER, INC.
2840 PLAZA PLACE, SUITE 202
RALEIGH, NC 27612