

METRIC

5 0 10

CONST. REV.

R/W REV.

PROJECT REFERENCE NO. R-977A	SHEET NO. 26
HIGHWAY DESIGN ENGINEER	HYDRAULICS ENGINEER

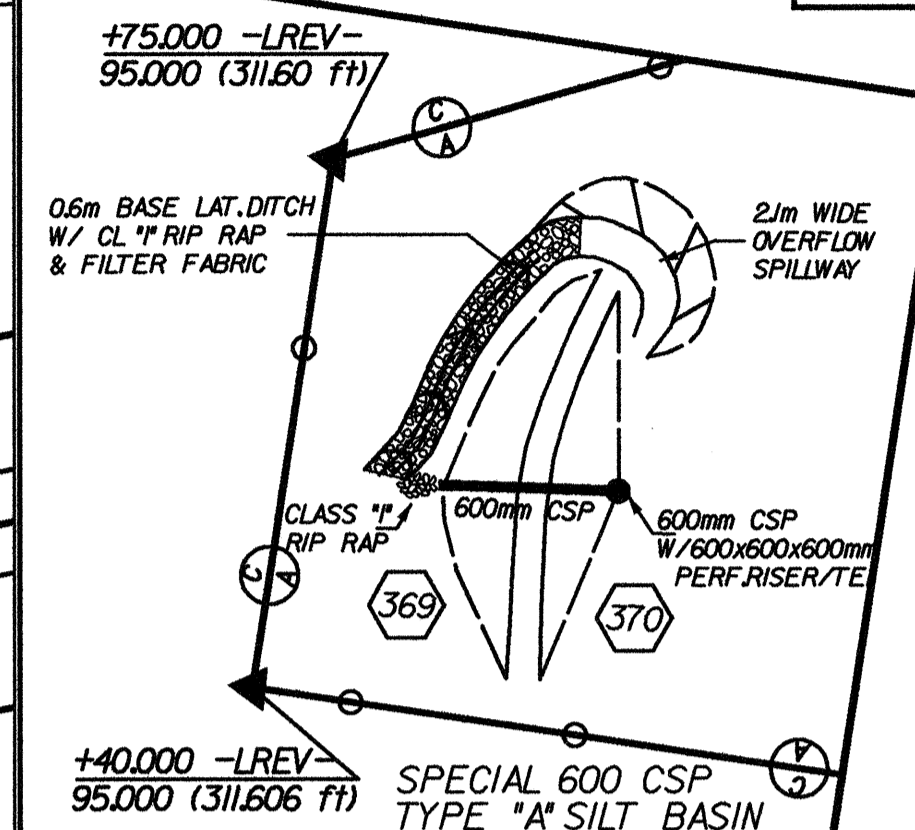
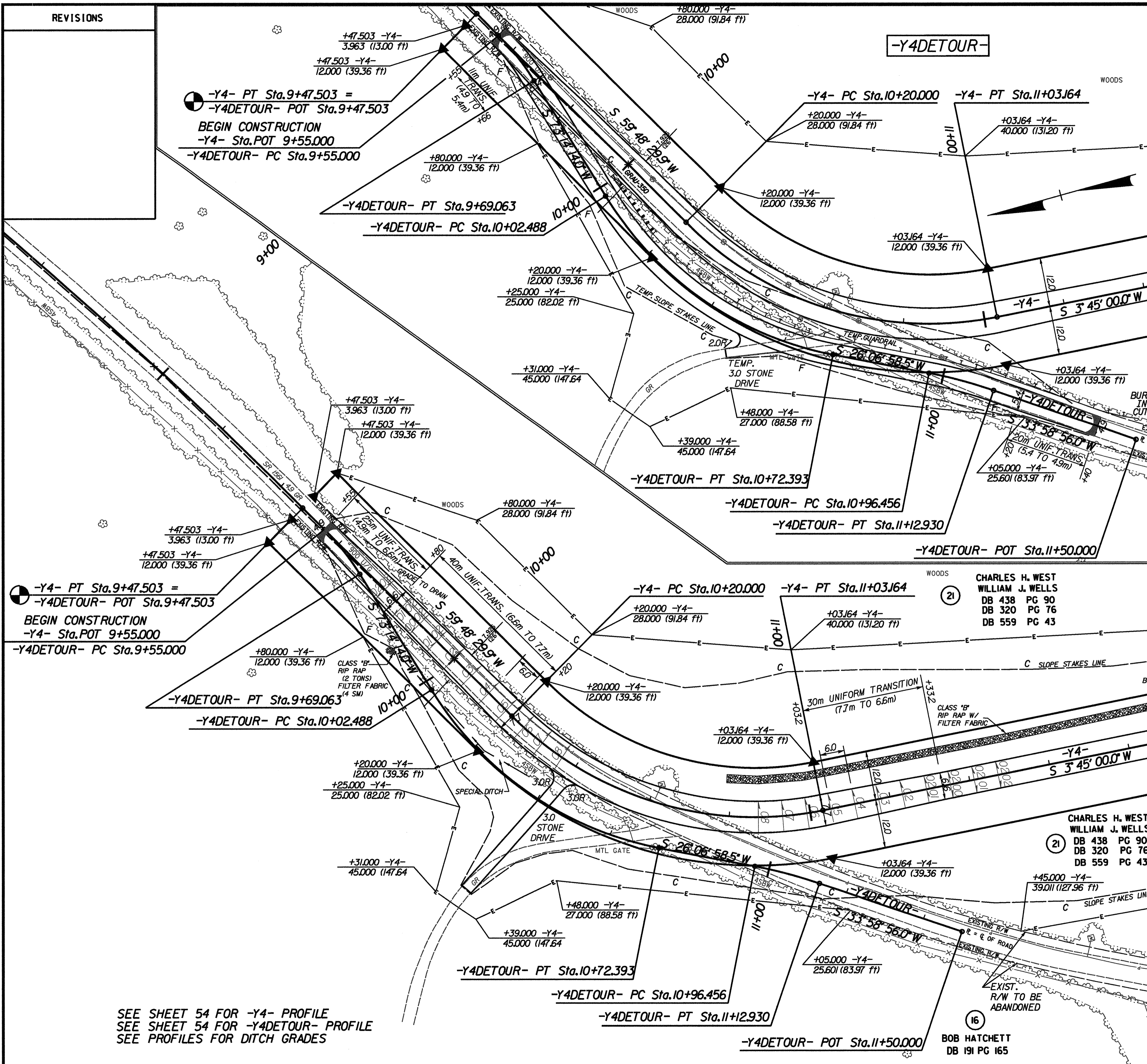

MATCH LINE -LREV- STA 50+85.000
SEE SHEET 15

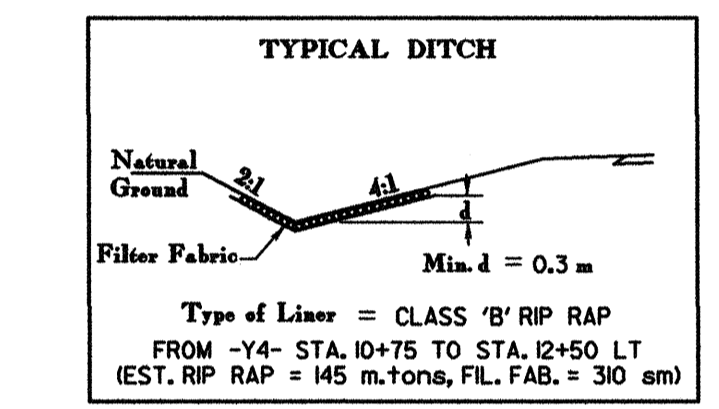

CHARLES H. WEST
WILLIAM J. WELLS
DB 438 PG 90
DB 320 PG 76
DB 559 PG 43

CHARLES H. WEST
WILLIAM J. WELLS
DB 438 PG 90
DB 320 PG 76
DB 559 PG 43

BOB HATCHETT
DB 191 PG 165

-Y4-
PI Sta 8+87.154
 $\Delta = 5' 32'' 12.0'' (RT)$
L = 120.791
T = 60.443
R = 1250.000
Se = EXIST.

-Y4-
PI Sta 10+65.251
 $\Delta = 56' 03'' 30.0'' (LT)$
L = 83.164
T = 45.251
R = 85.000
Se = 0.08
Ro = 48.000
DS = 50 km/h

-Y4DETOUR-
PI Sta 9+62.064
 $\Delta = 13' 25'' 44.1'' (RT)$
L = 14.063
T = 7.064
R = 60.000
Se = NC
DS = 40 km/h

-Y4DETOUR-
PI Sta 10+39.553
 $\Delta = 47' 07'' 15.5'' (LT)$
L = 69.905
T = 37.066
R = 85.000
Se = NC
DS = 40 km/h

-Y4DETOUR-
PI Sta 11+04.706
 $\Delta = 7' 51'' 57.5'' (RT)$
L = 16.474
T = 8.250
R = 120.000
Se = NC
DS = 40 km/h

SEE SHEET 54 FOR -Y4- PROFILE
SEE SHEET 54 FOR -Y4DETOUR- PROFILE
SEE PROFILES FOR DITCH GRADES

LOCHNER
H. W. LOCHNER, INC.
2840 PLAZA PLACE, SUITE 202
RALEIGH, NC 27612