

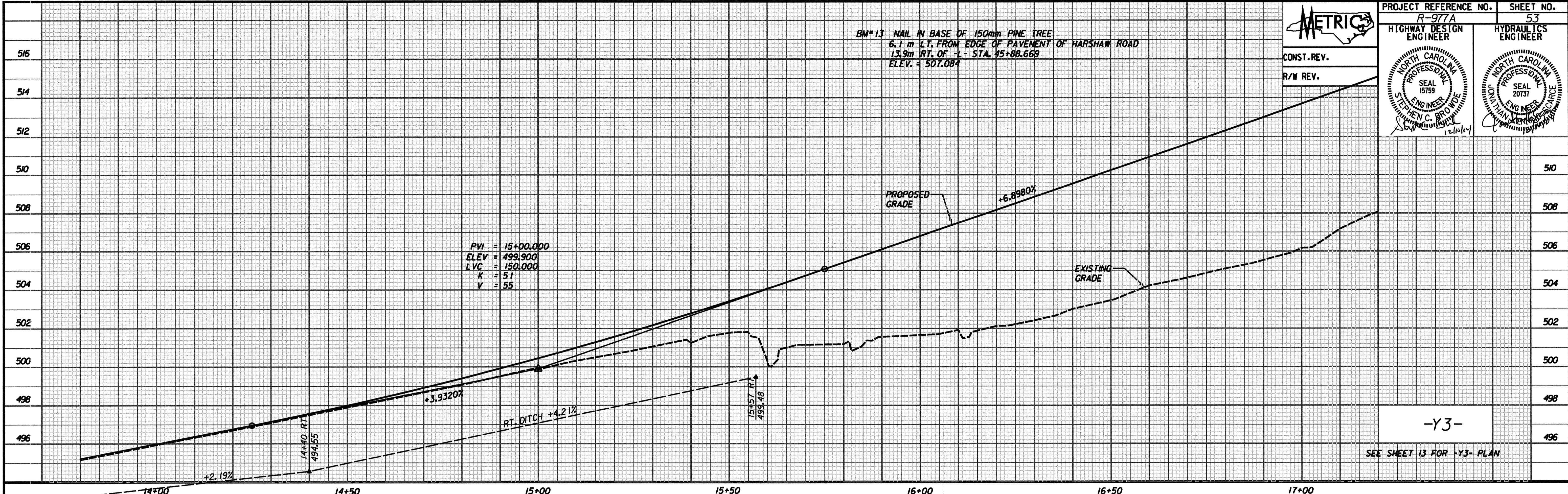

PROJECT REFERENCE NO. R-977A	SHEET NO. 53
HIGHWAY DESIGN ENGINEER	HYDRAULICS ENGINEER

BM# 13 NAIL IN BASE OF 150mm PINE TREE
6.1 m LT. FROM EDGE OF PAVEMENT OF HARSHAW ROAD
13.9m RT. OF -L- STA. 15+88.669
ELEV. = 507.084

CONST. REV.
R/W REV.



-Y3-

SEE SHEET 13 FOR -Y3- PLAN

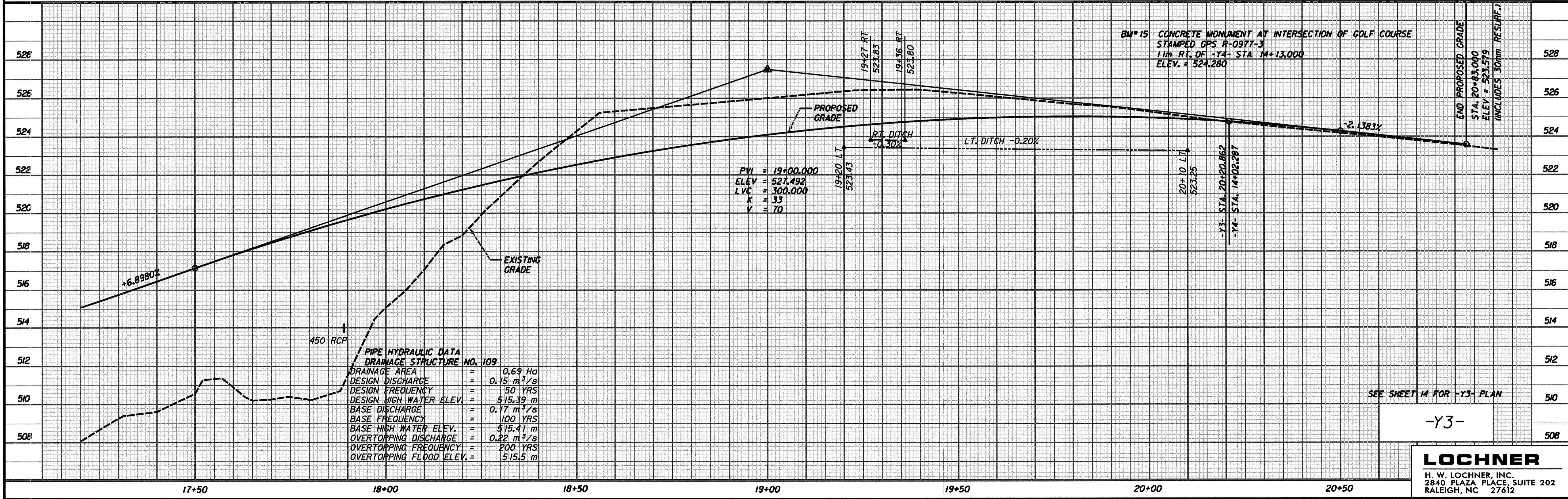

BM# 15 CONCRETE MONUMENT AT INTERSECTION OF GOLF COURSE
STAMPED GPS R-0977-3
1.1m RT. OF -Y4- STA 14+13.000
ELEV. = 524.280

450 RCP

PIPE HYDRAULIC DATA
DRAINAGE STRUCTURE NO. 109

DRAINAGE AREA	=	0.69 Ha
DESIGN DISCHARGE	=	0.15 m ³ /s
DESIGN FREQUENCY	=	50 YRS
DESIGN HIGH WATER ELEV.	=	515.39 m
BASE DISCHARGE	=	0.17 m ³ /s
BASE FREQUENCY	=	100 YRS
BASE HIGH WATER ELEV.	=	515.41 m
OVERTOPPING DISCHARGE	=	0.22 m ³ /s
OVERTOPPING FREQUENCY	=	200 YRS
OVERTOPPING FLOOD ELEV.	=	515.5 m

-Y3-

SEE SHEET 14 FOR -Y3- PLAN

LOCHNER
H. W. LOCHNER, INC.
2840 PLAZA PLACE, SUITE 202
RALEIGH, NC 27612

...:\p09\09077_B01_PROF1.dgn 12/19/2004 5:42:05 AM