

REVISIONS

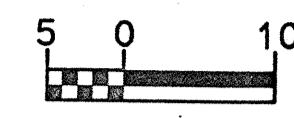

| | | | |
|-------------------------|--------|---------------------|----|
| PROJECT REFERENCE NO. | R-977A | SHEET NO. | 10 |
| HIGHWAY DESIGN ENGINEER | | HYDRAULICS ENGINEER | |
| CONST. REV. | | R/W REV. | |



-L- WOODS
 PIs Sta 28+75.548
 Os = 1° 57' 51.9"
 Ls = 60.000
 LT = 40.002
 ST = 20.002

-L- WOODS
 PI Sta 31+16.010
 Δ = 34° 21' 11.1" (LT)
 L = 524.628
 T = 270.465
 R = 875.000

-L- WOODS
 PIs Sta 33+90.174
 Os = 1° 57' 51.9"
 Ls = 60.000
 LT = 40.002
 ST = 20.002

-LREV-
 PIs Sta 28+62.544
 Os = 2° 56' 47.9"
 Ls = 90.000
 LT = 60.008
 ST = 30.008

-LREV-
 PI Sta 31+46.653
 Δ = 32° 23' 19.1" (LT)
 L = 494.627
 T = 254.117
 R = 875.000
 SE = 0.06
 DS = 105 km/h

-LREV-
 PIs Sta 34+17.171
 Os = 2° 56' 47.9"
 Ls = 90.000
 LT = 60.008
 ST = 30.008

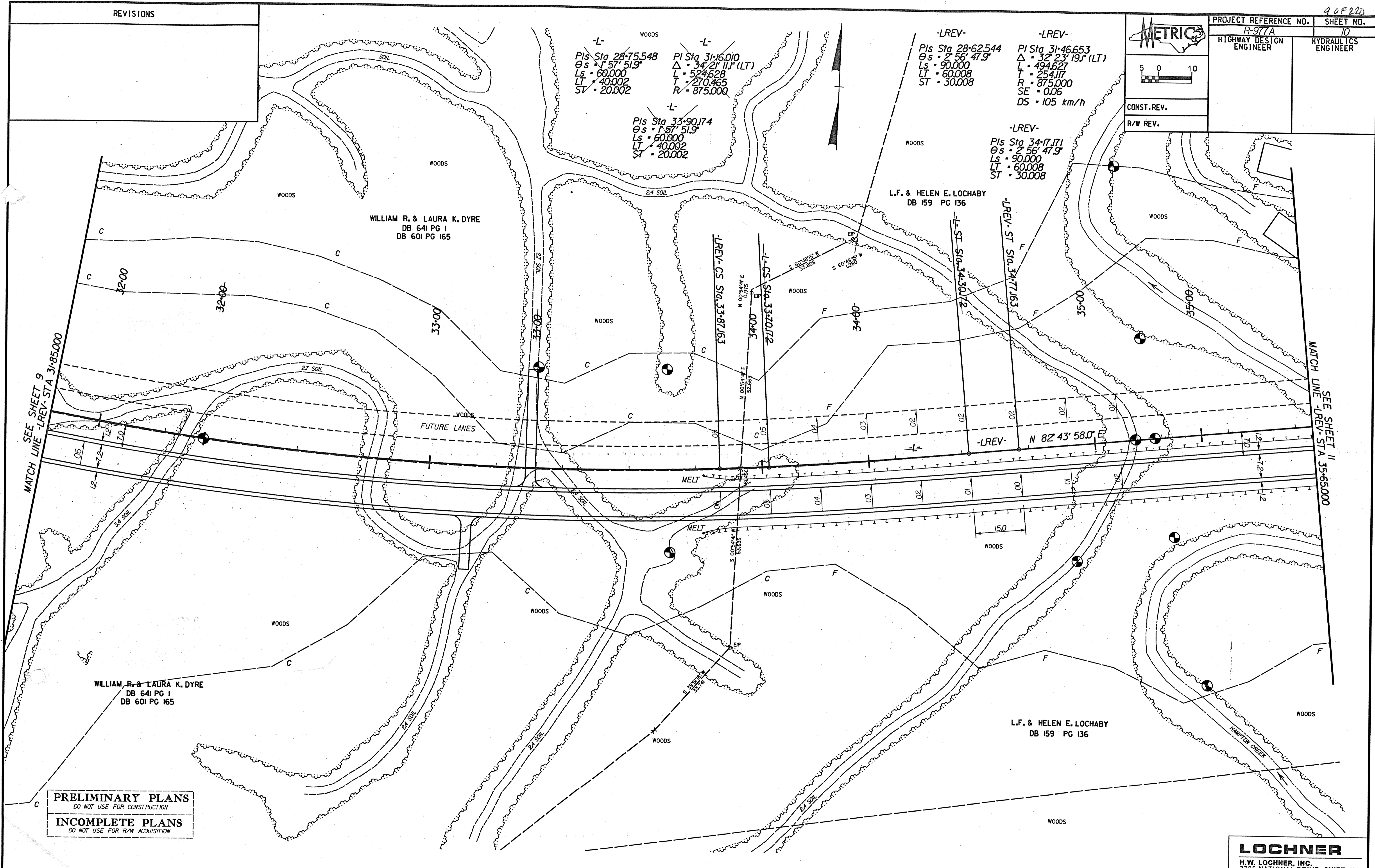

SEE SHEET 9
MATCH LINE -LREV- STA 31+85.000

SEE SHEET 11
MATCH LINE -LREV- STA 35+65.000

PRELIMINARY PLANS
 DO NOT USE FOR CONSTRUCTION

INCOMPLETE PLANS
 DO NOT USE FOR R/W ACQUISITION

SEE SHEET 36 FOR -LREV- PROFILES

LOCHNER
 H.W. LOCHNER, INC.
 3725 NATIONAL DRIVE, SUITE 123
 RALEIGH, NC 27612

c:\haha\p\977a\plan10.dgn Aug. 26, 1996 08:16:12