

REVISIONS

-LREV-
 PIs Sta 52+50.153
 $\theta_s = 2^\circ 12' 47.3"$
 $L_s = 90.000$
 $LT = 60.005$
 $ST = 30.004$

-LREV-
 PI Sta 55+58.285
 $\Delta = 26^\circ 51' 19.4" (LT)$
 $L = 546.053$
 $T = 278.137$
 $R = 1,165.000$
 $SE = 0.05$
 $DS = 105 \text{ km/h}$

-LREV-
 PIs Sta 58+56.205
 $\theta_s = 2^\circ 12' 47.3"$
 $L_s = 90.000$
 $LT = 60.005$
 $ST = 30.004$

-L-
 PIs Sta 52+13.333
 $\theta_s = 1^\circ 28' 31.5"$
 $L_s = 60.000$
 $LT = 40.001$
 $ST = 20.001$

-L-
 PI Sta 55+21.374
 $\Delta = 28^\circ 19' 50.9" (LT)$
 $L = 576.053$
 $T = 294.042$
 $R = 1,165.000$

-L-
 PIs Sta 58+29.386
 $\theta_s = 1^\circ 28' 31.5"$
 $L_s = 60.000$
 $LT = 40.001$
 $ST = 20.001$



PROJECT REFERENCE NO. R-977A	SHEET NO. 15
HIGHWAY DESIGN ENGINEER	HYDRAULICS ENGINEER

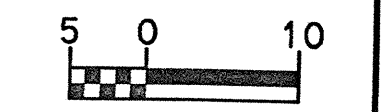

CONST. REV.
 R/W REV.

WILLIAM J. WELLS
 DB 438 PG 90
 DB 320 PG 76
 DB 559 PG 43

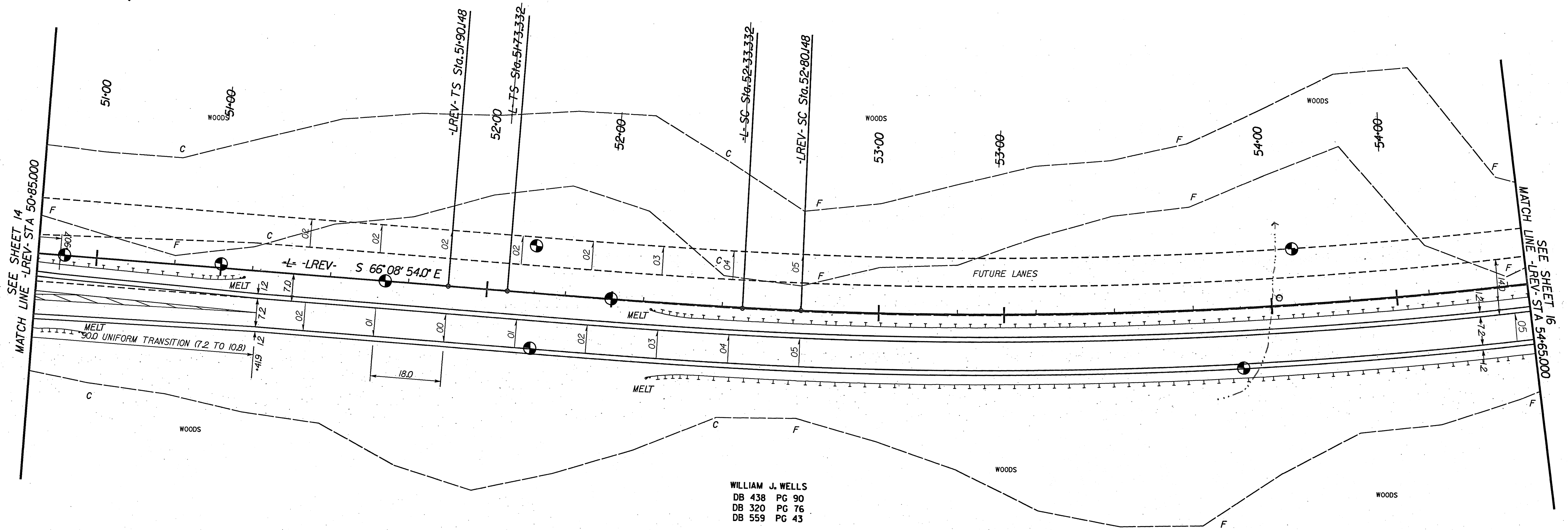

WILLIAM J. WELLS
 DB 438 PG 90
 DB 320 PG 76
 DB 559 PG 43

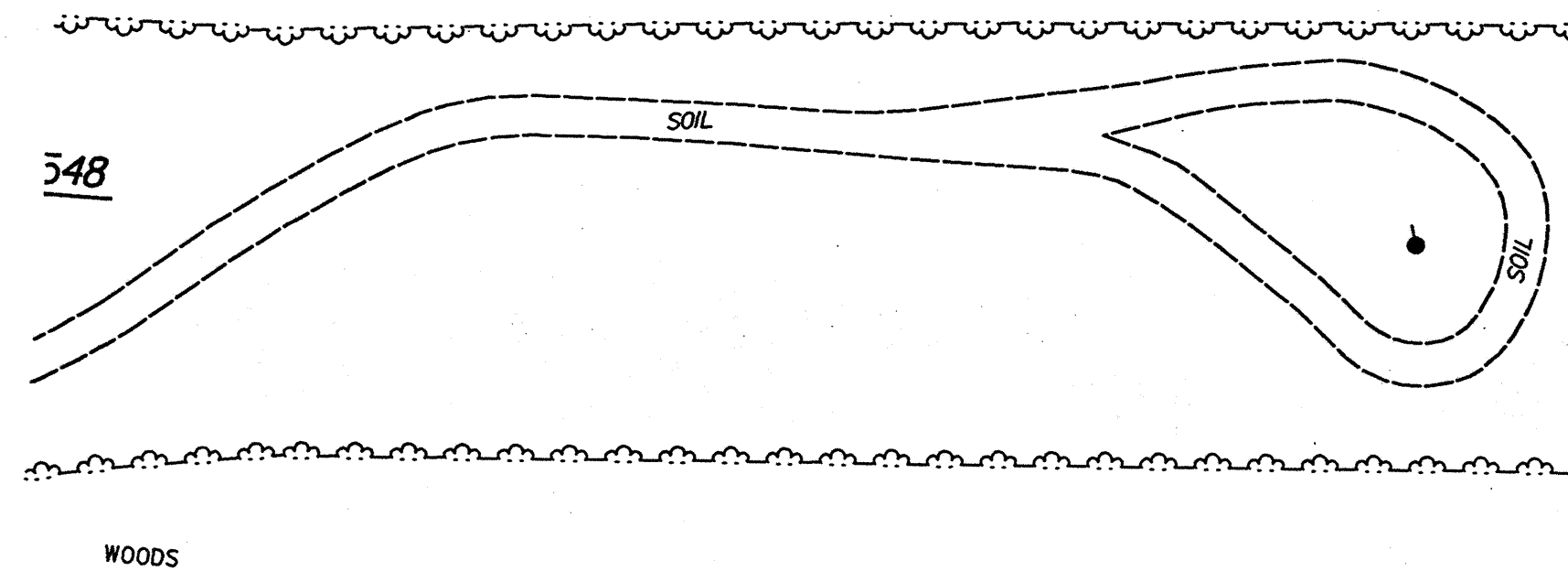

PRELIMINARY PLANS
 DO NOT USE FOR CONSTRUCTION
 INCOMPLETE PLANS
 DO NOT USE FOR R/W ACQUISITION

SEE SHEET 40 FOR -LREV- PROFILE

LOCHNER
 H.W. LOCHNER, INC.
 3725 NATIONAL DRIVE, SUITE 123
 RALEIGH, NC 27612