

47 08220

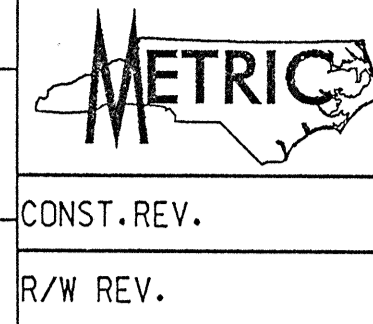

PROJECT REFERENCE NO. R-977A	SHEET NO. 48
HIGHWAY DESIGN ENGINEER	HYDRAULICS ENGINEER

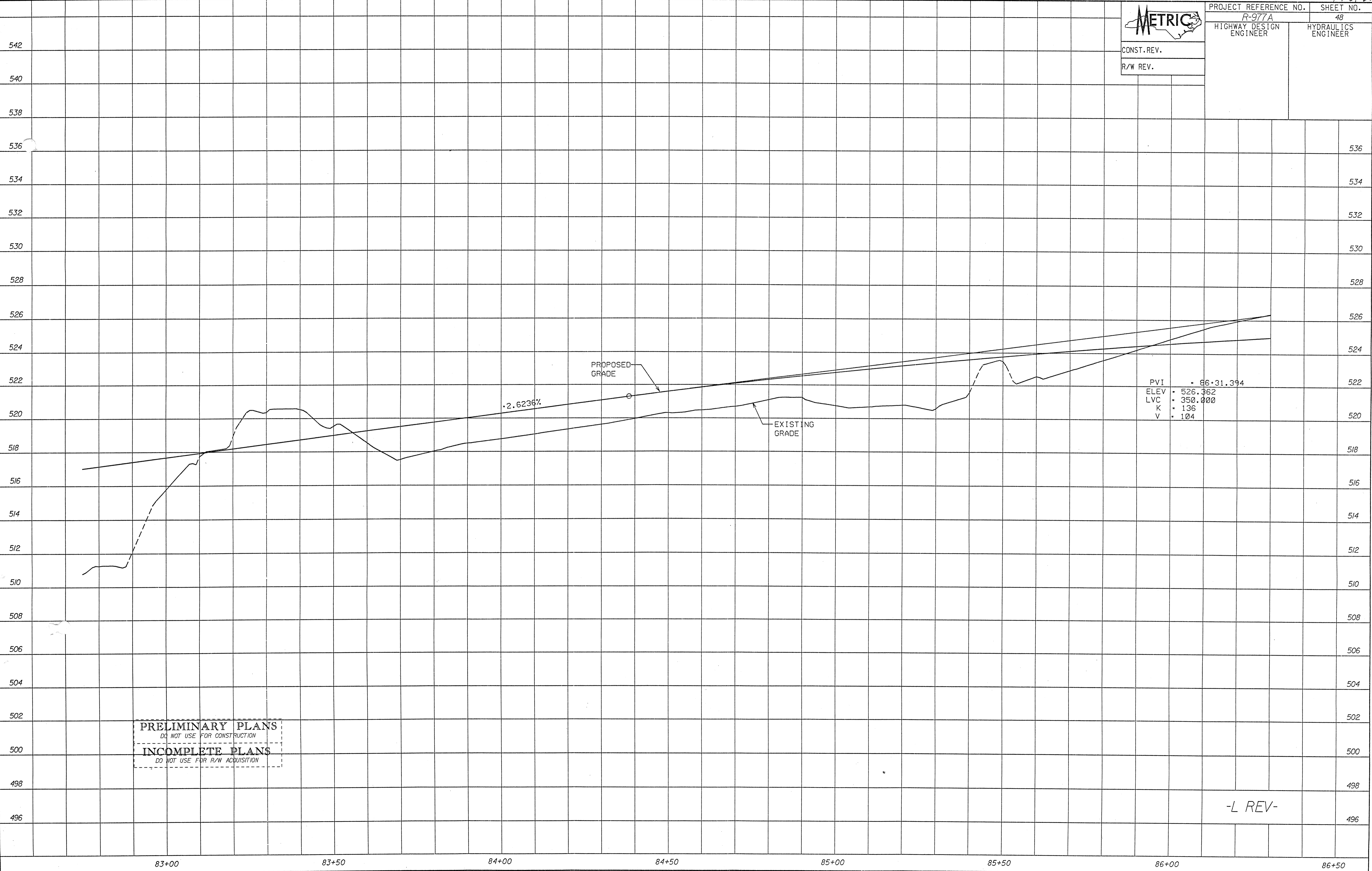

PROPOSED GRADE

+2.6236%

EXISTING GRADE

PVI • 86+31.394  
 ELEV • 526.362  
 LVC • 350.000  
 K • 136  
 V • 104

**PRELIMINARY PLANS**  
 DO NOT USE FOR CONSTRUCTION  
**INCOMPLETE PLANS**  
 DO NOT USE FOR R/W ACQUISITION

-L REV-

83+00                      83+50                      84+00                      84+50                      85+00                      85+50                      86+00                      86+50