



PROJ. REFERENCE NO.	SHEET NO.
B-3376	TCP-4

PHASE II

WORK IN A CONTINUOUS MANNER TO COMPLETE STEPS 1 THRU 3

NOTE: FINISH WITH TRAFFIC ON -DETOUR- IN A TWO-LANE, TWO-WAY TRAFFIC PATTERN AFTER THE COMPLETION OF STEP 3, BY THE END OF THE WORKDAY.

- STEP 1: COMPLETE CONSTRUCTION OF ROADWAY AT -DETOUR- STA. 11+87 +/- AND INSTALL TEMPORARY GUARDRAIL ALONG -DETOUR- AS SEEN ON TCP-3.
- STEP 2: USING ROADWAY STANDARD DRAWING 1101.02, SHEET 1 OF 7, PLACE TRAFFIC INTO THE EXISTING NORTHBOUND LANE OF SR 2564 IN A TEMPORARY ONE-LANE, TWO-WAY TRAFFIC PATTERN. COMPLETE THE TIE-INS FOR THE SOUTHBOUND LANE OF -DETOUR- FROM -DETOUR- STA. 9+98 +/- TO -DETOUR- STA. 10+27 +/- AND FROM -DETOUR- STA. 13+94 +/- TO -DETOUR- STA. 14+23 +/- . INSTALL EDGELINE AND CENTERLINE PAVEMENT MARKINGS AND MARKERS FROM -DETOUR- STA. 9+98 +/- TO -DETOUR- STA. 14+23 +/- (SEE TCP-4).

SWITCH TRAFFIC INTO THE SOUTHBOUND LANE OF -DETOUR- IN A TEMPORARY ONE-LANE, TWO-WAY TRAFFIC PATTERN. COMPLETE THE TIE-INS FOR THE NORTHBOUND LANE OF -DETOUR- FROM -DETOUR- STA. 9+98 +/- TO -DETOUR- STA. 10+42 +/- AND FROM -DETOUR- STA. 13+83 +/- TO -DETOUR- STA. 14+23 +/- . INSTALL REMAINING PAVEMENT MARKINGS FROM -DETOUR- STA. 9+98 +/- TO -DETOUR- STA. 14+23 +/- (SEE TCP-4).
- STEP 3: SWITCH SOUTHBOUND TRAFFIC ONTO -DETOUR- IN A TEMPORARY TWO-LANE, TWO-WAY TRAFFIC PATTERN AND PLACE TYPE III BARRICADES AND DRUMS AS SEEN ON TCP-4.
- STEP 4: REMOVE EXISTING STRUCTURE. CONSTRUCT PROPOSED BRIDGE AND ROADWAY APPROACHES UP TO BUT NOT INCLUDING THE FINAL LAYER OF SURFACE COURSE FROM -L- STA. 10+62 +/- TO -L- STA. 14+74 +/- (SEE TCP-4). CONSTRUCT -DR1- FROM -DR1- STA. 10+45 +/- TO -DR1- STA. 10+60 +/- AND -DR2- FROM -DR2- STA. 10+00 +/- TO -DR2- STA. 10+17 +/- . INSTALL GUARDRAIL ALONG PROPOSED -L- (SEE TCP-4).

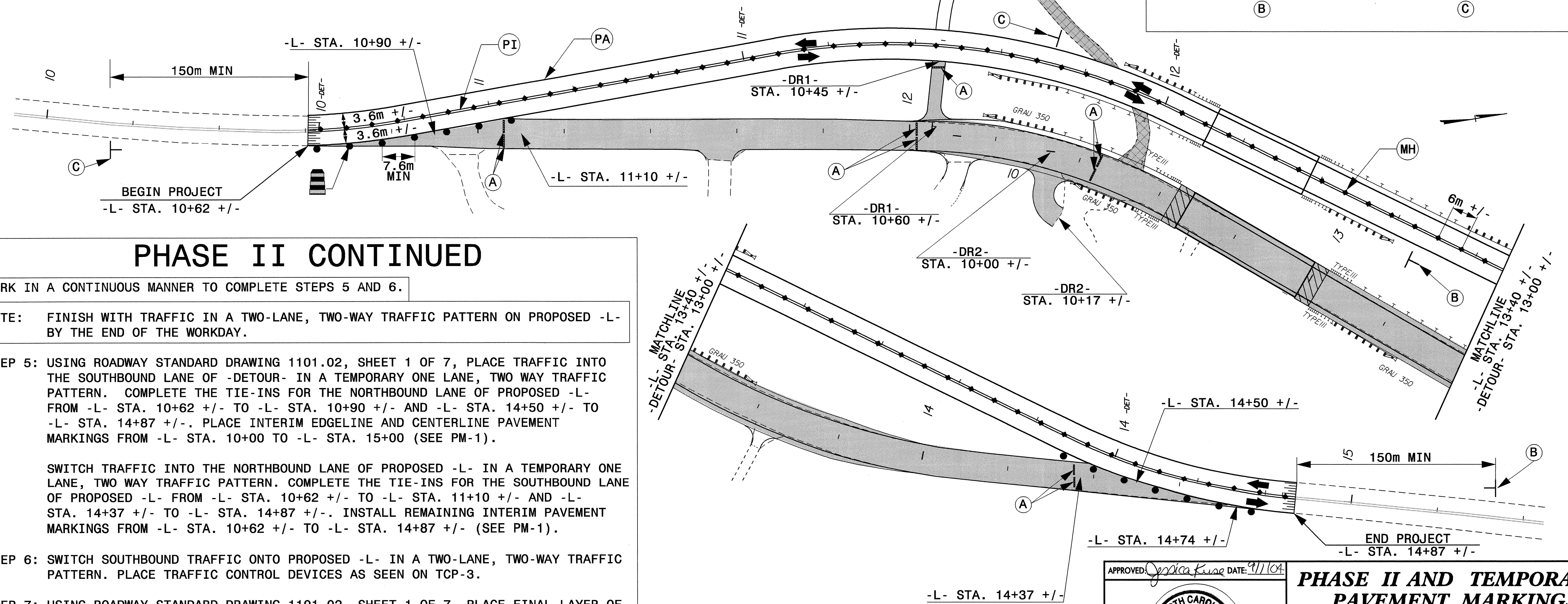
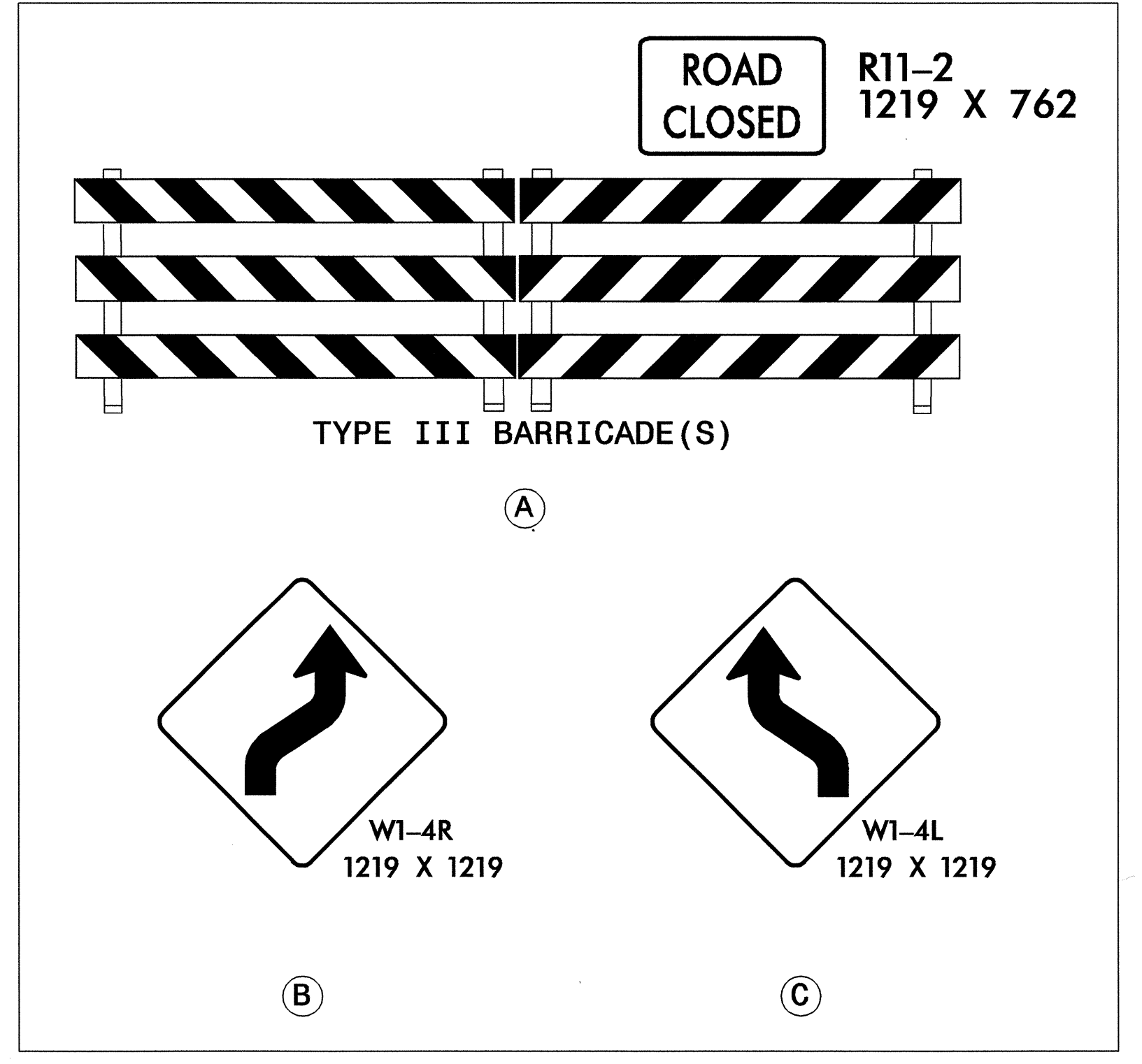

PHASE II CONTINUED

WORK IN A CONTINUOUS MANNER TO COMPLETE STEPS 5 AND 6.

NOTE: FINISH WITH TRAFFIC IN A TWO-LANE, TWO-WAY TRAFFIC PATTERN ON PROPOSED -L- BY THE END OF THE WORKDAY.

- STEP 5: USING ROADWAY STANDARD DRAWING 1101.02, SHEET 1 OF 7, PLACE TRAFFIC INTO THE SOUTHBOUND LANE OF -DETOUR- IN A TEMPORARY ONE LANE, TWO WAY TRAFFIC PATTERN. COMPLETE THE TIE-INS FOR THE NORTHBOUND LANE OF PROPOSED -L- FROM -L- STA. 10+62 +/- TO -L- STA. 10+90 +/- AND -L- STA. 14+50 +/- TO -L- STA. 14+87 +/- . PLACE INTERIM EDGELINE AND CENTERLINE PAVEMENT MARKINGS FROM -L- STA. 10+00 TO -L- STA. 15+00 (SEE PM-1).

SWITCH TRAFFIC INTO THE NORTHBOUND LANE OF PROPOSED -L- IN A TEMPORARY ONE LANE, TWO WAY TRAFFIC PATTERN. COMPLETE THE TIE-INS FOR THE SOUTHBOUND LANE OF PROPOSED -L- FROM -L- STA. 10+62 +/- TO -L- STA. 11+10 +/- AND -L- STA. 14+37 +/- TO -L- STA. 14+87 +/- . INSTALL REMAINING INTERIM PAVEMENT MARKINGS FROM -L- STA. 10+62 +/- TO -L- STA. 14+87 +/- (SEE PM-1).
- STEP 6: SWITCH SOUTHBOUND TRAFFIC ONTO PROPOSED -L- IN A TWO-LANE, TWO-WAY TRAFFIC PATTERN. PLACE TRAFFIC CONTROL DEVICES AS SEEN ON TCP-3.
- STEP 7: USING ROADWAY STANDARD DRAWING 1101.02, SHEET 1 OF 7, PLACE FINAL LAYER OF SURFACE COURSE AND FINAL PAVEMENT MARKINGS AND MARKERS ON PROPOSED -L- FROM -L- STA. 10+62 +/- TO -L- STA. 14+87 +/- (SEE PM-1).
- STEP 8: REMOVE DETOUR STRUCTURE AND ROADWAY APPROACHES.

APPROVED: *Jessica D. Tuse* DATE: 9/1/04

SEAL

NORTH CAROLINA PROFESSIONAL ENGINEER SEAL 027811 JESSICA D. TUSE

PHASE II AND TEMPORARY PAVEMENT MARKINGS	
SCALE: NONE	REVISIONS
DATE: 7/2004	
DWG. BY: MLM	
DESIGN BY: MLM	
REVIEWED BY: JDK	

01-SEP-2004 10:46 h:\TCP\B3376-TCP-04.dgn mmarley AT TETC88647