

TIP: R-2539C

See Sheet 1-A For Index of Sheets
See Sheet 1-B For Conventional Symbols

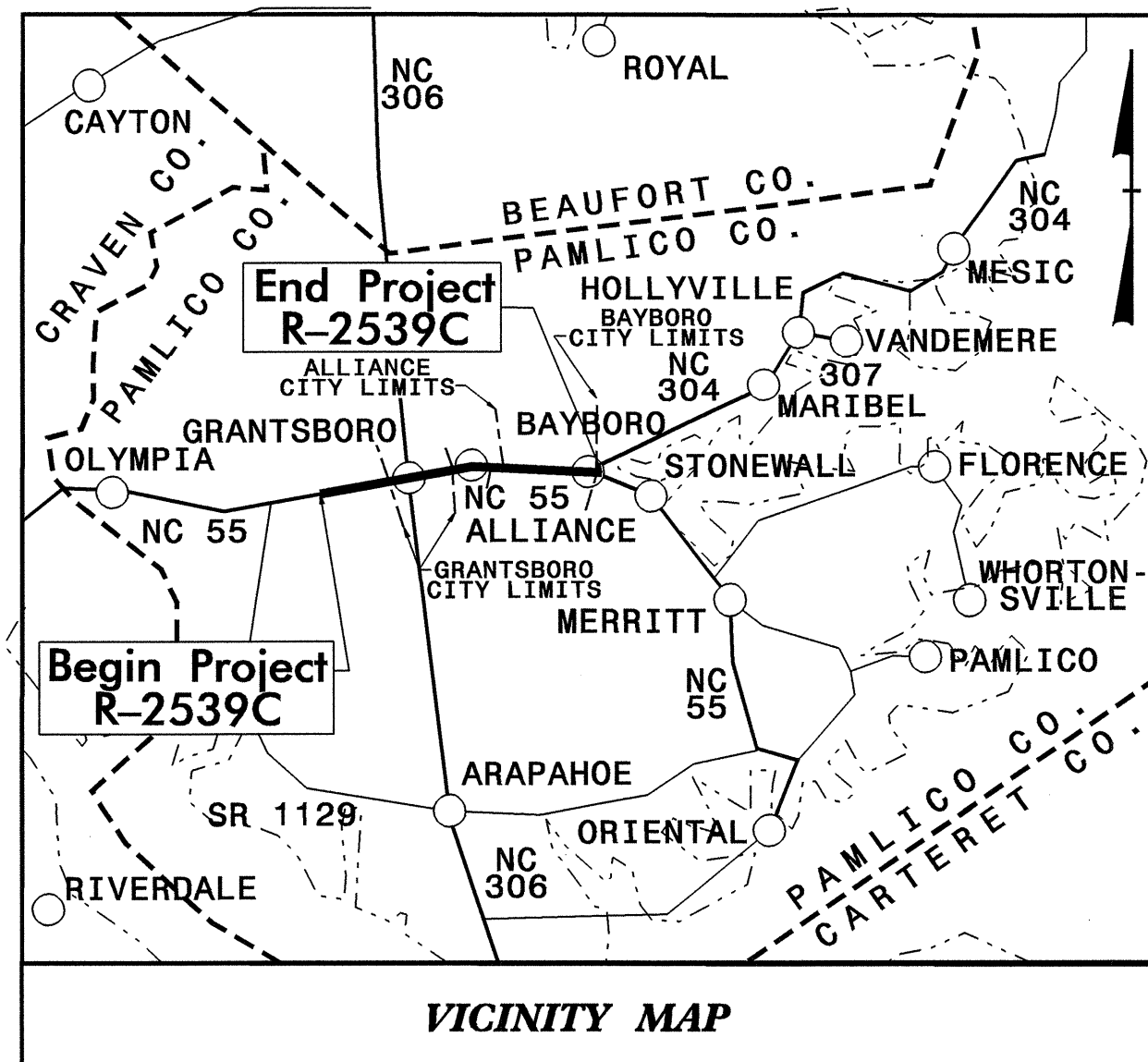

STATE OF NORTH CAROLINA
DIVISION OF HIGHWAYS

UTILITIES BY OTHERS PLANS
PAMLICO COUNTY

LOCATION: NC 55 FROM EAST OF SR 1129 (BENNETT-TINGLE ROAD) TO NC 304 IN BAYBORO

TYPE OF WORK: UTILITIES BY OTHERS (POWER, GAS, TELEPHONE, CATV)

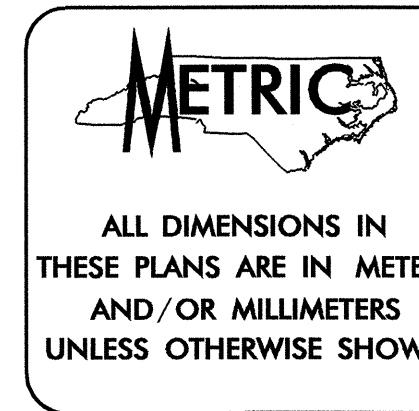

T.I.P. NO. R-2539C	SHEET NO. UO-1
------------------------------	--------------------------

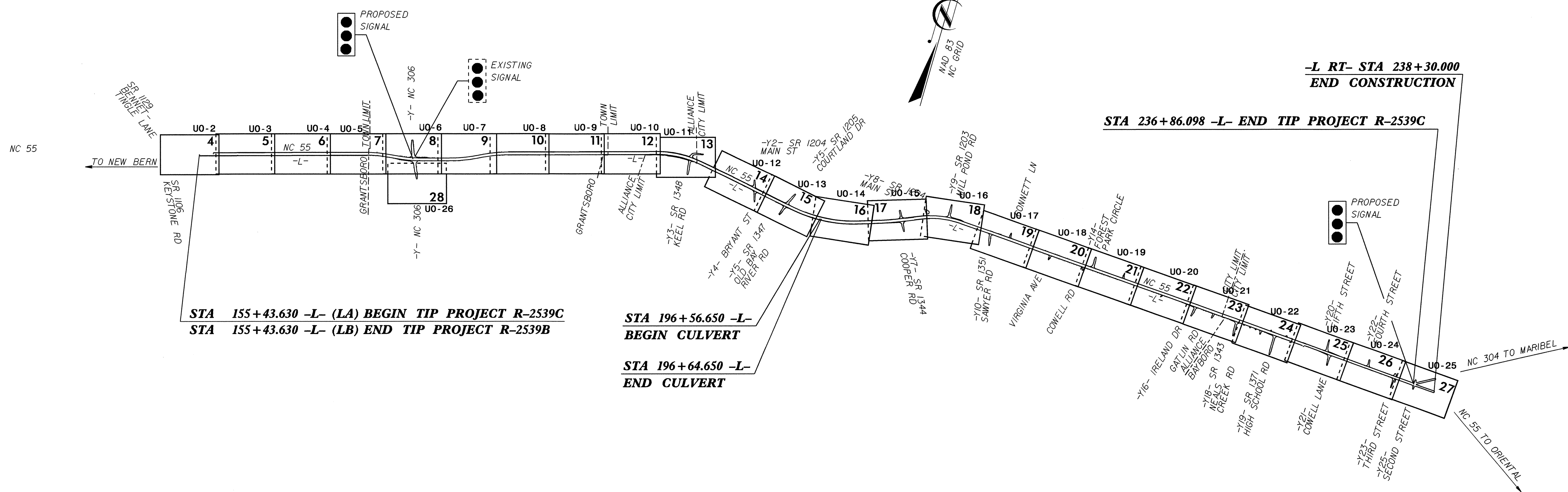

STA 155+43.630 -L- (LA) BEGIN TIP PROJECT R-2539C
STA 155+43.630 -L- (LB) END TIP PROJECT R-2539B

STA 196+56.650 -L- BEGIN CULVERT

STA 196+64.650 -L- END CULVERT

-L RT- STA 238+30.000
END CONSTRUCTION

STA 236+86.098 -L- END TIP PROJECT R-2539C

INDEX OF SHEETS

SHEET NO.	DESCRIPTION
UO-1	TITLE SHEET
UO-2 THRU UO-26	UTILITIES BY OTHERS PLAN SHEETS

- UTILITIES BY OTHERS OWNERS ON PROJECT**
- (1) PROGRESS ENERGY - POWER
 - (2) TIDELAND EMC - POWER
 - (3) EASTERN NORTH CAROLINA NATURAL GAS - GAS
 - (4) SPRINT - TELEPHONE
 - (5) TIME WARNER - CATV

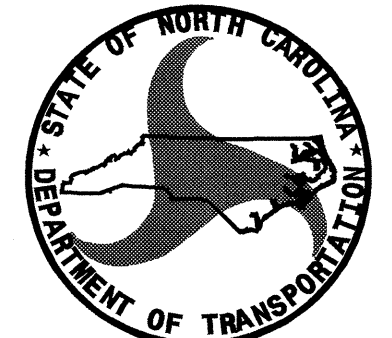

PREPARED IN THE OFFICE OF:
**DIVISION OF HIGHWAYS
DESIGN SERVICES
UTILITY SECTION**

1591 MAIL SERVICES CENTER
RALEIGH NC 27699-1591
PHONE (919) 250-4128
FAX (919) 250-4119

Roger Worthington, P.E. UTILITIES SECTION ENGINEER
Greg Stevens, P.E. UTILITIES SQUAD LEADER PROJECT ENGINEER
Ali Kouchehi UTILITIES PROJECT DESIGNER