

04/25/04

GREENHORNE & O'MARA, INC.
5565 CENTERVIEW DRIVE, SUITE 107
RALEIGH, NORTH CAROLINA 27606
(919) 851-1919

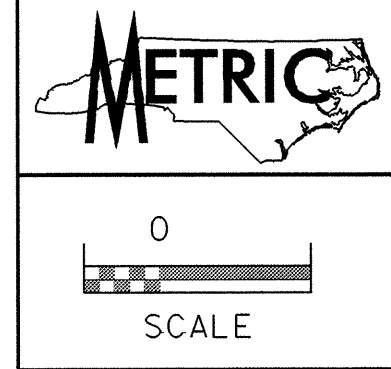

NOTE:
ALL PROPOSED UTILITY WORK
SHOWN ON THIS SHEET WILL
BE DONE BY OTHERS

MATCHLINE -L- STA. 160 + 20.000 SEE SHEET UO-3

MATCHLINE -L- STA. 163 + 80.000 SEE SHEET UO-5

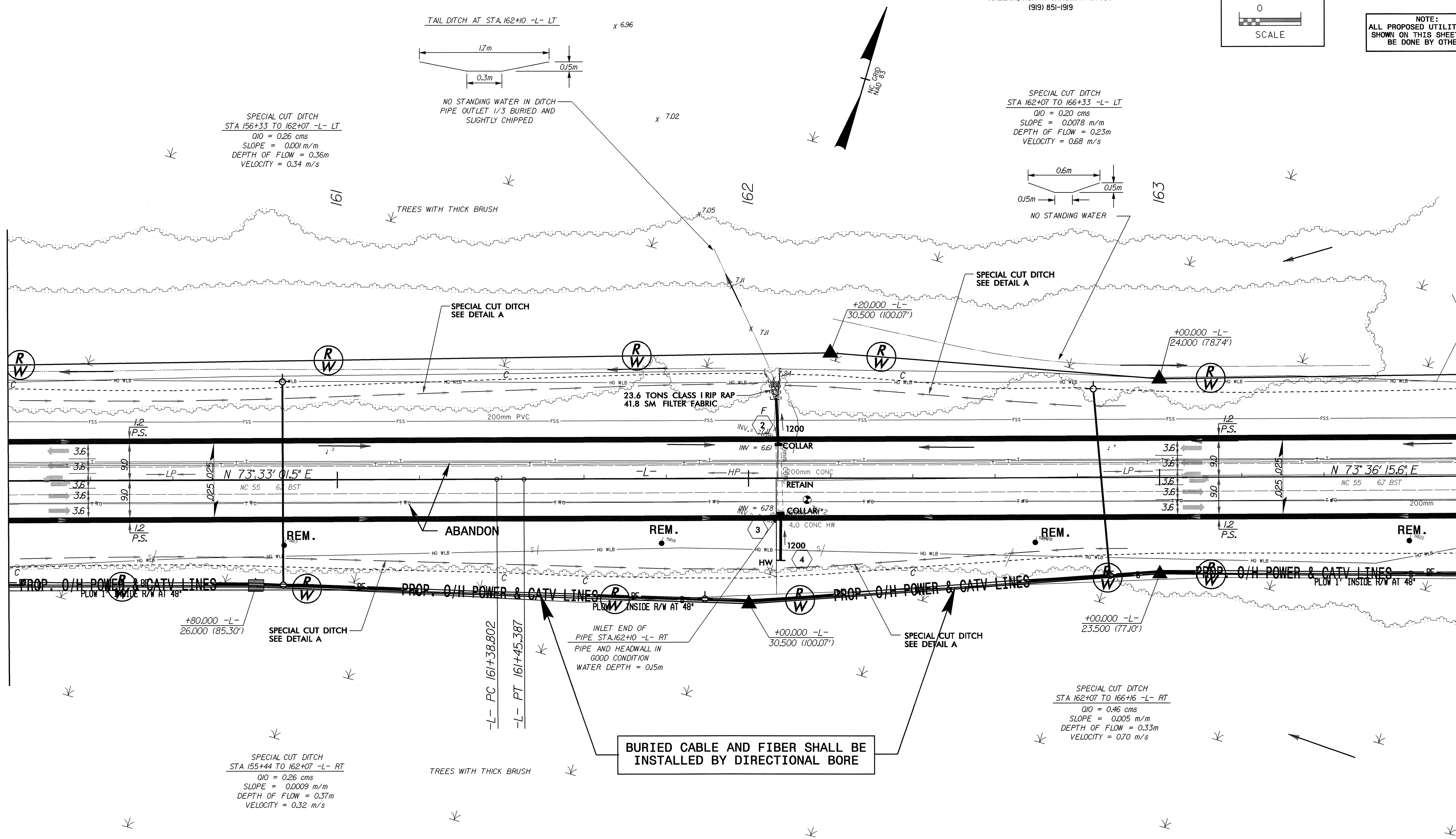

SPECIAL CUT DITCH
STA 156+33 TO 162+07 -L- LT
Q10 = 0.26 cms
SLOPE = 0.001 m/m
DEPTH OF FLOW = 0.36m
VELOCITY = 0.34 m/s

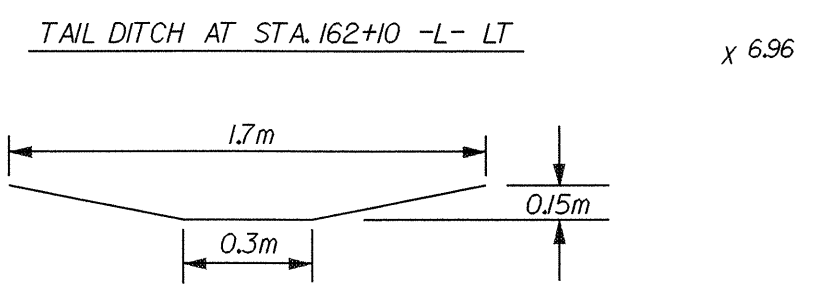

SPECIAL CUT DITCH
STA 162+07 TO 166+33 -L- LT
Q10 = 0.20 cms
SLOPE = 0.0078 m/m
DEPTH OF FLOW = 0.23m
VELOCITY = 0.68 m/s

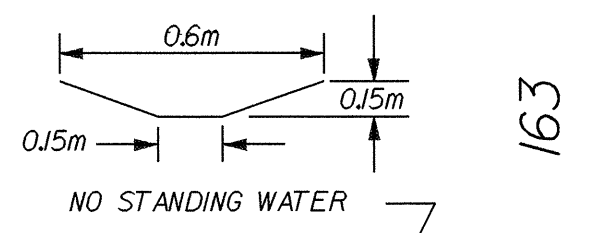

SPECIAL CUT DITCH
STA 155+44 TO 162+07 -L- RT
Q10 = 0.26 cms
SLOPE = 0.0009 m/m
DEPTH OF FLOW = 0.37m
VELOCITY = 0.32 m/s

SPECIAL CUT DITCH
STA 162+07 TO 166+16 -L- RT
Q10 = 0.46 cms
SLOPE = 0.005 m/m
DEPTH OF FLOW = 0.33m
VELOCITY = 0.70 m/s

BURIED CABLE AND FIBER SHALL BE
INSTALLED BY DIRECTIONAL BORE

STA 160+20 TO STA 162+07 -L- LT
STA 160+20 TO STA 162+07 -L- RT
STA 162+07 TO STA 162+92 -L- LT
STA 162+07 TO STA 162+92 -L- RT

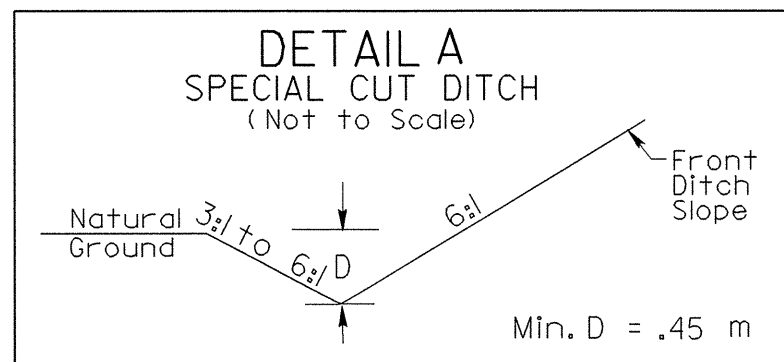

-L-
PI Sta 161+42.094
Δ = 0° 03' 14.0" (RT)
L = 6.585
T = 3.292
R = 7000.000
S.E. = N C

SEE SHEET NO. 30 FOR -L- PROFILE

26-OCT-2004 13:50
R:\U1611\Drawings\2539\UO-4.dgn