

042957

6/10/99

GREENHORNE & O'MARA, INC.
5565 CENTERVIEW DRIVE, SUITE 107
RALEIGH, NORTH CAROLINA 27606
(919) 851-1919

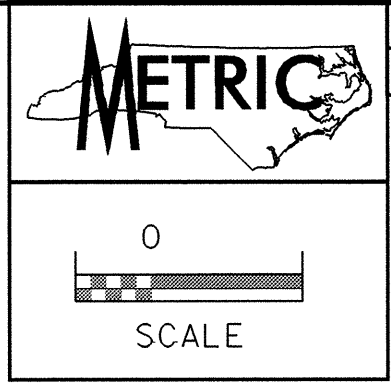

PROJECT REFERENCE NO. R-2539C SHEET NO. UO-19

UTILITIES BY OTHERS

NOTE:
ALL PROPOSED UTILITY WORK
SHOWN ON THIS SHEET WILL
BE DONE BY OTHERS

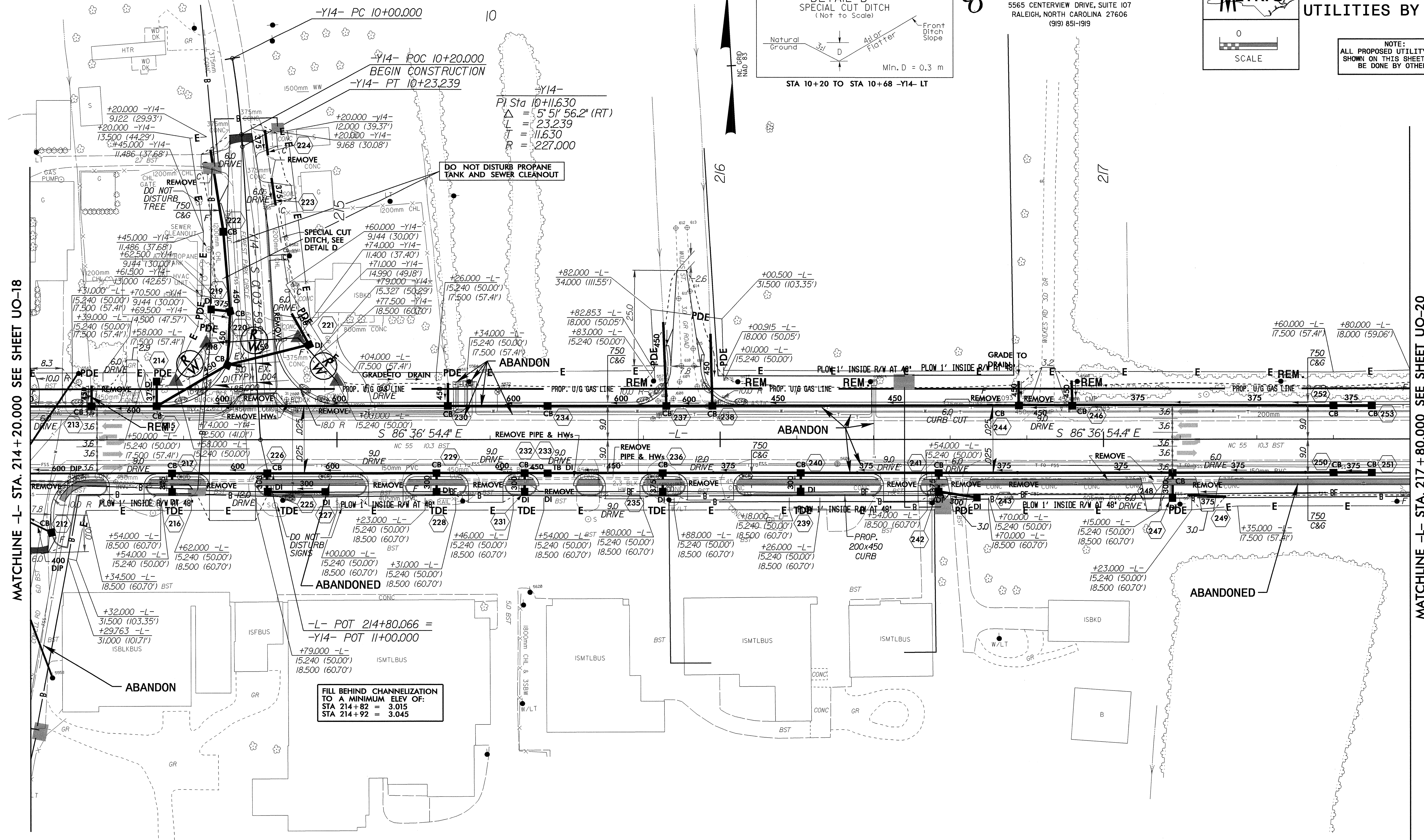
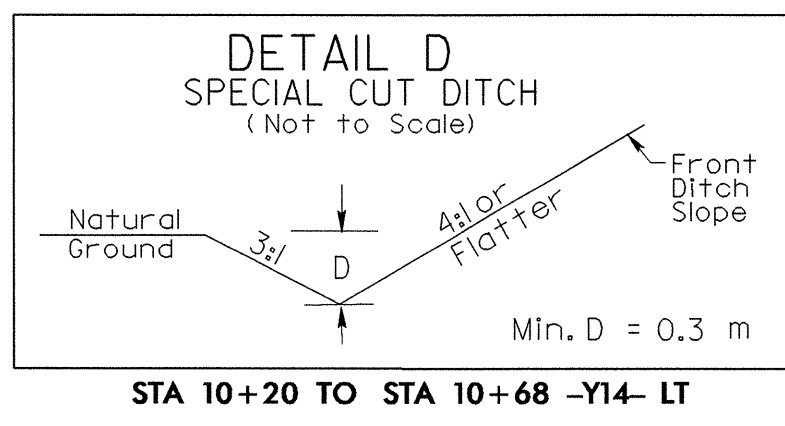

MATCHLINE -L- STA. 214 + 20.000 SEE SHEET UO-18

MATCHLINE -L- STA. 217 + 80.000 SEE SHEET UO-20

FILL BEHIND CHANNELIZATION
TO A MINIMUM ELEV. OF:
STA 214+82 = 3.015
STA 214+92 = 3.045

- NOTES:
1. DRIVES IN SHOULDER SECTION, RADIUS = 1.5m @ E.O.P. (UNLESS OTHERWISE NOTED ON PLANS).
 2. ALL DRIVES IN CURB AND GUTTER SECTIONS ARE RADIUS TYPE DRIVEWAYS WITH A 0.9m RADIUS @ FACE OF CURB (UNLESS OTHERWISE NOTED ON PLANS).
 3. CHANNELIZATION RADIUS = 3.095m @ E.O.P. (UNLESS OTHERWISE NOTED ON PLANS).
 4. OFFSET FROM R/W TO 200x450 CURB = 0.0m (TYP.)

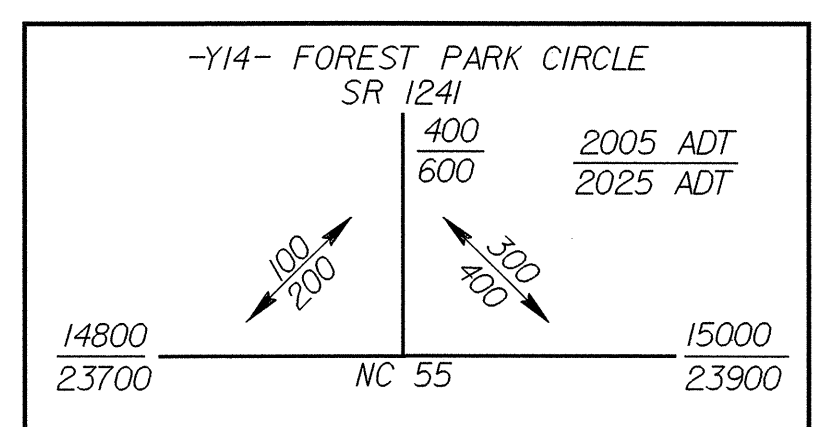

SEE SHEET NO. 37 FOR -L- PROFILE
SEE SHEET NO. 43 FOR -Y14- PROFILE
SEE SHEET NO. 2-K FOR -Y14
INTERSECTION DETAIL.

REVISIONS:

26-OCT-2004 13:56
R:\Users\jtee\1\Projects\2539C\21_UO-19.dgn