

PAMLICO COUNTY (COURTHOUSE) DB 4 - PG 15 DB 212 - PG 899

RUTH GAIL T. RICE DB 286 - PG 729

BAYBORO LODGE #331 OF ANCIENT FREE AND ACCEPTED MASONS DB 187 - PG 148 MB 3 - PG 68

GREENHORNE & O'MARA, INC. 5565 CENTERVIEW DRIVE, SUITE 107 RALEIGH, NORTH CAROLINA 27606 (919) 851-1919

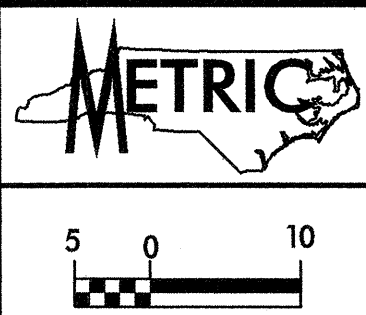

PROJECT REFERENCE NO. R-2539C		SHEET NO. 27	
R/W SHEET NO.			
ROADWAY DESIGN ENGINEER	HYDRAULICS ENGINEER		
PRELIMINARY PLANS DO NOT USE FOR CONSTRUCTION			
INCOMPLETE PLANS DO NOT USE FOR R/W ACQUISITION			
CONST.REV.		R/W REV.	

MATCHLINE -L- STA. 235 + 80.000 SEE SHEET NO. 26

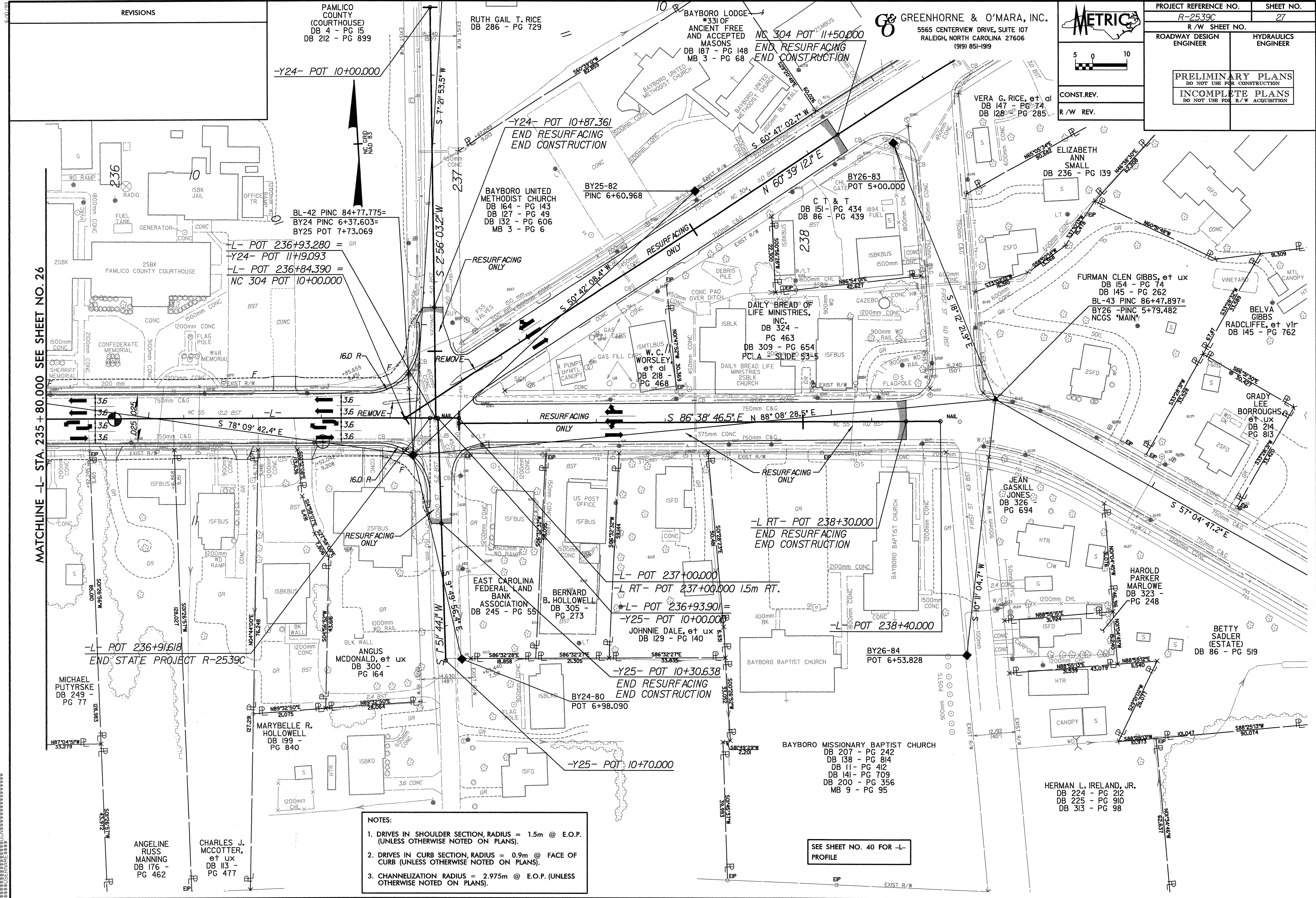

- NOTES:
1. DRIVES IN SHOULDER SECTION, RADIUS = 1.5m @ E.O.P. (UNLESS OTHERWISE NOTED ON PLANS).
 2. DRIVES IN CURB SECTION, RADIUS = 0.9m @ FACE OF CURB (UNLESS OTHERWISE NOTED ON PLANS).
 3. CHANNELIZATION RADIUS = 2.975m @ E.O.P. (UNLESS OTHERWISE NOTED ON PLANS).

SEE SHEET NO. 40 FOR -L- PROFILE

ANGELINE RUSS MANNING DB 176 - PG 462

CHARLES J. MCCOTTER, et ux DB 113 - PG 477

MICHAEL PUTYRSKE DB 249 - PG 77

-L- POT 236+91.618 END STATE PROJECT R-2539C

MARYBELLE R. HOLLOWELL DB 199 - PG 840

ANGUS MCDONALD, et ux DB 300 - PG 164

EAST CAROLINA FEDERAL LAND BANK ASSOCIATION DB 245 - PG 55

BERNARD B. HOLLOWELL DB 305 - PG 273

JOHNNIE DALE, et ux DB 129 - PG 140

BY26-84 POT 6+53.828

JEAN GASKILL JONES DB 326 - PG 694

HAROLD PARKER MARLOWE DB 323 - PG 248

BETTY SADLER (ESTATE) DB 86 - PG 519

HERMAN L. IRELAND, JR. DB 224 - PG 212 DB 225 - PG 910 DB 313 - PG 98

BAYBORO MISSIONARY BAPTIST CHURCH DB 207 - PG 242 DB 138 - PG 814 DB 11 - PG 412 DB 141 - PG 709 DB 200 - PG 356 MB 9 - PG 95

BY24-80 POT 6+98.090

-Y25- POT 10+70.000

-Y25- POT 10+30.638 END RESURFACING END CONSTRUCTION

-L- POT 237+00.000

-L RT- POT 237+00.000 1.5m RT.

-L- POT 236+93.90 =

-L RT- POT 238+30.000 END RESURFACING END CONSTRUCTION

-L- POT 238+40.000

RESURFACING ONLY

-Y24- POT 10+87.361 END RESURFACING END CONSTRUCTION

BAYBORO UNITED METHODIST CHURCH DB 164 - PG 143 DB 127 - PG 49 DB 132 - PG 606 MB 3 - PG 6

BL-42 PINC 84+77.775= BY24 PINC 6+37.603= BY25 POT 7+73.069

-L- POT 236+93.280 = GR
-Y24- POT 11+19.093
-L- POT 236+84.390 = NC 304 POT 10+00.000

ISBK JAIL OFFICE TR.

PAMLICO COUNTY COURTHOUSE

CONFEDERATE MEMORIAL

WAR MEMORIAL

ISFBUS

ISFBUS

ISFBUS

ISFBUS

ISFBUS

ISFBUS

ISBKD

ISBKD

ISBKD

RESURFACING ONLY

RESURFACING ONLY

RESURFACING ONLY

RESURFACING ONLY

RESURFACING ONLY

RESURFACING ONLY

RESURFACING ONLY

RESURFACING ONLY

RESURFACING ONLY

RESURFACING ONLY

RESURFACING ONLY

RESURFACING ONLY

RESURFACING ONLY

RESURFACING ONLY

RESURFACING ONLY

RESURFACING ONLY

RESURFACING ONLY

RESURFACING ONLY

RESURFACING ONLY

RESURFACING ONLY

RESURFACING ONLY

RESURFACING ONLY

RESURFACING ONLY

RESURFACING ONLY

RESURFACING ONLY

RESURFACING ONLY

RESURFACING ONLY

RESURFACING ONLY

RESURFACING ONLY