

**METRIC**

CONST.REV.  
R /W REV.

PROJECT REFERENCE NO. R-2539C	SHEET NO. EC-50/CONST.22
R /W SHEET NO.	
ROADWAY DESIGN ENGINEER	HYDRAULICS ENGINEER

MATCHLINE -L- STA. 217 + 80.000 SEE SHEET NO. 21

MATCHLINE -L- STA. 221 + 40.000 SEE SHEET NO. 23

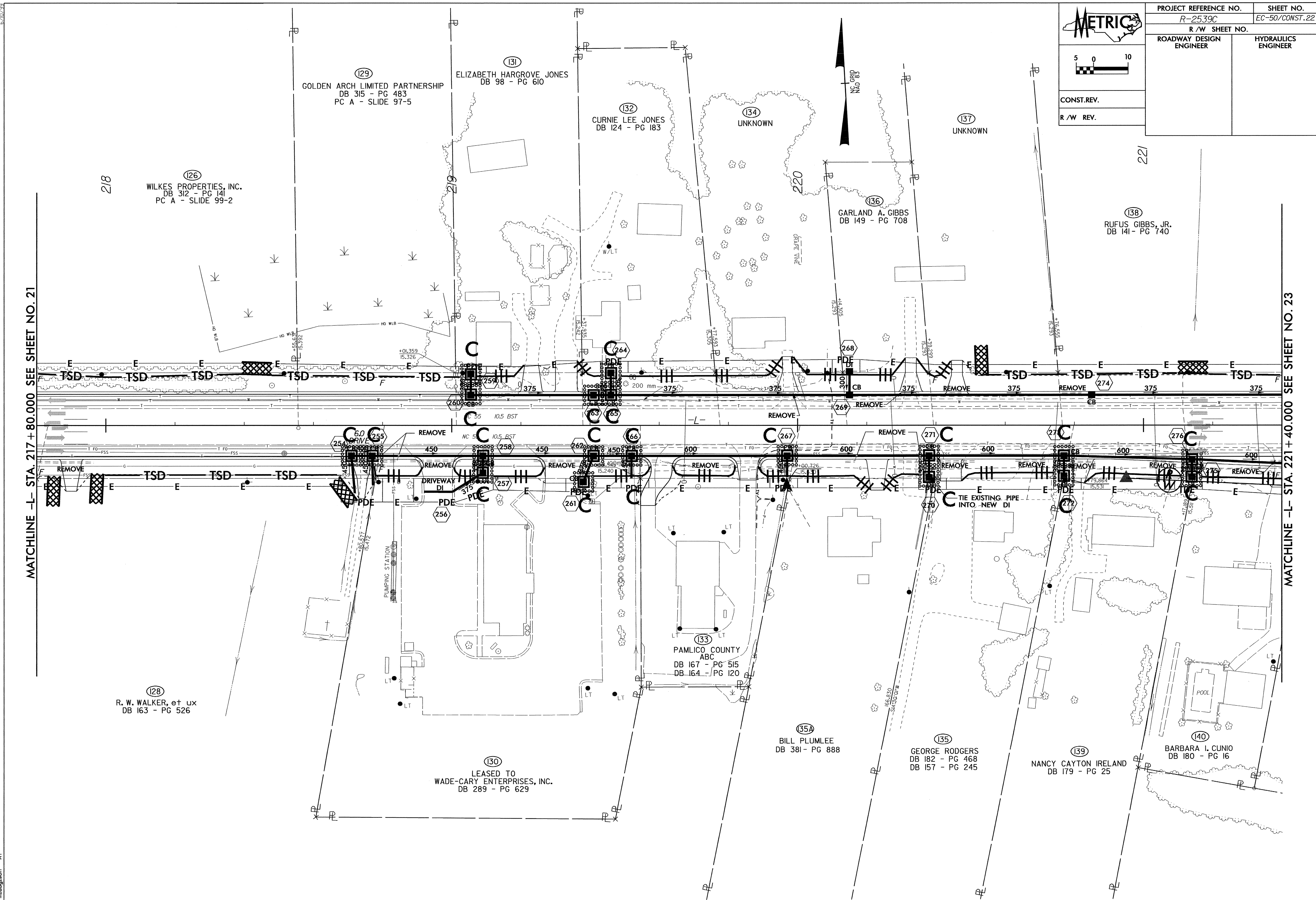

218  
 (126)  
 WILKES PROPERTIES, INC.  
 DB 312 - PG 141  
 PC A - SLIDE 99-2

(129)  
 GOLDEN ARCH LIMITED PARTNERSHIP  
 DB 315 - PG 483  
 PC A - SLIDE 97-5

(131)  
 ELIZABETH HARGROVE JONES  
 DB 98 - PG 610

(132)  
 CURNIE LEE JONES  
 DB 124 - PG 183

(134)  
 UNKNOWN

(136)  
 GARLAND A. GIBBS  
 DB 149 - PG 708

(137)  
 UNKNOWN

(138)  
 RUFUS GIBBS, JR.  
 DB 141 - PG 740

(128)  
 R. W. WALKER, et ux  
 DB 163 - PG 526

(130)  
 LEASED TO  
 WADE-CARY ENTERPRISES, INC.  
 DB 289 - PG 629

(133)  
 PAMLICO COUNTY  
 ABC  
 DB 167 - PG 515  
 DB 164 - PG 120

(135A)  
 BILL PLUMLEE  
 DB 381 - PG 888

(135)  
 GEORGE RODGERS  
 DB 182 - PG 468  
 DB 157 - PG 245

(139)  
 NANCY CAYTON IRELAND  
 DB 179 - PG 25

(140)  
 BARBARA I. CUNIO  
 DB 180 - PG 16

6/10/2021 11:02:53 AM R2539C22.PSH  
 C:\Users\mhaugh\OneDrive\Documents\Projects\2539\22\22.PSH