

PROPOSED 16" WATER LINE

Point 2001	N	797,884.80 E	1,994,303.17 Sta	0+00.00
Course from 2001 to 2002	N 65° 10' 59.08"	E Dist 73.17		
Point 2002	N	797,915.51 E	1,994,369.59 Sta	0+73.17
Course from 2002 to 2003	N 67° 35' 06.49"	E Dist 149.45		
Point 2003	N	797,972.50 E	1,994,507.75 Sta	2+22.63
Course from 2003 to 2004	N 67° 42' 49.38"	E Dist 282.08		
Point 2004	N	798,079.47 E	1,994,768.76 Sta	5+04.71
Course from 2004 to 2005	N 68° 02' 45.01"	E Dist 124.96		
Point 2005	N	798,126.19 E	1,994,884.65 Sta	6+29.66
Course from 2005 to 2006	N 68° 02' 44.78"	E Dist 109.34		
Point 2006	N	798,167.07 E	1,994,986.06 Sta	7+39.01
Course from 2006 to 2007	N 66° 41' 18.92"	E Dist 90.06		
Point 2007	N	798,202.70 E	1,995,068.77 Sta	8+29.06
Course from 2007 to 2008	N 65° 59' 48.73"	E Dist 86.64		
Point 2008	N	798,237.95 E	1,995,147.91 Sta	9+15.70
Course from 2008 to 2009	N 65° 59' 47.74"	E Dist 27.48		
Point 2009	N	798,249.12 E	1,995,173.01 Sta	9+43.18
Course from 2009 to 2010	N 65° 59' 49.85"	E Dist 26.51		
Point 2010	N	798,259.91 E	1,995,197.23 Sta	9+69.68
Course from 2010 to 2011	N 65° 59' 48.11"	E Dist 33.85		
Point 2011	N	798,273.68 E	1,995,228.15 Sta	10+03.53
Course from 2011 to 2012	N 65° 57' 39.18"	E Dist 22.55		
Point 2012	N	798,282.86 E	1,995,248.74 Sta	10+26.08
Course from 2012 to 2013	N 62° 36' 26.54"	E Dist 27.29		
Point 2013	N	798,295.42 E	1,995,272.97 Sta	10+53.37
Course from 2013 to 2014	N 62° 36' 27.70"	E Dist 24.98		
Point 2014	N	798,306.91 E	1,995,295.15 Sta	10+78.35
Course from 2014 to 2015	N 62° 36' 26.08"	E Dist 29.11		
Point 2015	N	798,320.30 E	1,995,321.00 Sta	11+07.46
Course from 2015 to 2016	N 62° 36' 27.71"	E Dist 38.39		
Point 2016	N	798,337.97 E	1,995,355.08 Sta	11+45.85
Course from 2016 to 2017	N 62° 33' 31.59"	E Dist 14.53		
Point 2017	N	798,344.66 E	1,995,367.98 Sta	11+60.38
Course from 2017 to 2018	N 61° 05' 38.44"	E Dist 26.59		
Point 2018	N	798,357.51 E	1,995,391.25 Sta	11+86.96
Course from 2018 to 2019	N 61° 05' 38.79"	E Dist 35.70		
Point 2019	N	798,374.77 E	1,995,422.50 Sta	12+22.66
Course from 2019 to 2020	N 61° 05' 39.04"	E Dist 51.72		
Point 2020	N	798,399.77 E	1,995,467.78 Sta	12+74.38
Course from 2020 to 2021	N 61° 14' 32.14"	E Dist 35.20		
Point 2021	N	798,416.70 E	1,995,498.64 Sta	13+09.59
Course from 2021 to 2022	N 61° 26' 40.94"	E Dist 29.26		
Point 2022	N	798,430.69 E	1,995,524.34 Sta	13+38.85
Course from 2022 to 2023	N 61° 26' 41.18"	E Dist 126.57		
Point 2023	N	798,491.19 E	1,995,635.51 Sta	14+65.41

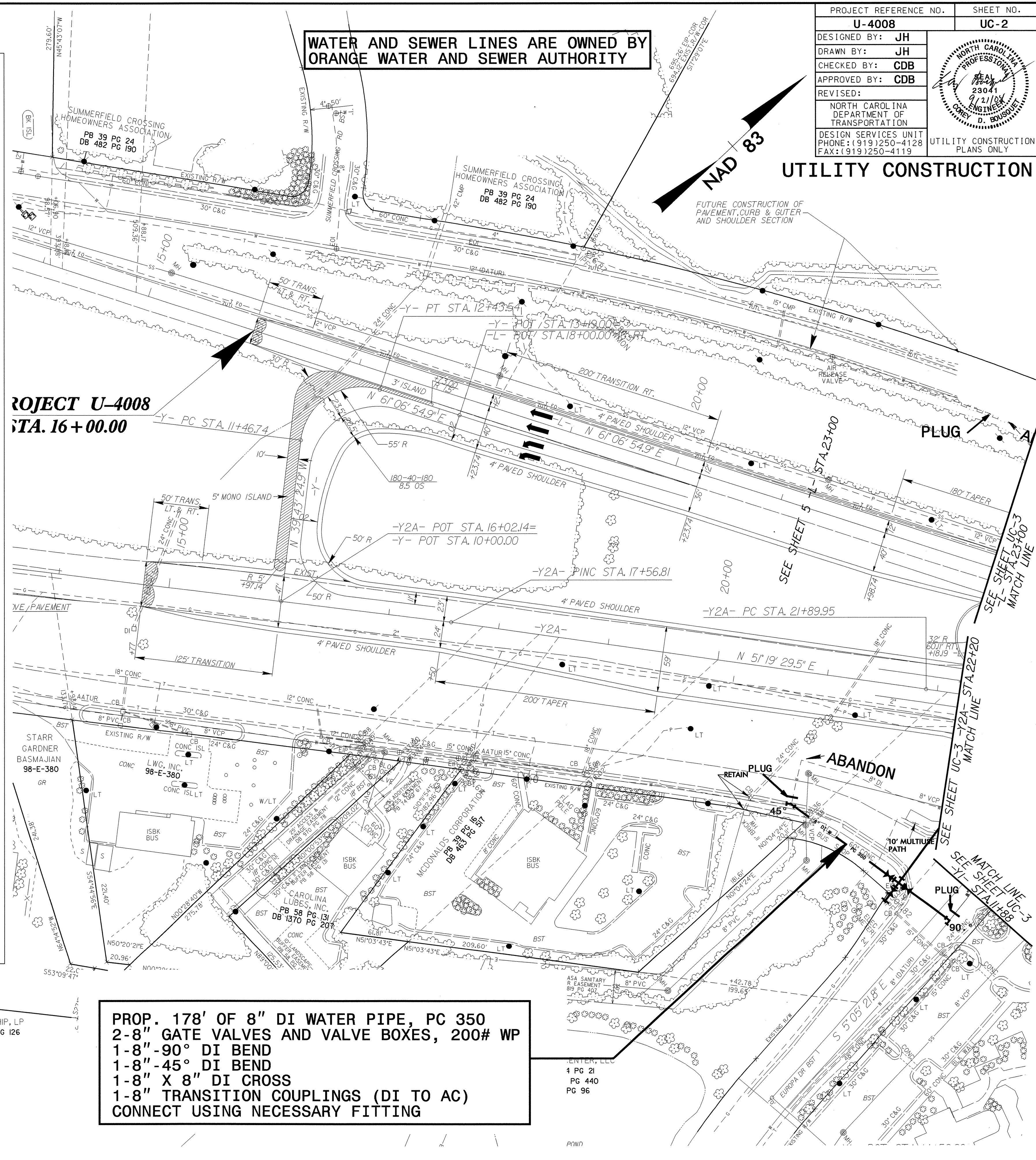

PROP. 178' OF 8" DI WATER PIPE, PC 350
 2-8" GATE VALVES AND VALVE BOXES, 200# WP
 1-8"-90° DI BEND
 1-8"-45° DI BEND
 1-8" X 8" DI CROSS
 1-8" TRANSITION COUPLINGS (DI TO AC)
 CONNECT USING NECESSARY FITTING

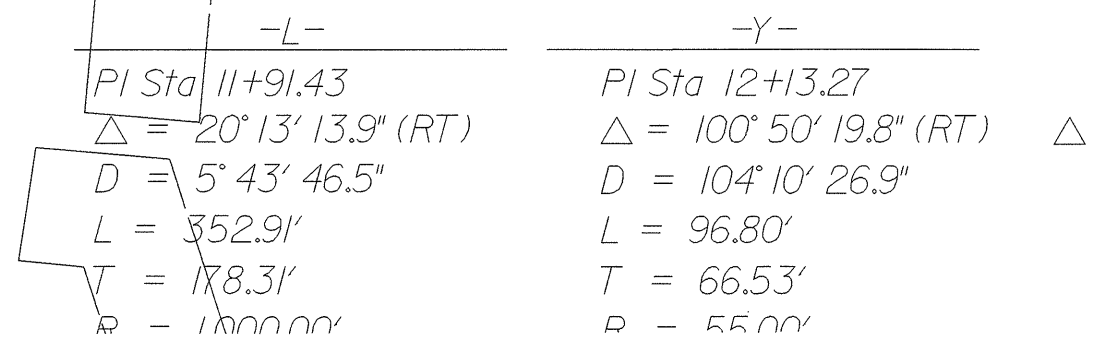

8/17/99
 21-SEP-2004 14:01
 R:\Utilities\Proj_U\U-4008\sh4_UC2.DGN
 J:\Projects\U-4008\sh4_UC2.DGN