

NOTES

PROVIDE 1/4" HIGH BEAM BOLSTERS UPPER AT 4'-0" CTS. ATOP THE METAL STAY-IN-PLACE METAL FORMS TO SUPPORT THE BOTTOM MAT OF 'A' BARS. WHEN USING REMOVABLE FORMS, PROVIDE CONTINUOUS HIGH CHAIRS FOR METAL DECK (C.H.C.M.) @ 4'-0" CTS. WITH A HEIGHT TO SUPPORT THE BOTTOM MAT OF 'A' BARS A CLEAR DISTANCE OF 2/2" ABOVE THE TOP OF THE REMOVABLE FORM.

LONGITUDINAL STEEL MAY BE SHIFTED SLIGHTLY, AS NECESSARY, TO AVOID INTERFERENCE WITH STIRRUPS IN PRESTRESSED CONCRETE GIRDERS.

NO CHAMFER IS REQUIRED ON CORNERS OF GIRDER BUILDUPS.

PREVIOUSLY CAST CONCRETE IN A CONTINUOUS UNIT SHALL HAVE ATTAINED A MINIMUM COMPRESSIVE STRENGTH OF 3,000 PSI BEFORE ADDITIONAL CONCRETE IS CAST IN THE UNIT.

TEMPORARY STRUTS SHALL BE PLACED BETWEEN PRESTRESSED GIRDERS ADJACENT TO THE DIAPHRAGMS AND THE NUTS ON THE 1/4" DIA. TIE RODS SHALL BE FULLY TIGHTENED BEFORE THE DIAPHRAGMS ARE CAST. STRUTS SHALL REMAIN IN PLACE 3 DAYS AFTER CONCRETE IS PLACED. THE TIE RODS SHALL BE RE-TIGHTENED AFTER THE STRUTS HAVE BEEN REMOVED.

CONCRETE IN INTERMEDIATE DIAPHRAGMS MAY BE CLASS A IN LIEU OF CLASS AA. PAYMENT SHALL BE MADE UNDER THE UNIT CONTRACT PRICE FOR REINFORCED CONCRETE DECK SLAB.

FOR CONCRETE PARAPET DETAILS AND REINFORCING, SEE "1'-0" x 1'-6" CONCRETE PARAPET" SHEET.

THE PARAPET SHALL NOT BE CAST UNTIL ALL SLAB CONCRETE HAS BEEN CAST AND HAS REACHED A MINIMUM COMPRESSIVE STRENGTH OF 3000 PSI.

FOR ONE BAR METAL RAIL DETAILS, SEE "ONE BAR METAL RAIL" SHEET.

PRESTRESSED CONCRETE DECK PANELS MAY BE USED IN LIEU OF METAL STAY-IN PLACE FORMS IN ACCORDANCE WITH ARTICLE 420-3 OF THE STANDARD SPECIFICATIONS.

2/4" HIGH B.B.U. LOCATED BETWEEN TOP AND BOTTOM MATS OF REINFORCING STEEL AT THE #4"B" BAR (TOP BAR) LOCATION ONLY, SEE PLAN OF SPAN.

1 3/4" HIGH B.B.U. LOCATED BETWEEN TOP AND BOTTOM MATS OF REINFORCING STEEL AT THE #7"B" BAR (TOP BAR) LOCATION ONLY, SEE PLAN OF SPAN.

FOR FABRICATED METAL STAY-IN-PLACE FORMS, SEE SPECIAL PROVISIONS.

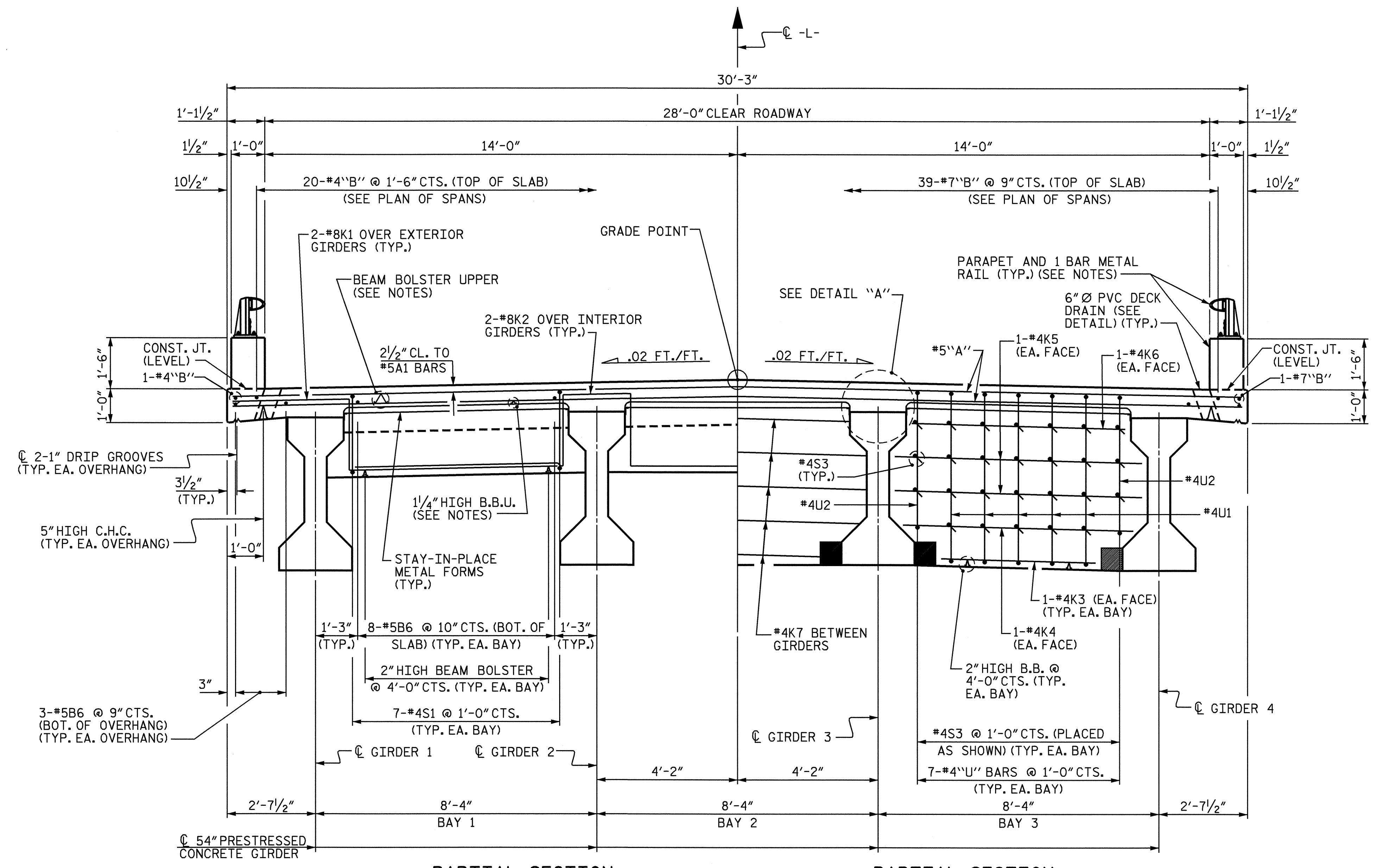

PARTIAL SECTION
SHOWING END BENT DIAPHRAGM

PARTIAL SECTION
SHOWING BENT DIAPHRAGM

TYPICAL SECTION

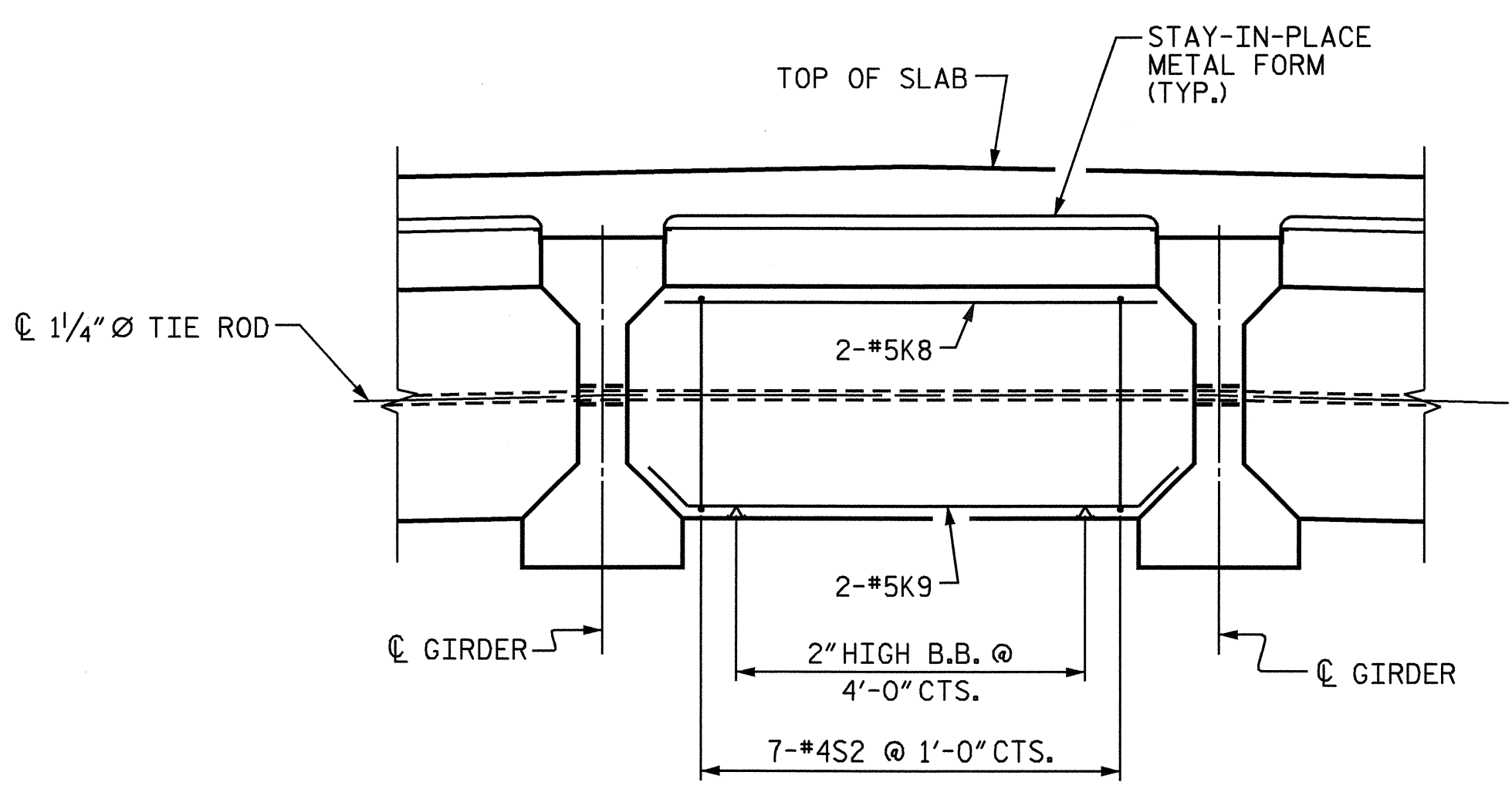

TYPICAL INTERMEDIATE DIAPHRAGM

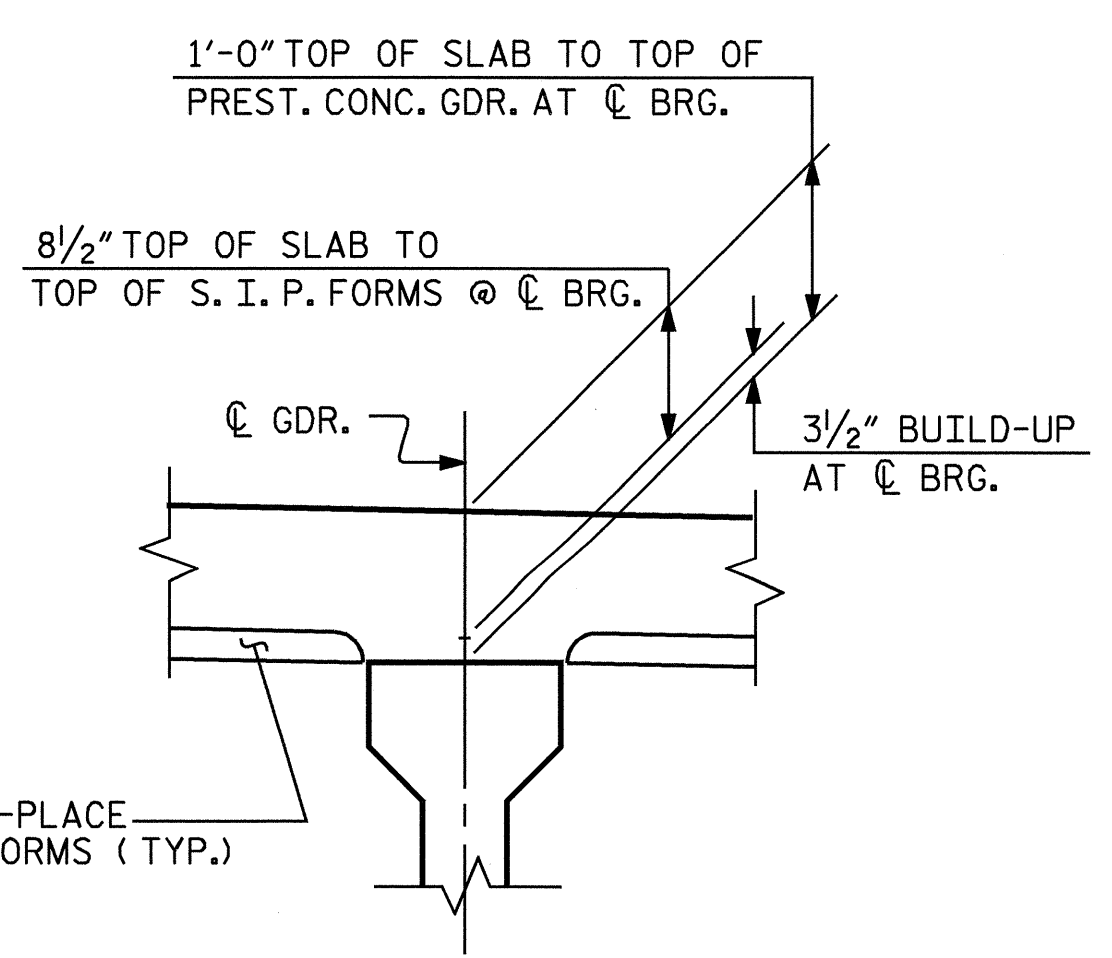

DETAIL "A"

PROJECT NO. B-3350
IREDELL COUNTY
STATION: 17+33.50 -L-

SHEET 1 OF 2

STATE OF NORTH CAROLINA
DEPARTMENT OF TRANSPORTATION
RALEIGH

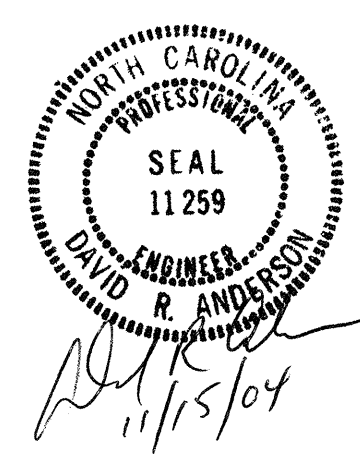

SUPERSTRUCTURE
TYPICAL SECTION

DRAWN BY: T.A. WALTER DATE: 6/19/02
CHECKED BY: N.Q. TRAN DATE: 8/8/02

REVISIONS						SHEET NO.	
NO.	BY:	DATE:	NO.	BY:	DATE:	5-4	
1			3			TOTAL SHEETS	
2			4			35	