

09/08/99

CONTRACT: C200862 TIP PROJECT: B-3659

See Sheet 1-A For Index of Sheets

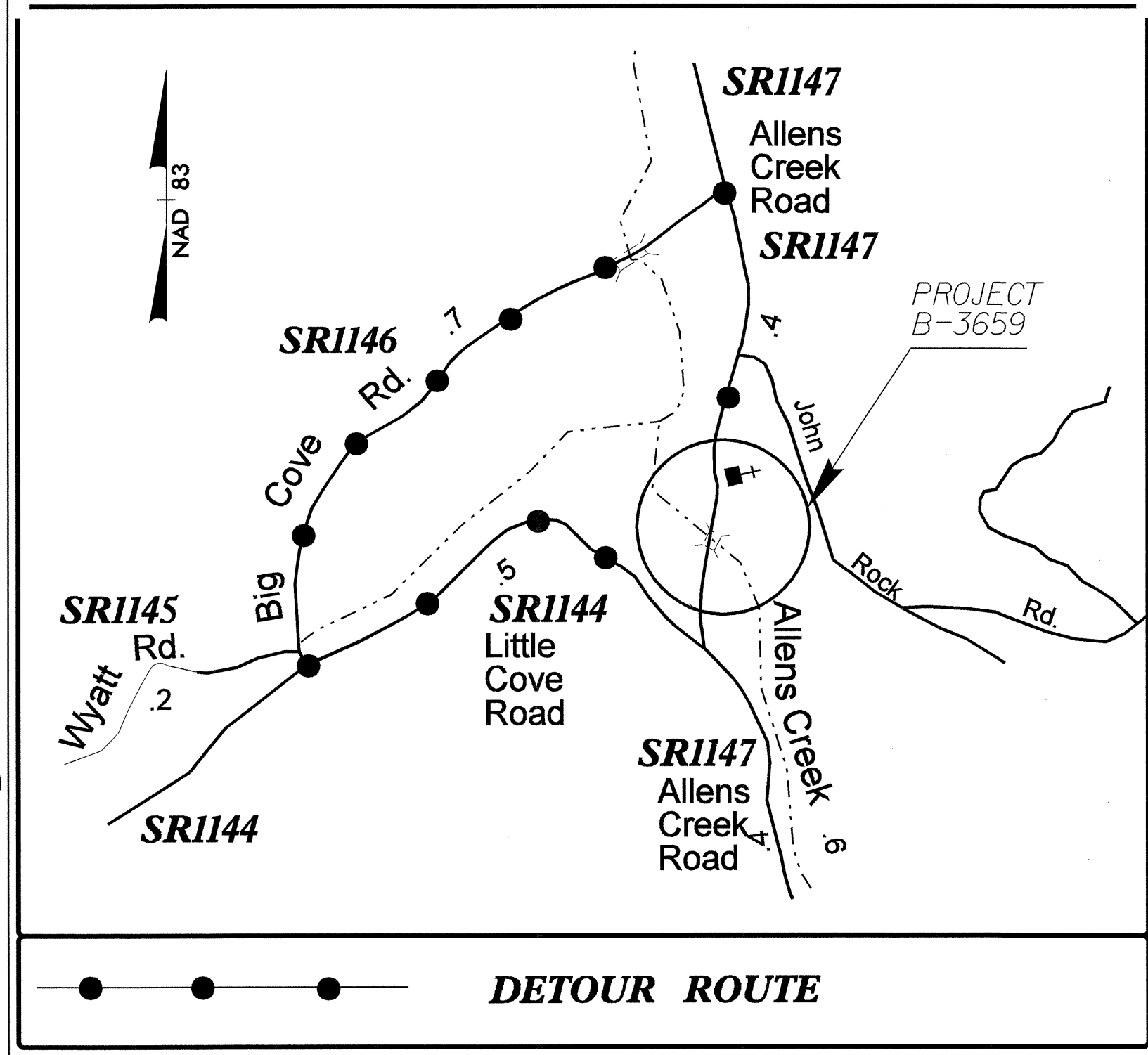

DETOUR ROUTE

PROJECT VICINITY MAP

STATE OF NORTH CAROLINA
DIVISION OF HIGHWAYS

HAYWOOD COUNTY

LOCATION: BRIDGE NO. 112 OVER ALLENS CREEK
ON SR 1147 (ALLENS CREEK ROAD)

TYPE OF WORK: GRADING, PAVING, DRAINAGE AND STRUCTURE

STATE	STATE PROJECT REFERENCE NO.	SHEET NO.	TOTAL SHEETS
N.C.	B-3659	1	
STATE PROJ. NO.	F.A. PROJ. NO.	DESCRIPTION	
33204.1.1	BRZ-1147(4)	P.E.	
33204.2.2	BRZ-1147(4)	R/W & UTIL	
33204.3.1	BRZ-1147(9)	CONST.	

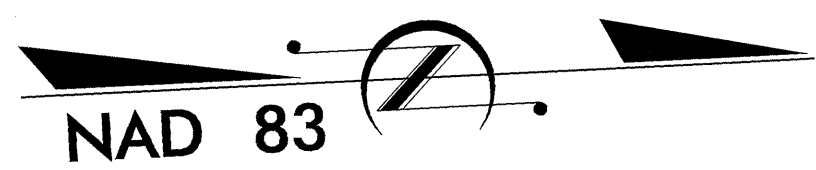

4

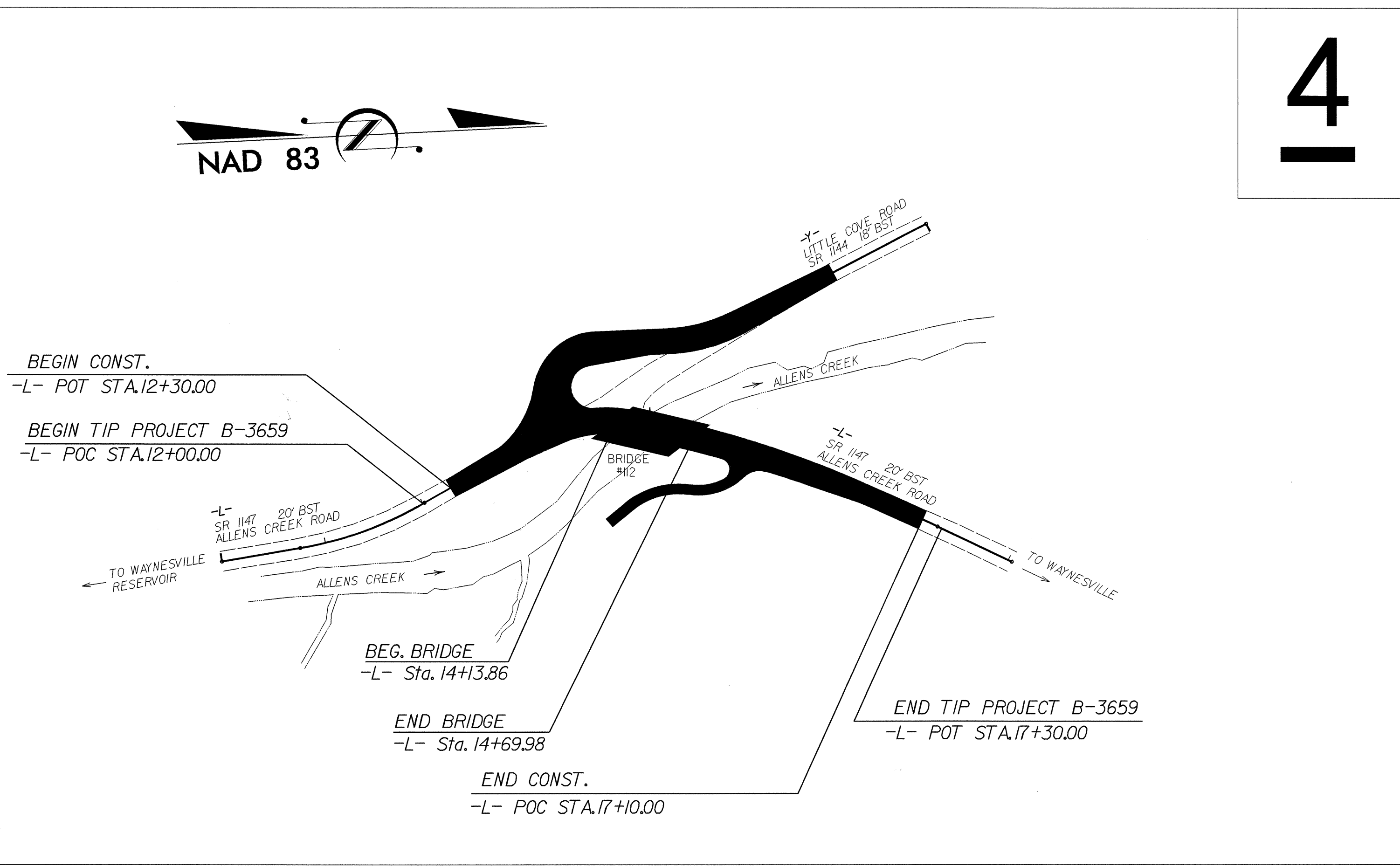

** REQUIRES DESIGN EXCEPTION AS IT RELATES TO HORIZONTAL AND VERTICAL ALIGNMENTS.

GRAPHIC SCALES

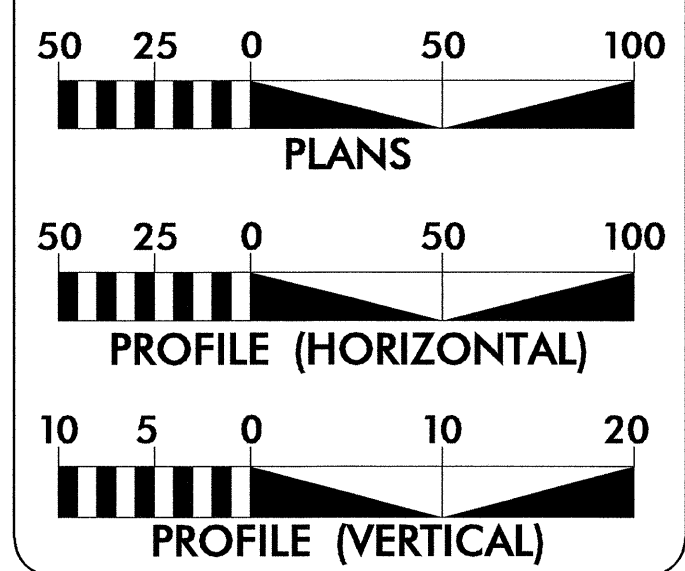

DESIGN DATA

ADT 2005 = 346
 ADT 2025 = 500
 DHV = 10 %
 D = 60 %
 T = 3 % *
 ** V = 15 MPH
 * TTST 1 % DUAL 2 %

PROJECT LENGTH

LENGTH ROADWAY TIP PROJECT B-3659 = 0.089 MILES
 LENGTH STRUCTURE TIP PROJECT B-3659 = 0.011 MILES
 TOTAL LENGTH TIP PROJECT B-3659 = 0.100 MILES

Prepared in the Office of:
DIVISION OF HIGHWAYS
 1000 Birch Ridge Dr., NC, 27610

2002 STANDARD SPECIFICATIONS
 RIGHT OF WAY DATE:
 OCTOBER 1, 2003
 LETTING DATE:
 FEBRUARY 15, 2005

GARY LOVERING, P.E.
 PROJECT ENGINEER
R. A. SHILLINGLAW, P.E.
 PROJECT DESIGN ENGINEER

HYDRAULICS ENGINEER
 NORTH CAROLINA PROFESSIONAL ENGINEER
 SEAL 20870
 SIGNATURE: [Signature] P.E.
 12-02-09

ROADWAY DESIGN
 NORTH CAROLINA PROFESSIONAL ENGINEER
 SEAL 17691
 SIGNATURE: [Signature] P.E.
 11-30-04

DIVISION OF HIGHWAYS
 STATE OF NORTH CAROLINA

STATE DESIGN ENGINEER
 DEPARTMENT OF TRANSPORTATION
 FEDERAL HIGHWAY ADMINISTRATION

APPROVED
 DIVISION ADMINISTRATOR
 DATE

20-NOV-2004 16:26
P:\PROJ\B-3659\1.dwg
R:\11111.dwg AL RD18717