

NOTE:
 ALL PROPOSED UTILITY WORK
 SHOWN ON THIS SHEET WILL
 BE DONE BY OTHERS

-Y12-
 PI Sta 10+30.451
 $\Delta = 10^{\circ} 52' 17.8" (RT)$
 $L = 60.719$
 $T = 30.451$
 $R = 320.000$
 SE = SEE PLANS

-L-
 PI Sta 64+23.810
 $\Delta = 13^{\circ} 20' 17.7" (LT)$
 $L = 162.957$
 $T = 81.849$
 $R = 700.000$
 SE = SEE PLANS

NOTE: ALL ABOVE GRADE UTILITIES
 (POLES, HYDRANTS, ETC.) ARE TO BE
 PLACED AT THE R/W LINE AND A
 MINIMUM OF 12' FROM FACE OF CURB.

NOTE: BURIED TELEPHONE CABLES
 TO BE PLACED 1 TO 3 FEET
 INSIDE R/W
 LINE

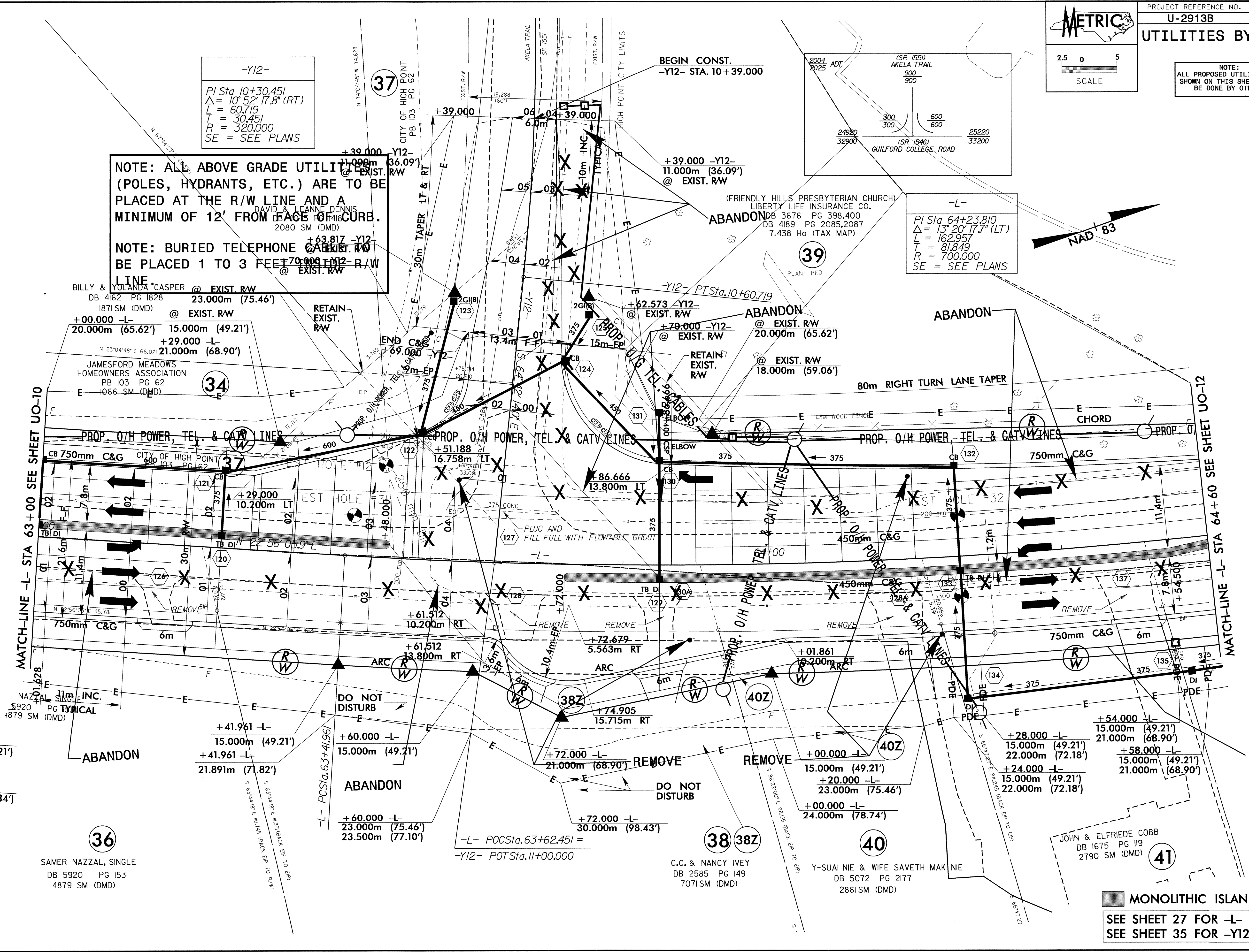

MATCH-LINE -L- STA 63+00 SEE SHEET UO-10

MATCH-LINE -L- STA 64+60 SEE SHEET UO-12

10 -L-
 m (62.34')

11 -L-
 (53')

MONOLITHIC ISLAND
 SEE SHEET 27 FOR -L- PROFILE
 SEE SHEET 35 FOR -Y12- PROFILE

07-OCT-2004 13:49 C:\p1\2913bs_uo11.pht
 042592