

NOTE:
 ALL PROPOSED UTILITY WORK
 SHOWN ON THIS SHEET WILL
 BE DONE BY OTHERS

-L-	-Y13A-
PI Sta. 64+23.810	PI Sta. 10+27.569
$\Delta = 13^{\circ} 20' 17.7" (LT)$	$\Delta = 32^{\circ} 42' 58.0" (LT)$
L = 162.957	L = 35.402
T = 81.849	T = 18.198
R = 700.000	R = 62.000
SE = SEE PLANS	SE = SEE PLANS

NOTE: ALL ABOVE GRADE UTILITIES (POLES, HYDRANTS, ETC.) ARE TO BE PLACED AT THE R/W LINE AND A MINIMUM OF 12' FROM FACE OF CURB.
 NOTE: BURIED TELEPHONE CABLE TO BE PLACED TO 3 FEET INSIDE R/W

NAD 83

FRIENDLY HILLS PRESBYTERIAN CHURCH, INC.
 DB 4346 PG 1820-1823
 4.054 Ha (DEED)

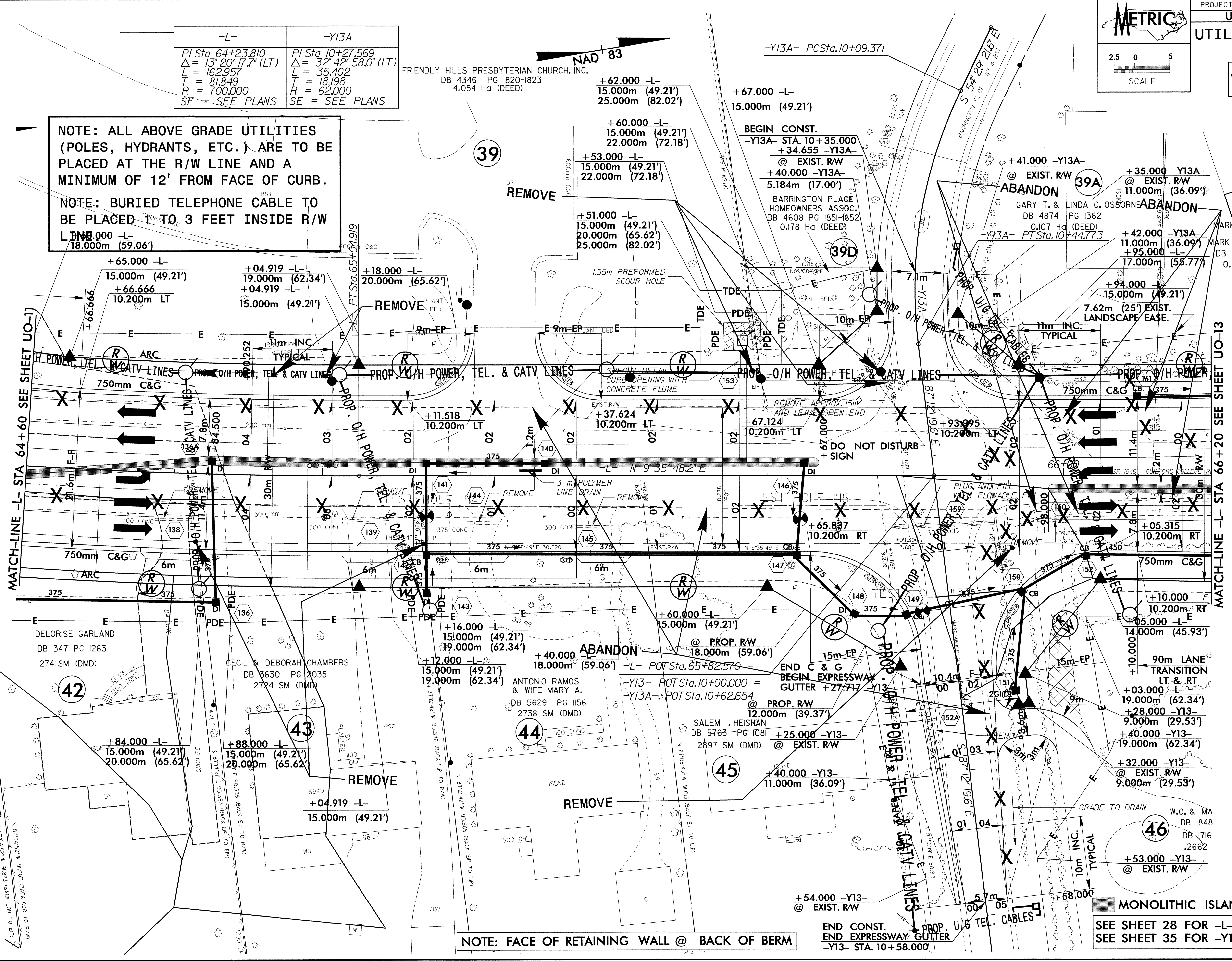

MATCH-LINE -L- STA 64+60 SEE SHEET UO-11

MATCH-LINE -L- STA 66+20 SEE SHEET UO-13

NOTE: FACE OF RETAINING WALL @ BACK OF BERM

SEE SHEET 28 FOR -L- PROFILE
 SEE SHEET 35 FOR -Y13- & -Y13A- PROFILE

07-OCT-2004 13:49 u2913bs_UO12.dwg