

**METRIC**

PROJECT REFERENCE NO. SHEET NO. 25

ROADWAY DESIGN ENGINEER HYDRAULICS ENGINEER

CONST. REV. R/W REV.

2.5 0 5

BM #5 - R/R SPIKE IN BASE OF 400MM PINE  
26.799M RT -L- STA. 52+92.381

PI = 52+00.000  
EL = 265.132 m  
VC = 100 m  
K = 257 (DS > 130 kmh)

PI = 53+00.000  
EL = 266.250 m  
VC = 40 m  
K = 81 (DS > 110 kmh)

SEE SHEET 6 FOR PLAN VIEW

SEE SHEET 7 FOR PLAN VIEW

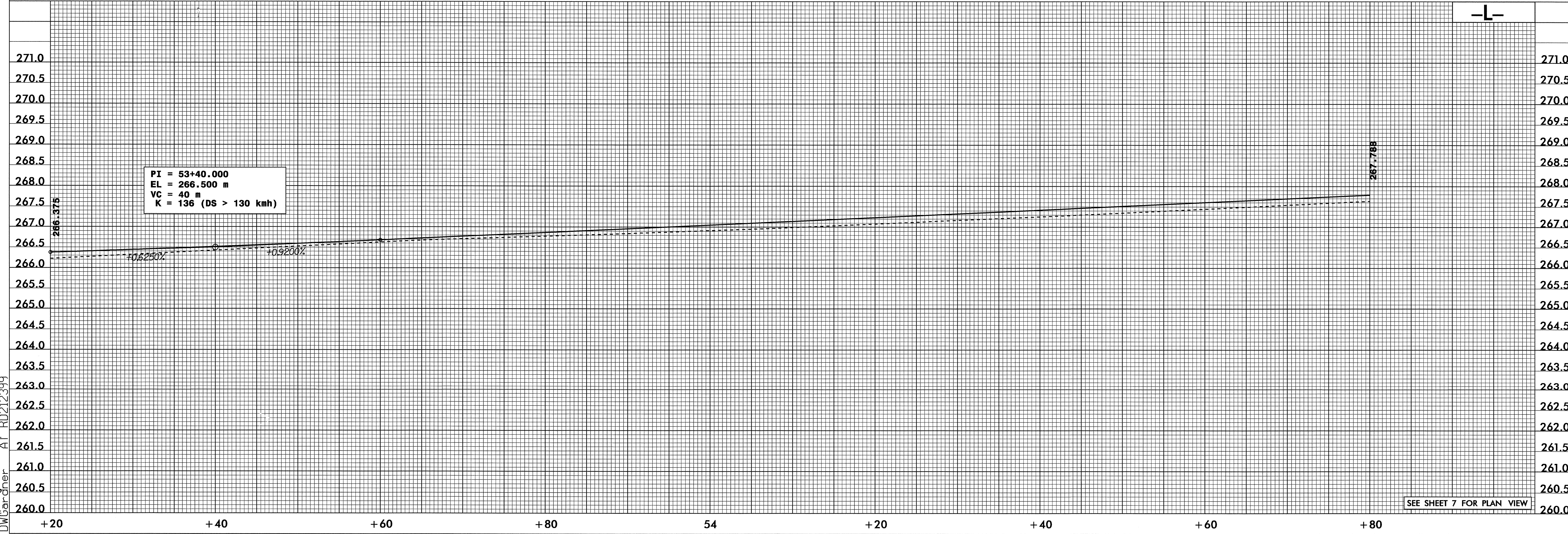
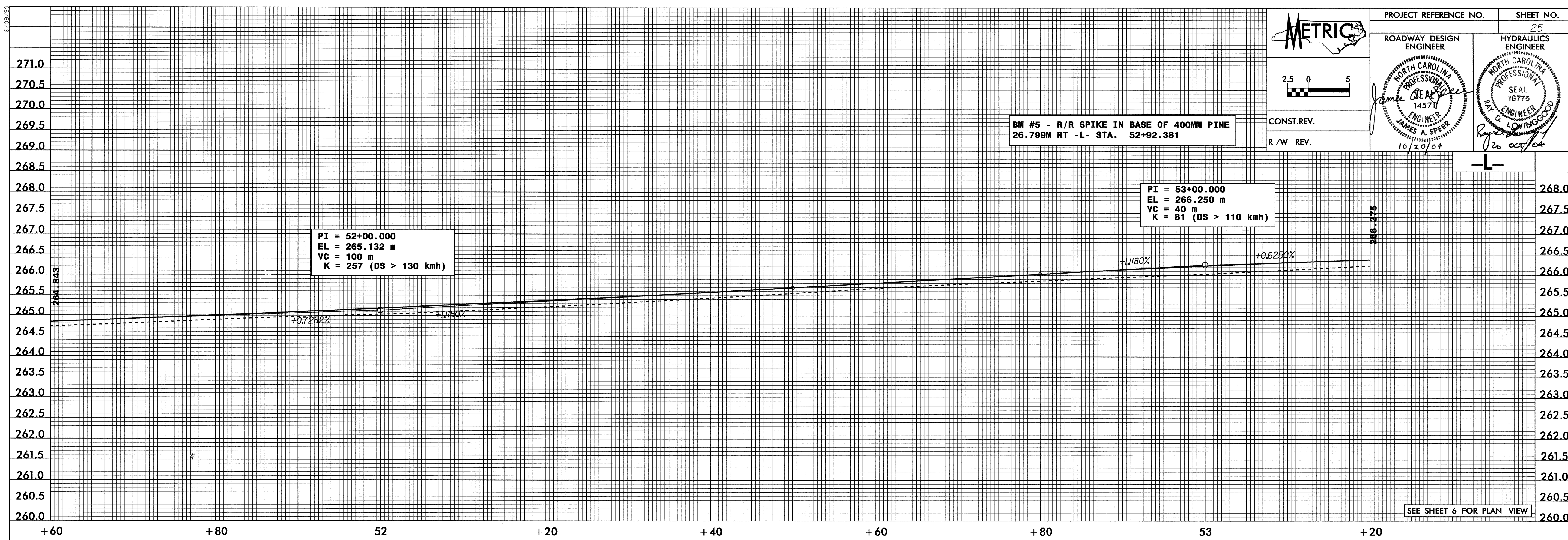

06-AUG-2004 10:31  
 P:\proj\29136\pfl1  
 DWGardner At RD212399