

6/09/04

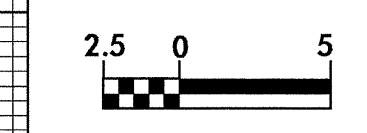

PROJECT REFERENCE NO. U-2913B SHEET NO. 28

ROADWAY DESIGN ENGINEER HYDRAULICS ENGINEER

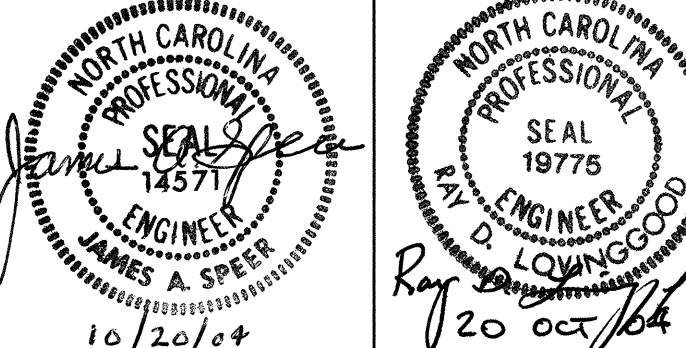

CONST. REV. R /W REV.

BM #8 - R/R SPIKE IN BASE OF 600MM OAK  
11.901M LT -L- STA. 62+52.581

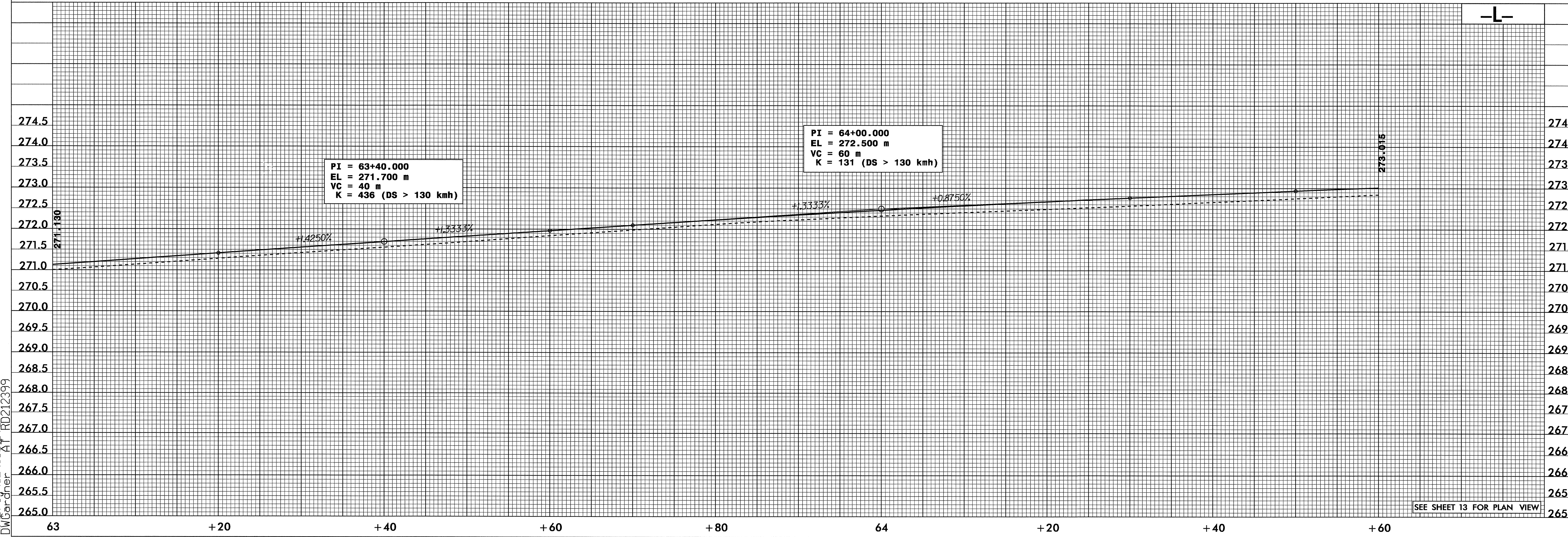
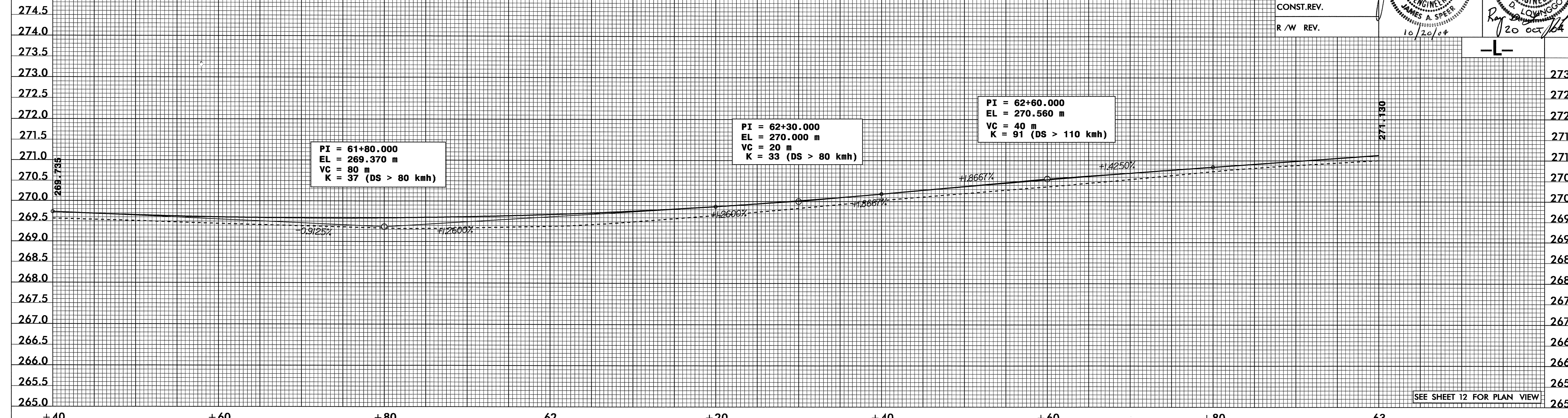

06-AUG-2004 10:32  
R:\proj\2913b\pfl1  
DWGardner At RD212399