

STATE OF NORTH CAROLINA  
DIVISION OF HIGHWAYS

# Guilford County

**LOCATION:** Greensboro - SR 1546 (Guilford College Road) from South of SR 1549 (Mackay Road) to South of SR 1541 (Wendover Avenue)  
**TYPE OF WORK:** Signals

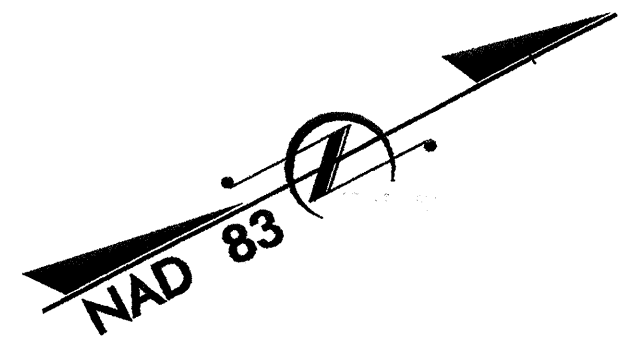

**TIP: U-2913 B**

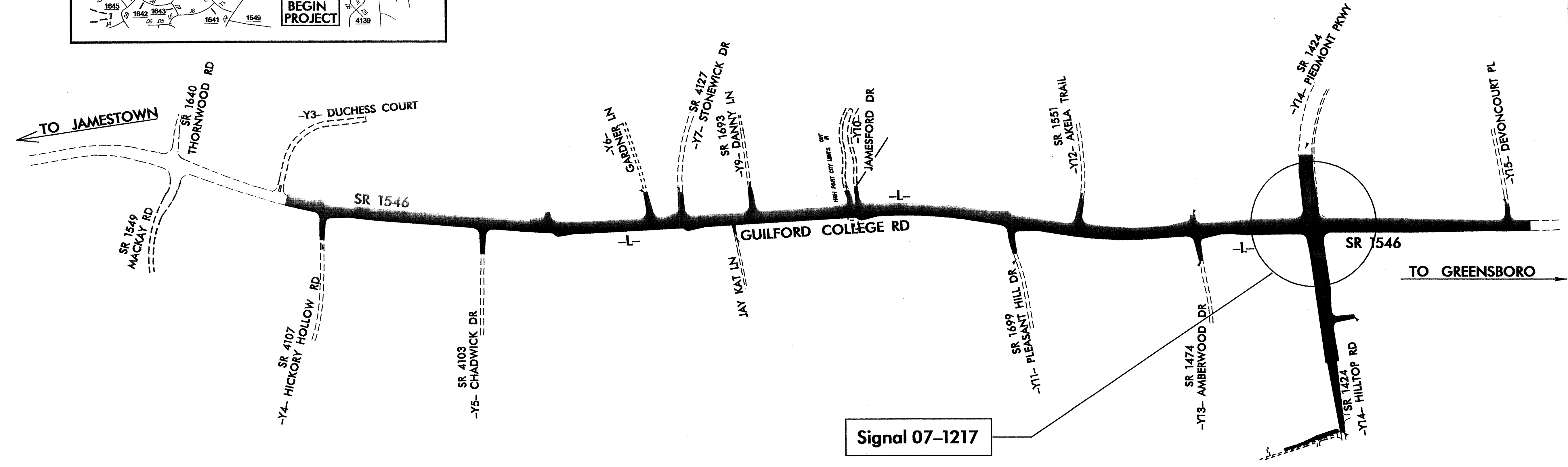
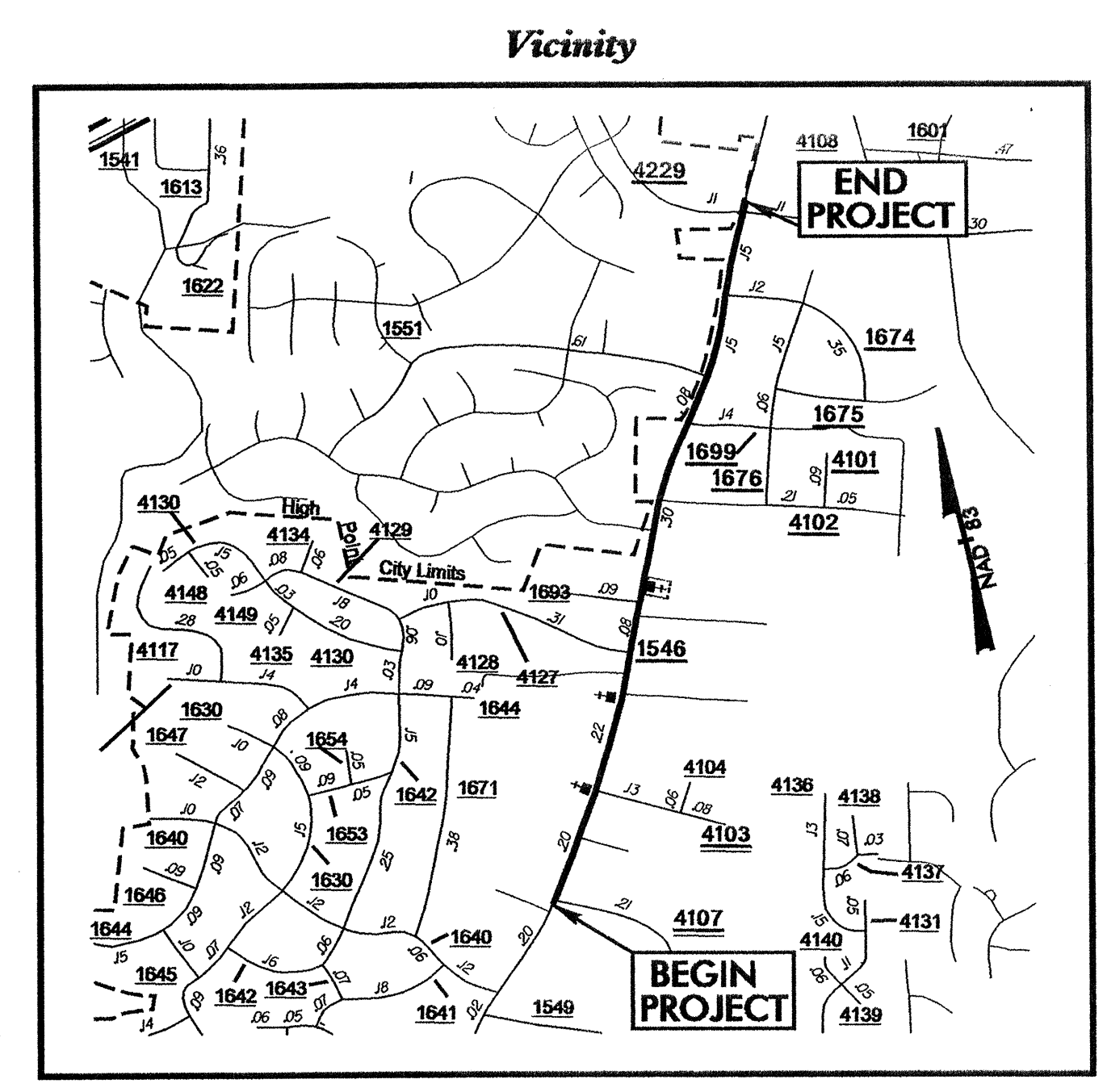

Sheet #	Reference #
Sig. 1	N/A
Sig. 2-6	07-1217
Sig. 7-8	N/A
Sig. 9-11	N/A
Sig. 12-15	N/A

Index of Plans	
	Location/Description
Title Sheet	SR 1546 (Guilford College Road) at SR 1424 (Hilltop Road)/(Piedmont Parkway)
Metal Strain Pole Details	
Standard Plate Drawings	
Communication Cable Routing Plans	

**TRAFFIC MANAGEMENT AND SIGNAL SYSTEMS UNIT**

Contacts:

- D. Y. Ishak - Signals and Geometrics Contracts Engineer
- G. C. Brown, PE - Signal Equipment Design Engineer
- G. G. Murr, Jr., PE - Traffic Management Systems Engineer

Prepared in the Office of:  
**DIVISION OF HIGHWAYS**  
**TRAFFIC ENGINEERING AND SAFETY SYSTEMS**  
**BRANCH**

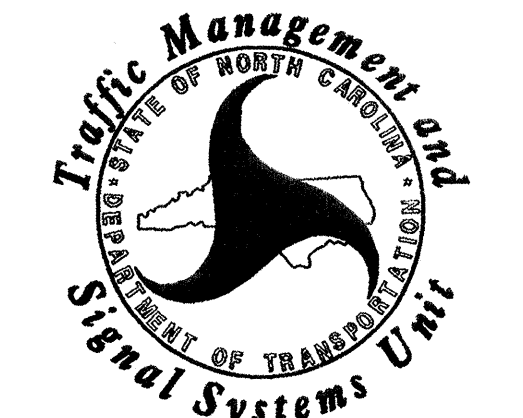

02-SEP-2004 13:52 W:\peoples-unit\workgroups\TIP Projects\U-2913B\T11.tsheet.dgn