

**METRIC**

CONST. REV.  
R/W REV.

PROJECT REFERENCE NO. U-2913B	SHEET NO. EC-37/CONST 18
R/W SHEET NO.	HYDRAULICS ENGINEER
ROADWAY DESIGN ENGINEER	

-L-	-Y15-
PI Sta 71+97.298	PI Sta 10+63.144
$\Delta = 153^\circ 21.7' (LT)$	$D = 10^\circ 23' 17.0' (RT)$
L = 122.009	L = 45.326
T = 61.010	T = 22.726
R = 3,700.000	R = 250.000
SE = SEE PLANS	SE = EXIST.

D.H. GRIFFIN WRECKING CO., INC.  
DB 3576 PG 2142  
6891 SM (DMD)

60

BEGIN CONST.  
-Y15- STA. 10+60.000  
END 750mm C & G  
-Y15- STA. 10+76.000

+70.000 -Y15- @ EXIST. RW  
+75.000 -Y15- @ EXIST. RW

+36.288 -L- 19.000m (62.34')  
+36.288 -L- 16.000m (52.49')

-L- PCSta. 71+36.288

-Y15- PTSta. 10+85.745  
-L- POCSta. 71+59.130 =  
-Y15- POTSta. 11+00.000

END CONSTRUCTION  
-L- STA. 41+15.110  
RETAIN EXISTING RW

MATCH-LINE -L- STA 70+90 SEE SHEET 17

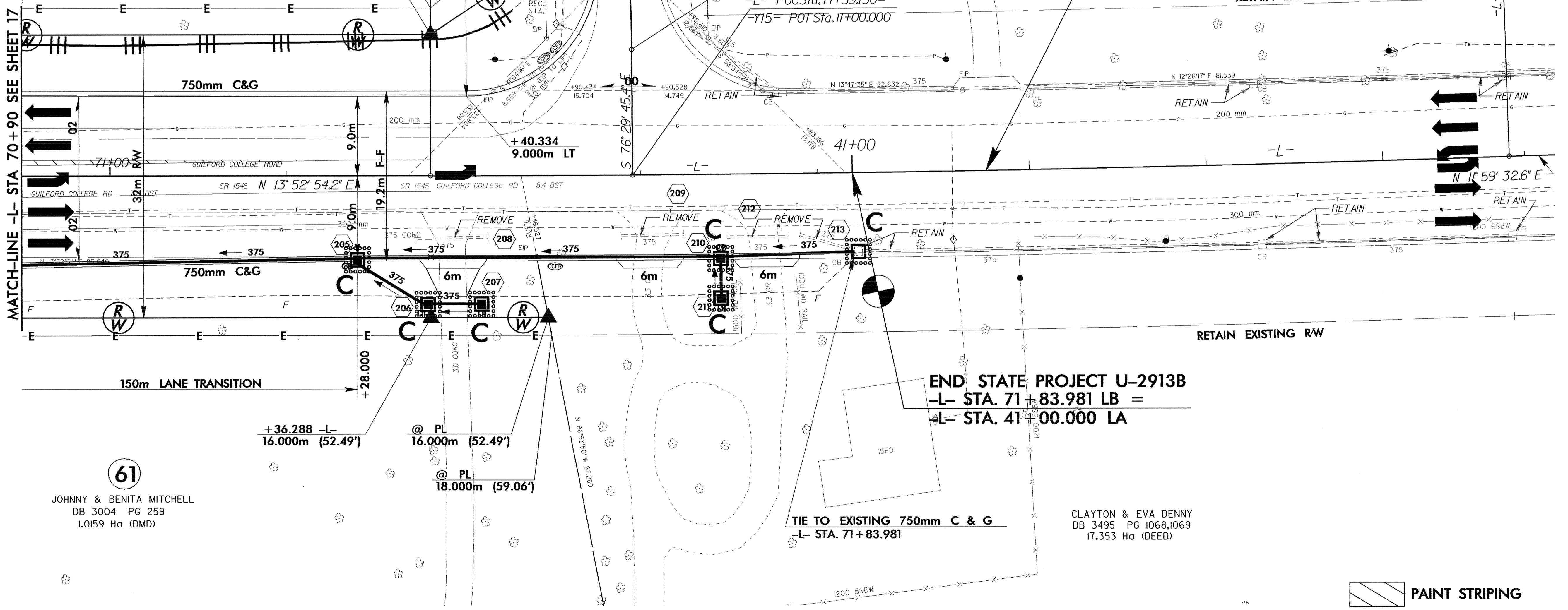

61

JOHNNY & BENITA MITCHELL  
DB 3004 PG 259  
1.0159 Ha (DMD)

@ PL 16.000m (52.49')  
@ PL 18.000m (59.06')

END STATE PROJECT U-2913B  
-L- STA. 71+83.981 LB =  
-L- STA. 41+00.000 LA

TIE TO EXISTING 750mm C & G  
-L- STA. 71+83.981

CLAYTON & EVA DENNY  
DB 3495 PG 1068,1069  
17.353 Ha (DEED)

PAINT STRIPING

SEE SHEET 31 FOR -L- PROFILE  
SEE SHEET 39 FOR -Y15- PROFILE