

INTERSECTION DETAIL

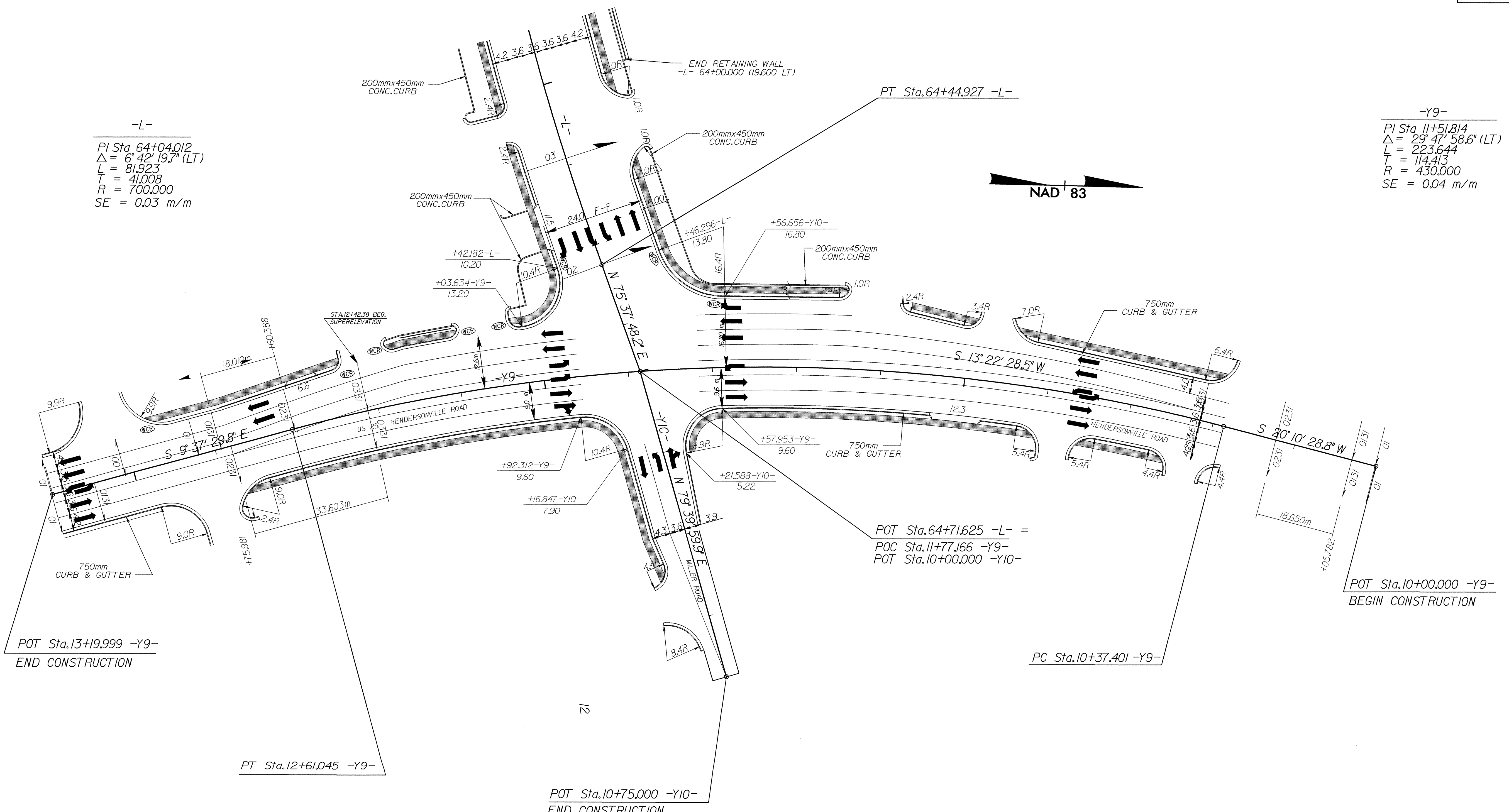

-L-
 PI Sta. 64+04.012
 $\Delta = 6^\circ 42' 19.7" (LT)$
 $L = 81.923$
 $T = 41.008$
 $R = 700.000$
 $SE = 0.03 \text{ m/m}$

-Y9-
 PI Sta. 11+51.814
 $\Delta = 29^\circ 47' 58.6" (LT)$
 $L = 223.644$
 $T = 114.413$
 $R = 430.000$
 $SE = 0.04 \text{ m/m}$

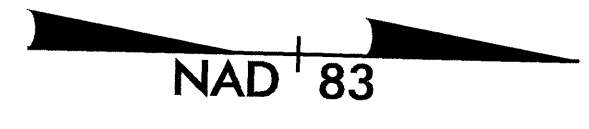

-Y9- , -Y10-

 100mm CONCRETE SIDEWALK
 FOR 200mmX450mm CONCRETE CURB USE 3m MIN. RADIUS

SCALE 1:500

22-DEC-2004 15:09 DETAIL.S.DWG
 MBest