

6/09/08



PROJECT REFERENCE NO. R-2813c SHEET NO. 25

ROADWAY DESIGN ENGINEER HYDRAULICS ENGINEER



CONST. REV.

R / W REV.

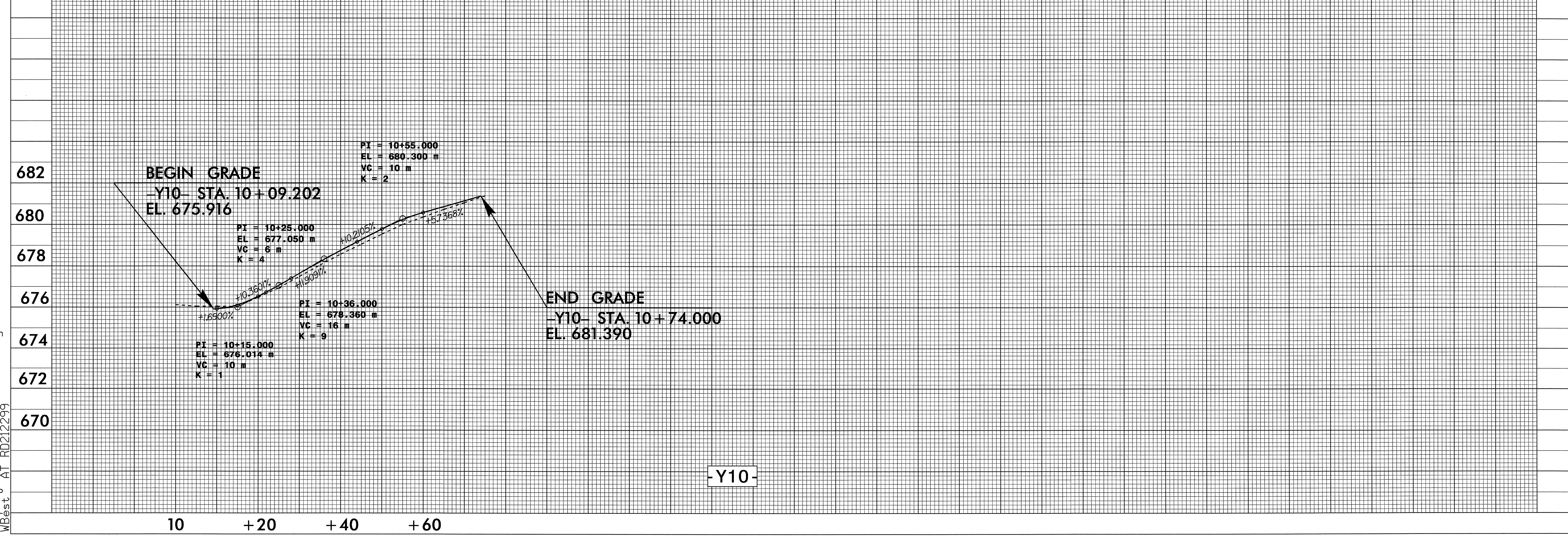
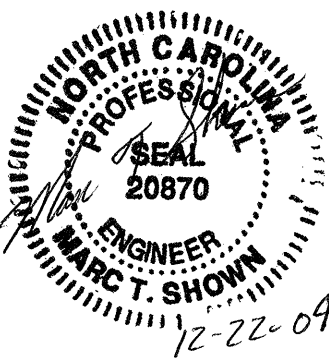

22-DEC-2004 09:38
R:\proj\NR-2813c\RDY_PFL_LREV.dgn
WBest AT RD212299