

**PHASING DIAGRAM**

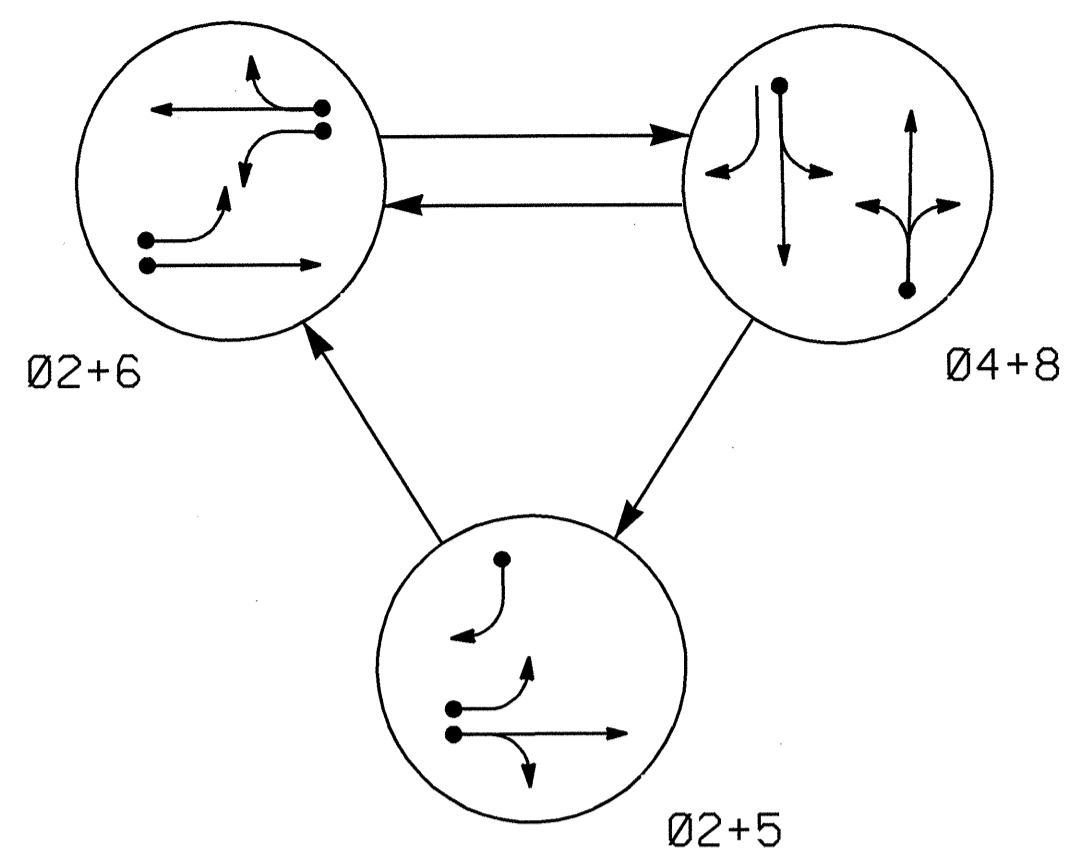

SIGNAL FACE	PHASE			
	02+5	02+6	04+8	02+5
21	G	R	Y	
22	G	R	Y	
41,42	R	G	R	Y
43	R	G	R	Y
61,62	R	G	R	Y
81,82	R	G	R	Y

**PHASING DIAGRAM DETECTION LEGEND**

- DETECTED MOVEMENT
- UNDETECTED MOVEMENT (OVERLAP)
- UNSIGNALIZED MOVEMENT
- PEDESTRIAN MOVEMENT

**SIGNAL FACE I.D.**

Denotes L.E.D.

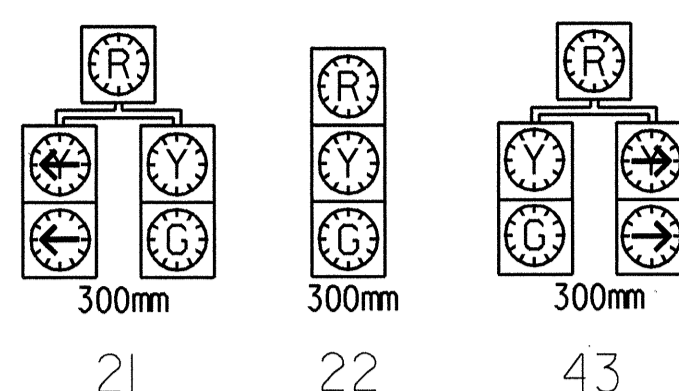

**2070L LOOP & DETECTOR INSTALLATION**

LOOP	SIZE (M)	TURNS	DISTANCE FROM STOPBAR (M)	NEW LOOP	PHASE	DETECTOR PROGRAMMING					
						CALLING EXTENSION	FULL TIME DELAY	SYSTEM LOOP	STRETCH TIME		
2A	1.8X1.8	4	21	Y	2	Y	Y	-	-	-	-
4A	1.8X1.8	2-4-2	0	Y	4	Y	Y	-	-	3	-
5A	1.8X1.8	2-4-2	0	Y	5	Y	Y	-	-	15	-
5B	1.8X1.8	2-4-2	0	Y	5	Y	Y	-	-	15	-
6A	1.8X1.8	4	21	Y	6	Y	Y	-	-	-	-
6B	1.8X1.8	4	0	Y	6	Y	Y	-	-	-	-
8A	1.8X1.8	2-4-2	0	Y	8	Y	Y	-	-	3	-
8B	1.8X4.5	4	0	Y	8	Y	Y	-	-	10	-

**3 Phase Actuated  
(Isolated)**

**NOTES**

- REFER TO "ROADWAY STANDARD DRAWINGS NCDOT", DATED JANUARY 2002 AND "STANDARD SPECIFICATIONS FOR ROADS AND STRUCTURES" DATED JANUARY 2002.
- REPOSITION EXISTING SIGNAL HEADS NUMBERED 21,22,61 AND 62.
- OMIT PHASE 5 DURING PHASE 6 ON.
- PROGRAM CONTROLLER TO CLEAR FROM PHASE 2+6 TO PHASE 2+5 BY PROGRESSING THROUGH PHASE 4+8 (SEE ELECTRICAL DETAILS)
- SET ALL DETECTOR UNITS TO PRESENCE MODE.

**PLAN QUANTITIES**

Pay Item	Meters
Signal Cable	—
Messenger Cable	—
Lead-in Cable	545

FEATURE	PHASE				
	2	4	5	6	8
Min Green 1*	12	7	7	12	7
Extension 1*	3	2	1	3	2
Max Green 1*	60	25	30	60	25
Yellow Clearance	4.0	4.0	4.0	4.0	4.0
Red Clearance	1.5	2.5	1.5	1.5	2.5
Walk 1*	-	-	-	-	-
Don't Walk 1	-	-	-	-	-
Seconds Per Actuation*	-	-	-	-	-
Max Variable Initial*	-	-	-	-	-
Time Before Reduction*	-	-	-	-	-
Time To Reduce*	-	-	-	-	-
Minimum Gap	-	-	-	-	-
Recall Mode	MIN RECALL	-	-	MIN RECALL	-
Vehicle Call Memory	YELLOW	-	-	YELLOW	-
Dual Entry	-	ON	-	-	ON
Simultaneous Gap	ON	ON	ON	ON	ON

\* These values may be field adjusted. Do not adjust Min Green and Extension times for phases 2 and 6 lower than what is shown. Min Green for all other phases should not be lower than 4 seconds.

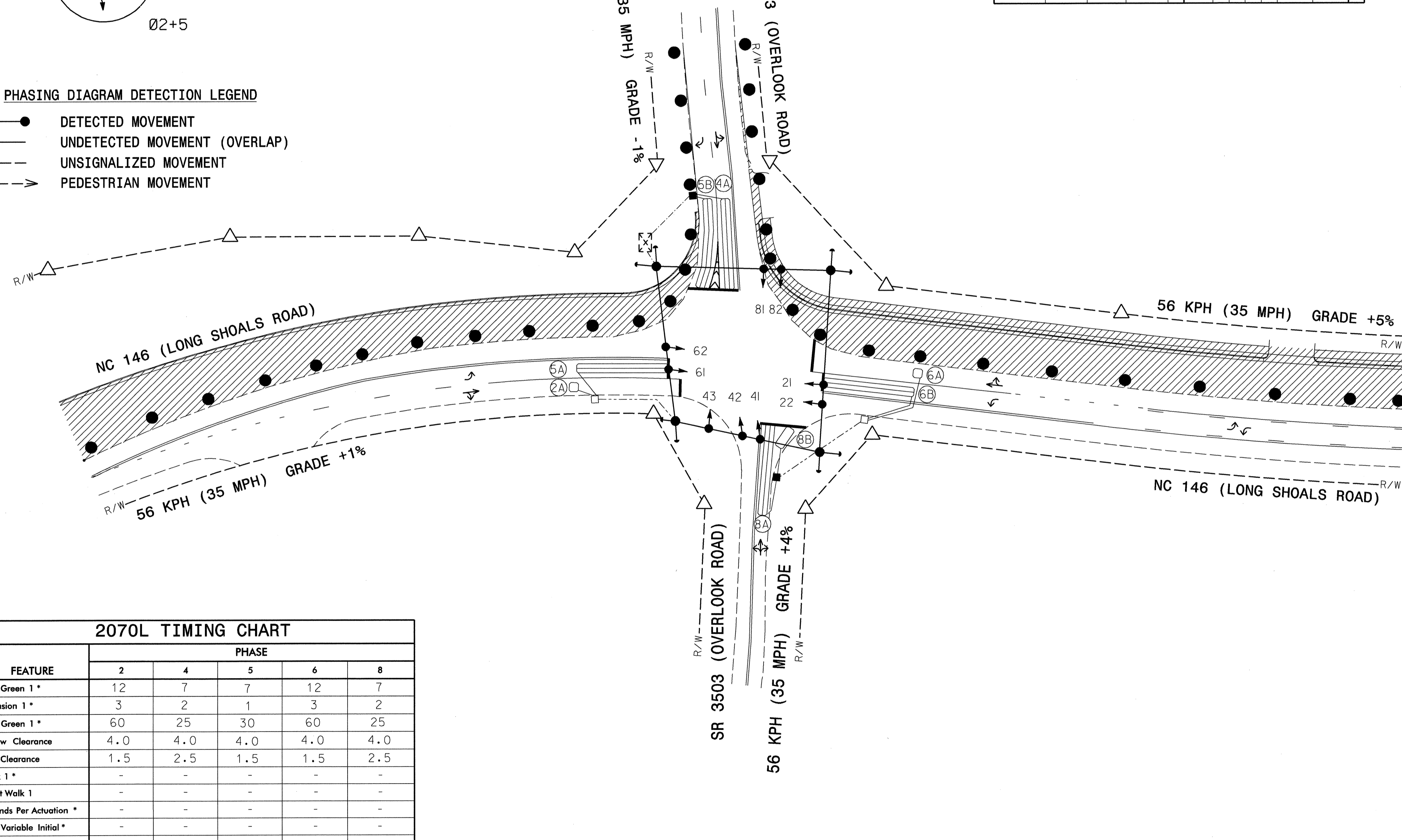

**LEGEND**

- | PROPOSED |                                     | EXISTING |
|----------|-------------------------------------|----------|
|          | Traffic Signal Head                 |          |
|          | Modified Signal Head                | N/A      |
|          | Sign                                |          |
|          | Pedestrian Signal Head              |          |
|          | Signal Pole with Push Button & Sign |          |
|          | Signal Pole with Guy                |          |
|          | Signal Pole with Sidewalk Guy       |          |
|          | Inductive Loop Detector             |          |
|          | Controller & Cabinet                |          |
|          | Junction Box                        |          |
|          | 50mm Underground Conduit            |          |
|          | Right of Way with Marker            |          |
|          | Directional Arrow                   |          |
|          | Construction Zone                   |          |
|          | Construction Barrels                |          |

TEMPORARY SIGNAL 2 - PHASE II TCP 21

 <b>PLANS PREPARED BY :</b> <b>RUMMEL KLEPPER &amp; KAHL, LLP</b> <i>consulting engineers</i> 5800 FARINGDON PLACE SUITE 105 RALEIGH, NORTH CAROLINA 27609-3960  <b>FOR</b> <b>DIVISION OF HIGHWAYS</b>	Prepared for the Offices of:  DEPARTMENT OF TRANSPORTATION Traffic Engineering and Safety Section Signal and Geometrics Section 122 N. McDowell St., Raleigh, NC 27603 SCALE 5 0 10 1 : 500	NC 146 (LONG SHOALS ROAD) AT SR 3503 (OVERLOOK ROAD) DIVISION 13 BUNCOMBE COUNTY ASHEVILLE PLAN DATE: 02-06-04 REVIEWED BY: D. MORTON PREPARED BY: J. COLE RK&K PROJECT NO. 302-079-SIG4 REVISIONS INIT. DATE _____ _____ _____	SEAL  DONALD W. MORTON ENGINEER 2-26-04 DATE SIG. INVENTORY NO. 13-044472
---	---	--	---