

PROJECT REFERENCE NO.	SHEET NO.
R-2813C	EC-3/CONST.4
R/W SHEET NO.	4
ROADWAY DESIGN ENGINEER	HYDRAULICS ENGINEER
CONST. REV.	
R/W REV.	

DATUM DESCRIPTION

THE LOCALIZED COORDINATE SYSTEM DEVELOPED FOR THIS PROJECT IS BASED ON THE STATE PLANE COORDINATES ESTABLISHED BY NCDOT FOR MONUMENT "R2813C-10" WITH NAD 83 STATE PLANE GRID COORDINATES OF NORTHING: 197,916.503 (m) EASTING: 286,973.960 (m)

THE AVERAGE COMBINED GRID FACTOR USED ON THIS PROJECT (GROUND TO GRID) IS 0.999784950

THE N.C. LAMBERT GRID BEARING LOCALIZED HORIZONTAL GROUND DISTANCE FROM "R2813C-10" TO -L- STATION 35+00.000 IS : S 20° 03' 58.73" E AND 13.634 m

ALL LINEAR DIMENSIONS ARE LOCALIZED HORIZONTAL DISTANCES VERTICAL DATUM USED IS NGVD 29

NOTE:
PLACE TEMPORARY ROCK SEDIMENT DAMS TYPE- B AND TEMPORARY ROCK SILT CHECKS TYPE-A AT DRAINAGE OUTLETS.

CLEARING AND GRUBBING EROSION CONTROL FOR CONSTRUCTION SHEET 4

PI Sta. 36+92.290
 $\Delta = 39^{\circ} 00' 00.9" (RT)$
 L = 313.114
 T = 162.896
 R = 460.000

PI Sta. 36+96.294
 $\Delta = 39^{\circ} 00' 00.8" (RT)$
 L = 308.175
 T = 160.326
 R = 452.743
 $e = 0.06 \text{ m/m}$
 RO =

-RP A-
 PIs Sta. 10+51.544
 $\Delta = 5^{\circ} 32' 55.9"$
 Ls = 45.720
 LT = 30.495
 ST = 15.254

STSta. 10+66.769 -RP A-

BEGIN PAVING
 -RP A- STA. 10+39.515

R2813C 10
 -LBL- POT 5+00.000 =
 -L- POT 34+98.118 (13.503 Lt.)
 TSSta. 10+21.049 -RP A-
 BEGIN PAVING
 -L- STA. 35+56.859
 PCSta. 35+29.394 -L-

-YBL- 209
 RP 'A'-BL- POT 5+00.000 =
 RP 'A' POS 10+52.825 (11.257 RP)

-LBL- 208
 -LBL- P/C 6+12.745 =
 RP 'A'-BL- POT 5+68.071 =
 RP 'B'-BL- POT 5+00.000 =
 -L- P/C 36+09.347 (4.473 Lt.)

BILTMORE COMMERCIAL PROPERTIES, LLC
 DB 1222 PGS. 645-669
 DB 1776 PG 644,645

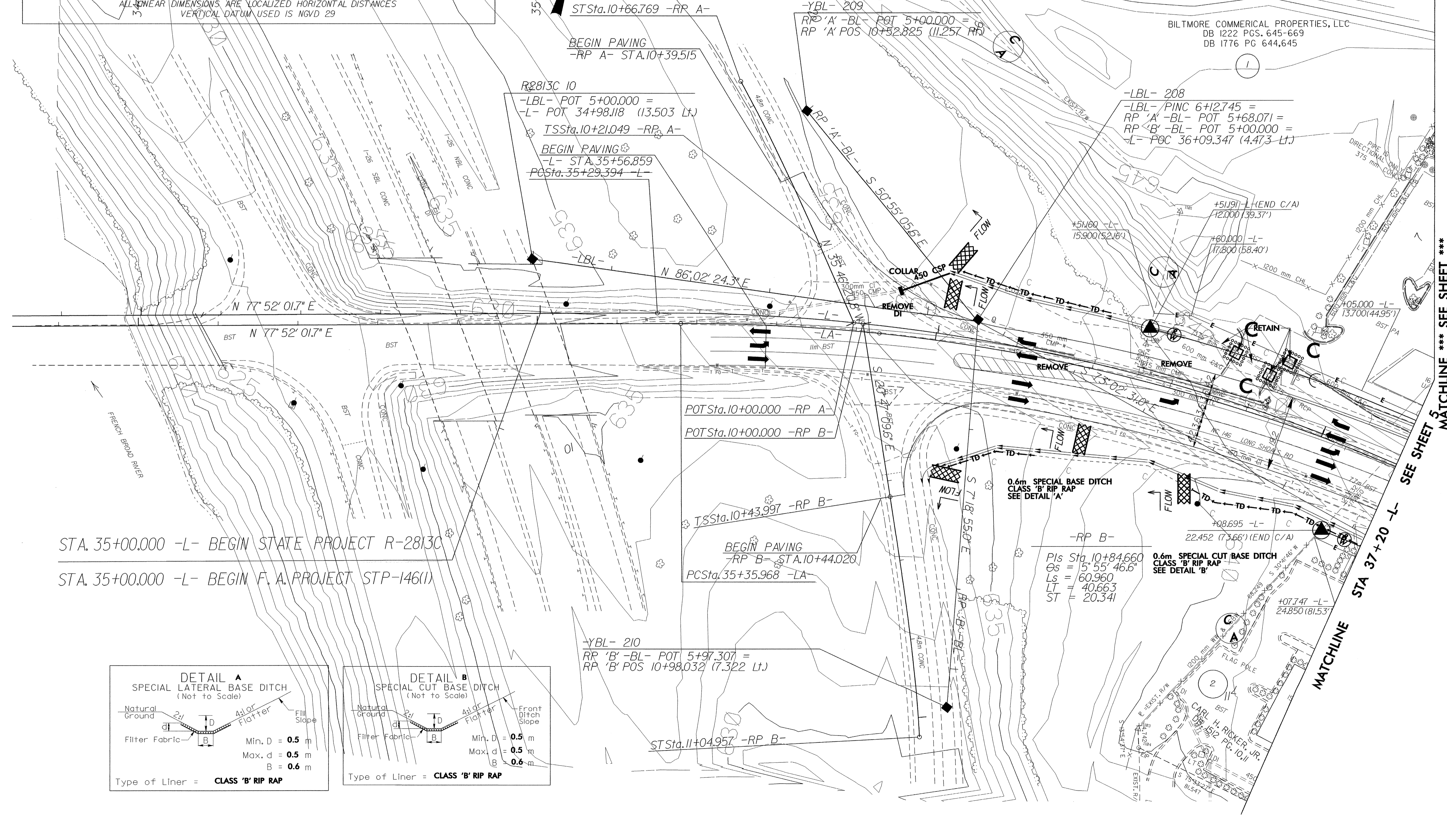

STA. 35+00.000 -L- BEGIN STATE PROJECT R-2813C
 STA. 35+00.000 -L- BEGIN F. A. PROJECT STP-146(1)

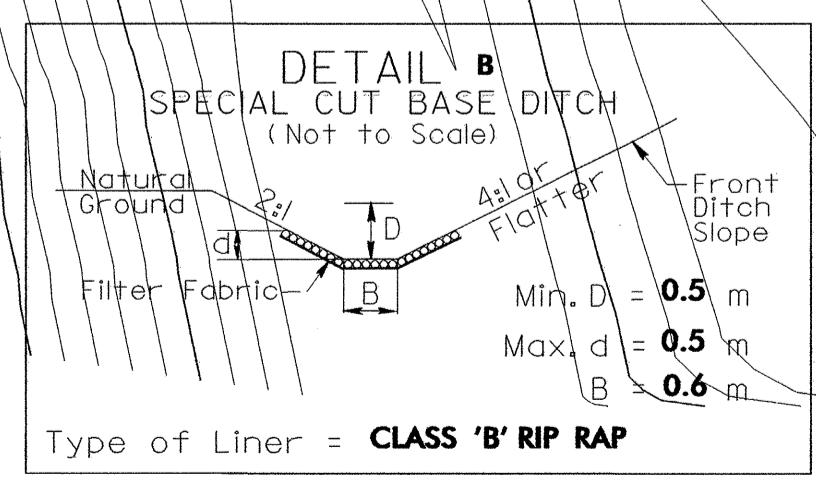
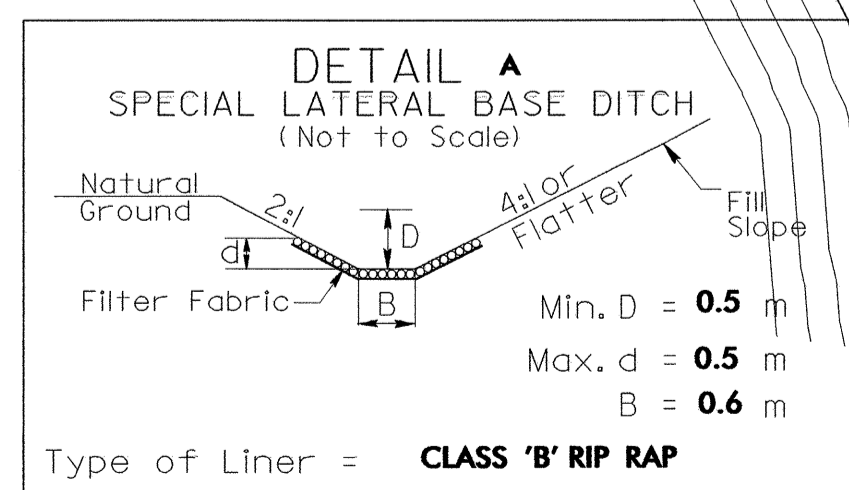

*** SEE SHEET 5 MATCHLINE ***

STA 37+20 -L- MATCHLINE