	PROJECT REFERENCE NO.	SHEET NO.
	R-2813C	EC-14/CONST.4
	R/W SHEET NO.	4
ROADWAY DESIGN ENGINEER	HYDRAULICS ENGINEER	
CONST. REV.		
R/W REV.		

**DATUM DESCRIPTION**

THE LOCALIZED COORDINATE SYSTEM DEVELOPED FOR THIS PROJECT IS BASED ON THE STATE PLANE COORDINATES ESTABLISHED BY NCDOT FOR MONUMENT "R2813C-10" WITH NAD 83 STATE PLANE GRID COORDINATES OF NORTHING: 197,916,503 (m) EASTING: 286,973,960 (m)

THE AVERAGE COMBINED GRID FACTOR USED ON THIS PROJECT (GROUND TO GRID) IS 0.999784950

THE N.C. LAMBERT GRID BEARING LOCALIZED HORIZONTAL GROUND DISTANCE FROM "R2813C-10" TO "L- STATION 35+00.00" IS : S 20° 03' 58.73" E AND 13.634 m

ALL LINEAR DIMENSIONS ARE LOCALIZED HORIZONTAL DISTANCES VERTICAL DATUM USED IS NGVD 29

-L-  
 PI Sta. 36+92.290  
 $\Delta = 39^{\circ} 00' 00.9" (RT)$   
 L = 313.114  
 T = 162.896  
 R = 460.000

-LA-  
 PI Sta. 36+96.294  
 $\Delta = 39^{\circ} 00' 00.8" (RT)$   
 L = 308.175  
 T = 160.326  
 R = 452.743  
 e = 0.06 m/m  
 RO =

-RP A-  
 PIs Sta. 10+51.544  
 $\Theta_s = 5^{\circ} 32' 55.9"$   
 Ls = 45.720  
 LT = 30.495  
 ST = 15.254

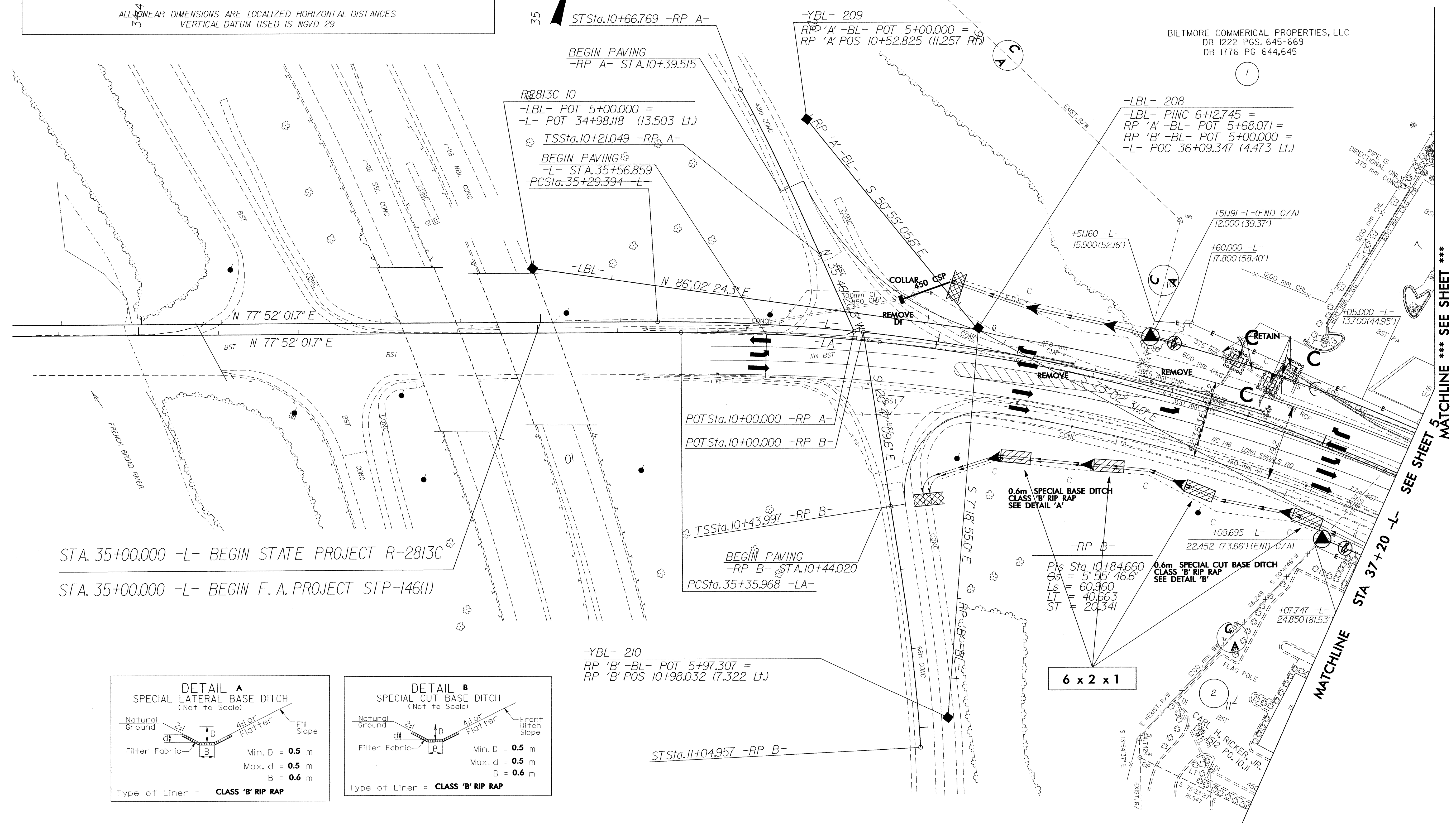

STA. 35+00.000 -L- BEGIN STATE PROJECT R-2813C  
 STA. 35+00.000 -L- BEGIN F. A. PROJECT STP-146(1)

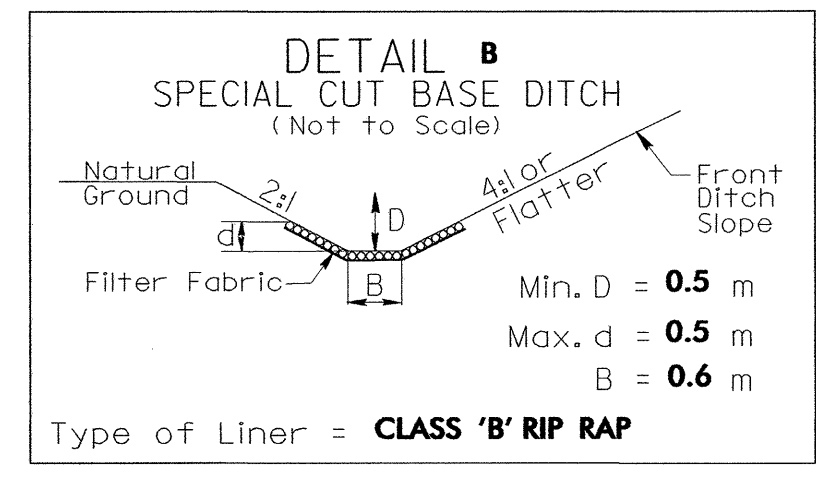
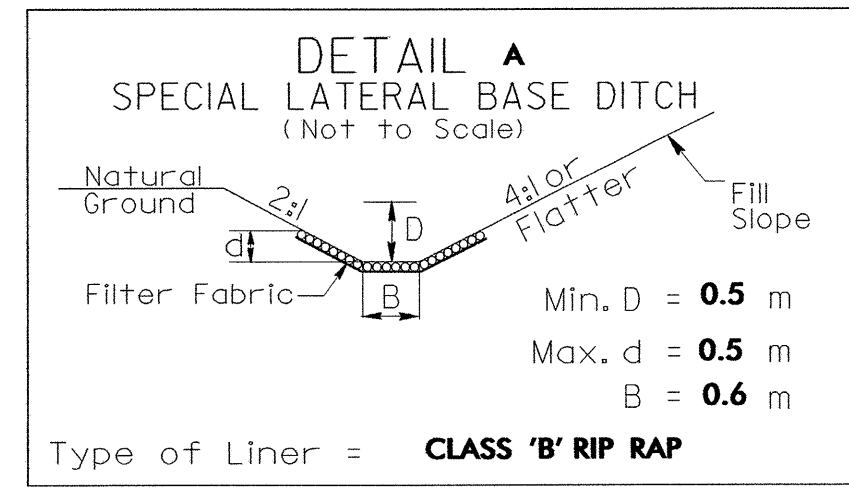

-YBL- 210  
 RP 'B'-BL- POT 5+97.307 =  
 RP 'B' POS 10+98.032 (7.322 Lt.)

STSta. 11+04.957 -RP B-

6 x 2 x 1

MATCHLINE \*\*\* SEE SHEET 5 \*\*\*

MATCHLINE

BILTMORE COMMERCIAL PROPERTIES, LLC  
 DB 1222 PGS. 645-669  
 DB 1776 PG 644,645