

FOR PROFILE OF -L- SEE SHEETS NO. 15 & 16
 FOR PROFILE OF -YI- SEE SHEET NO. 23
 FOR INTERSECTION DETAIL OF -YI- SEE SHEET NO. 2-E

METRIC

5 0 10

CONST. REV.
 R/W REV.

PROJECT REFERENCE NO.	SHEET NO.
R-2813C	EC-16/CONST.6
R/W SHEET NO.	6
ROADWAY DESIGN ENGINEER	HYDRAULICS ENGINEER

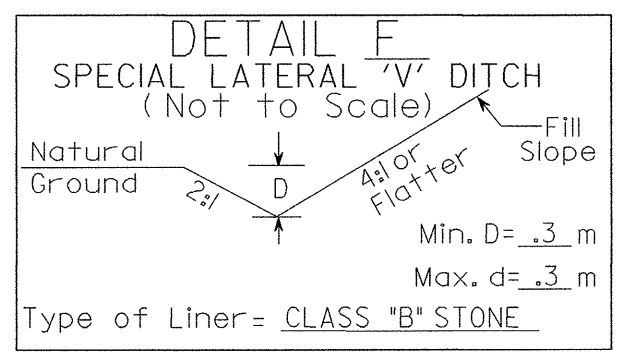

THE FOREST AT ASHEVILLE PROPERTIES, LLC.
 DB 2077 PG 484

FROM STA 10+24 TO STA 10+60 -YI- LT

BILTMORE COMMERCIAL PROPERTIES, LLC
 DB 1222 PGS. 645-669
 DB 1776 PG 644,645

MATCHLINE STA. 40+60 -L- SEE SHEET 5

MATCHLINE STA. 44+00 -L- SEE SHEET 7

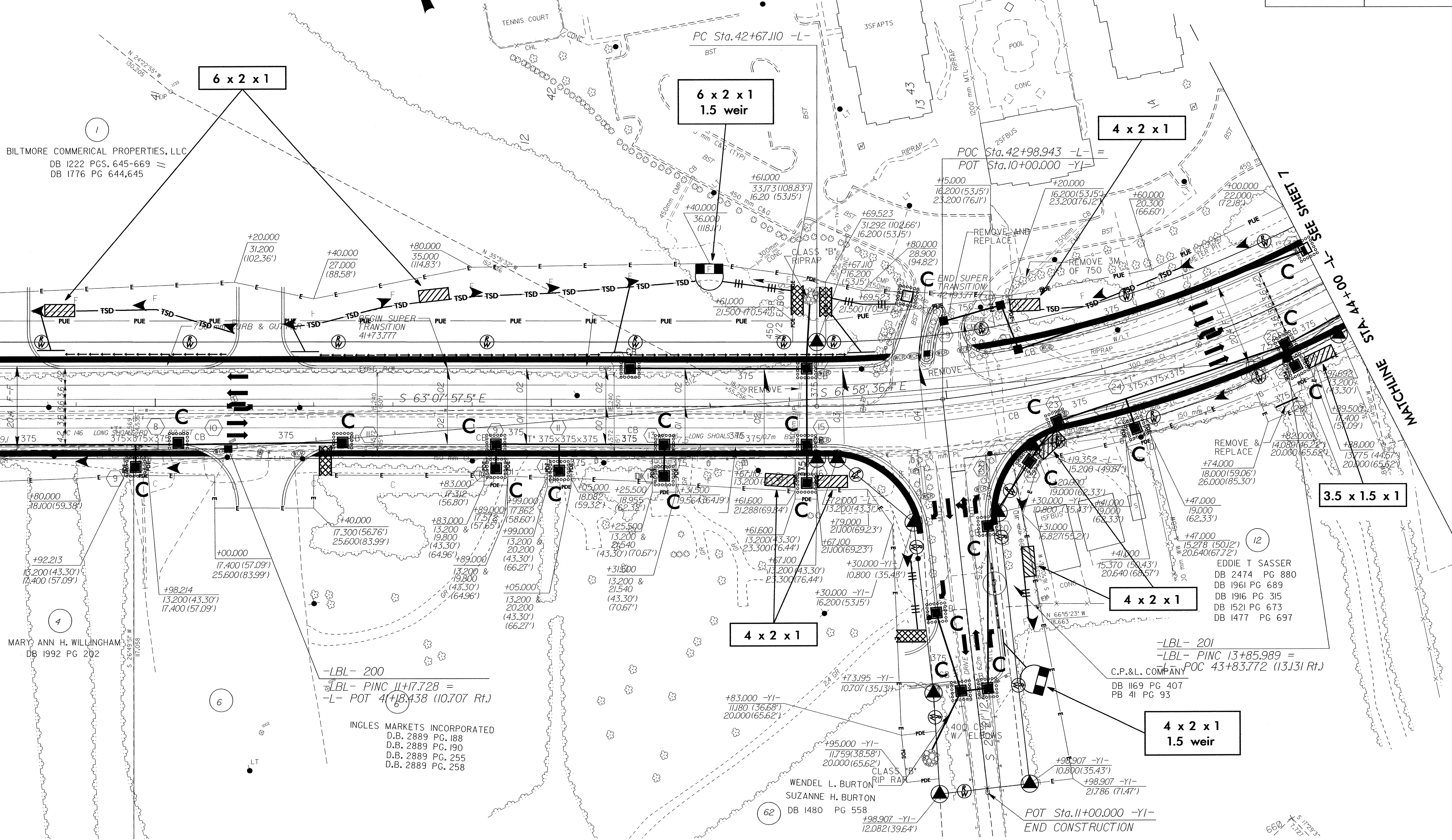

MARY ANN H. WILLINGHAM
 DB 1992 PG 202

INGLES MARKETS INCORPORATED
 D.B. 2889 PG. 188
 D.B. 2889 PG. 190
 D.B. 2889 PG. 255
 D.B. 2889 PG. 258

WENDEL L. BURTON
 SUZANNE H. BURTON
 DB 1480 PG 558

EDDIE T. SASSER
 DB 2474 PG 880
 DB 1961 PG 689
 DB 1916 PG 315
 DB 1521 PG 673
 DB 1477 PG 697

-LBL- 201
 -LBL- PINC 13+85.989 =
 -L- POT 43+83.772 (13.131 Rt.)
 C.P. & L. COMPANY
 DB 1169 PG 407
 PB 41 PG 93

POT Sta. 11+00.000 -YI-
 END CONSTRUCTION