

5/28/99

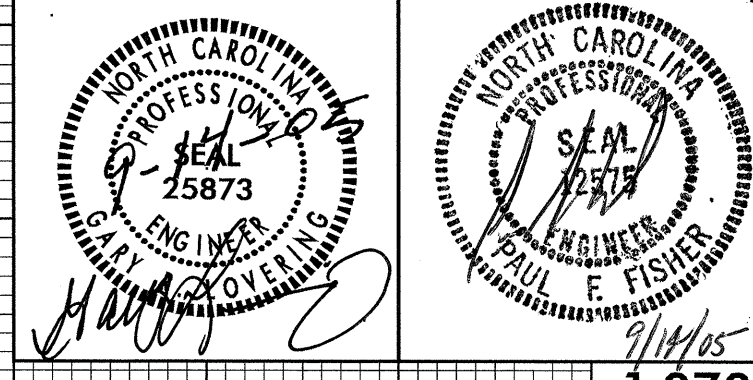

*DESIGN EXCEPTION REQUIRED FOR DESIGN SPEED (35 mph), MINIMUM HORIZONTAL CURVE RADIUS (300') AND HORIZONTAL STOPPING SIGHT DISTANCE (165')

FOR -L- ALIGNMENT SEE SHEETS 4 & 5

BM #2: 8" NAIL IN BASE OF 14" POPLAR -L- STA. 14+73.36 9.84' RT. ELEV. 1022.75'

PI = 12+00.00
EL = 1,043.04'
VC = 200'
*K = 55

PI = 15+00.00
EL = 1,037.00'
VC = 246'
*K = 50

PI = 20+20.00
EL = 1,052.00'
VC = 350'
*K = 58

DITCH LEGEND
LEFT DITCH
RIGHT DITCH

BRIDGE HYDRAULIC DATA

DESIGN DISCHARGE	= 1800 CFS
DESIGN FREQUENCY	= 25 YRS
DESIGN HW ELEVATION	= 1015.20 FT
BASE DISCHARGE	= 2600 CFS
BASE FREQUENCY	= 100 YRS
BASE HW ELEVATION	= 1016.74 FT
OVERTOPPING DISCHARGE	= 4000 CFS
OVERTOPPING FREQUENCY	= 500 YRS
OVERTOPPING ELEVATION	= 1039.18 FT

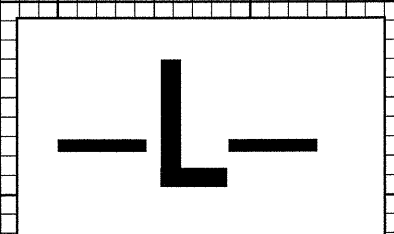
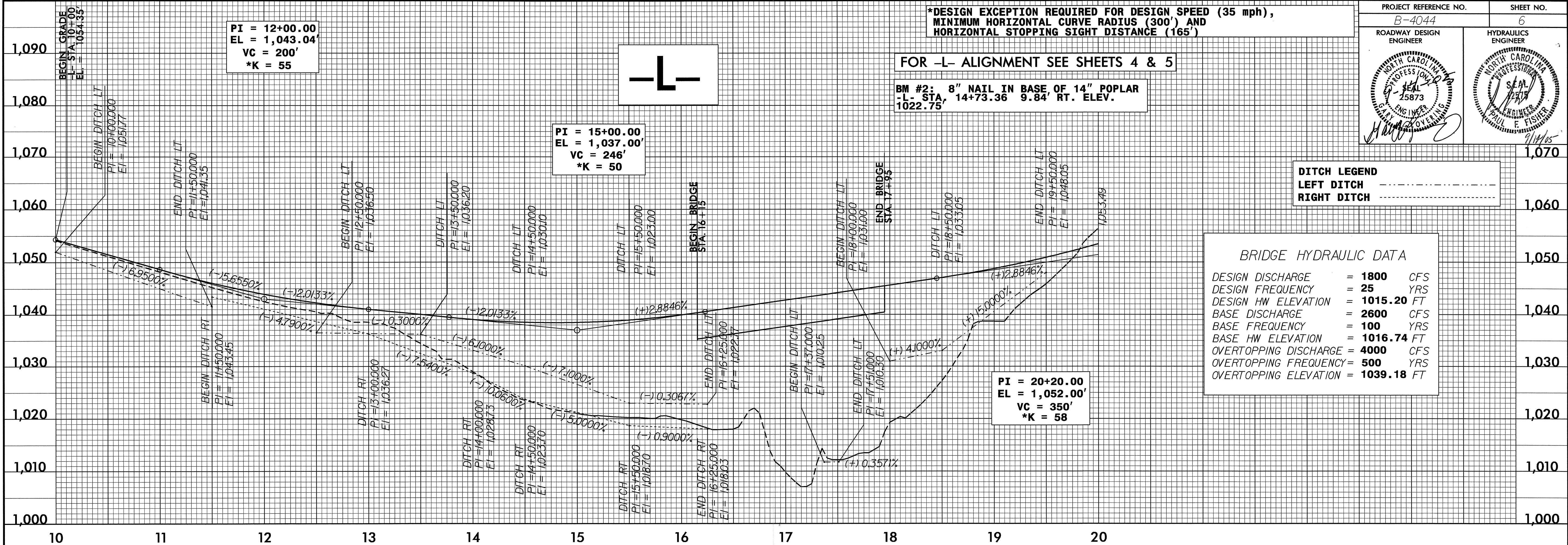

BM#3: 8" NAIL ON BASE OF 22" POPLAR -L- STA. 27+09.21 52.02 RT. ELEV. 1126.94'

PI = 20+20.00
EL = 1,052.00'
VC = 350'
*K = 58

PI = 25+10.00
EL = 1,095.67'
VC = 90'
*K = 50

PI = 26+00.00
EL = 1,102.09'
VC = 40'
*K = 59

PI = 27+00.00
EL = 1,109.90'
VC = 50'
*K = 73

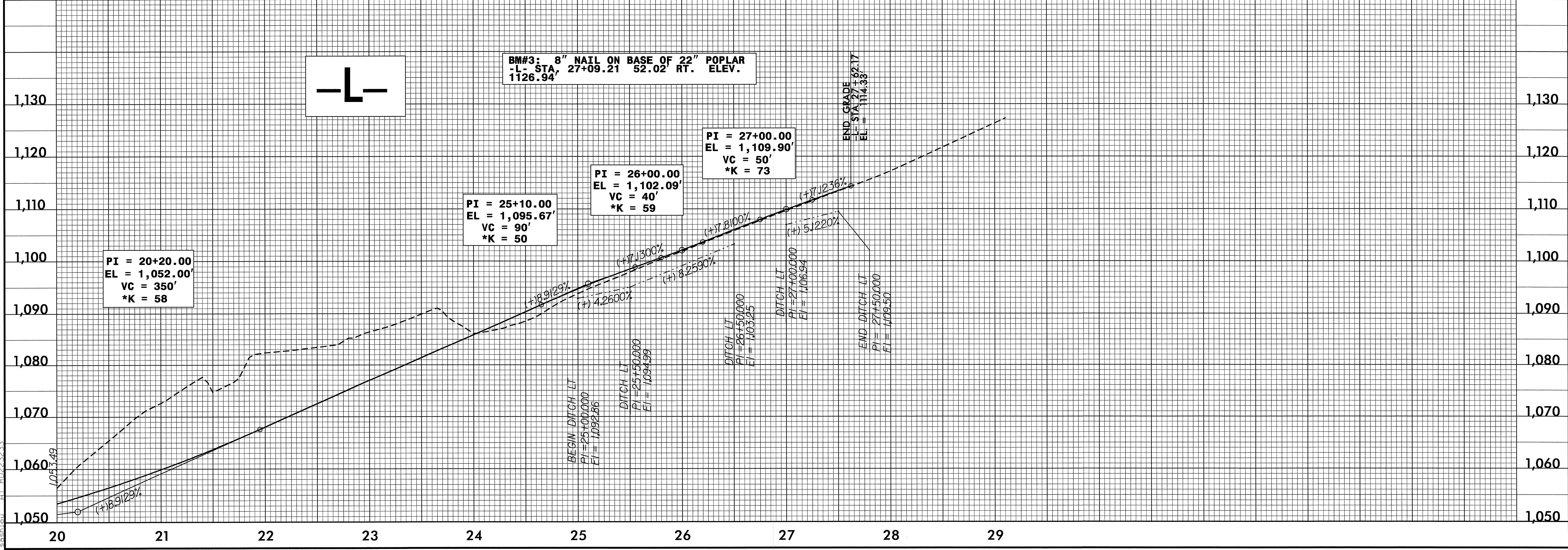

07-SEP-2005 08:16 B4044_RDY_PFL.DGN