

SURVEY CONTROL SHEET B-3857

PROJECT REFERENCE NO. B-3857	SHEET NO. I-C
LOCATION AND SURVEYS	

NOTES

I. THE CONTROL DATA FOR THIS PROJECT CAN BE FOUND ELECTRONICALLY BY SELECTING PROJECT CONTROL DATA AT:

HTTP://WWW.DOH.DOT.STATE.NC.US/PRECONSTRUCT/HIGHWAY/LOCATION/PROJECT/
FILE: B3857_LS_CONTROL_040308.TXT

SITE CALIBRATION INFORMATION HAS NOT BEEN PROVIDED FOR THIS PROJECT. IF FURTHER INFORMATION IS NEEDED, PLEASE CONTACT THE LOCATION AND SURVEYS UNIT.

BL POINT	DESC.	NORTH	EAST	ELEVATION	L STATION	OFFSET
1	BL-1	609824.2450	942008.8550	2086.75	OUTSIDE PROJECT LIMITS	
2	BL-2	610121.1400	942143.2060	2081.70	12+74.19	11.00 RT
3	BL-3	610524.0140	942290.4870	2062.79	16+90.95	69.19 LT
4	BL-4	610754.7270	942591.4580	2062.22	20+57.59	9.63 RT
5	BL-5	611061.7450	942918.2320	2069.31	OUTSIDE PROJECT LIMITS	

BY POINT	DESC.	NORTH	EAST	ELEVATION	L STATION	OFFSET
6	BY-6	611099.7750	942563.2090	2064.02	22+78.52	256.89 LT
55	BL-5	611061.7450	942918.2320	2069.30	OUTSIDE PROJECT LIMITS	

.....
 BM1 ELEVATION = 2095.18
 N 609849 E 941972
 L STATION 10+00
 S 58° 50' 38.4" W DIST 53.86
 8" SPIKE IN 12" MAPLE

.....
 BM2 ELEVATION = 2071.85
 N 610431 E 942213
 L STATION 15+74 81 LEFT
 8" SPIKE IN ROOT OF 14" MAPLE

.....
 BM3 ELEVATION = 2072.14
 N 611222 E 943323
 L STATION 23+76
 N 65° 01' 47.6" E DIST 563.39
 CHISEL "X" IN CONCRETE BASE OF TRAFFIC LIGHT BOX

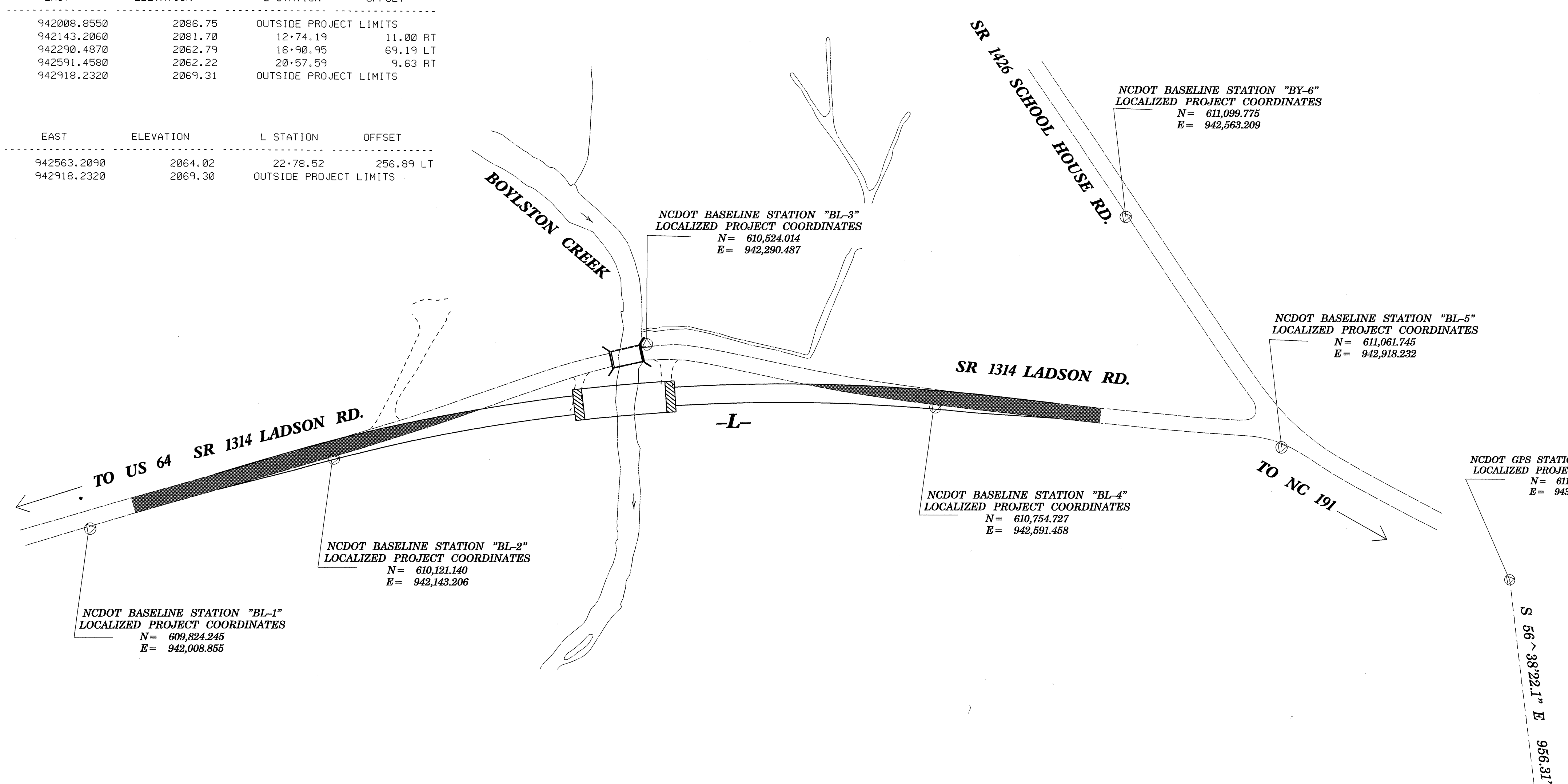

DATUM DESCRIPTION

THE LOCALIZED COORDINATE SYSTEM DEVELOPED FOR THIS PROJECT IS BASED ON THE STATE PLANE COORDINATES ESTABLISHED BY NCDOT FOR MONUMENT "B3857-GPS101" WITH NAD 83 STATE PLANE GRID COORDINATES OF NORTHING: 611177.141(ft) EASTING: 944034.495(ft) THE AVERAGE COMBINED GRID FACTOR USED ON THIS PROJECT (GROUND TO GRID) IS: 0.999775971 THE N.C. LAMBERT GRID BEARING AND LOCALIZED HORIZONTAL GROUND DISTANCE FROM "B3857-GPS101" TO -L- STATION 10+00.00 IS S 57°10'46.0" W 2398.94' ALL LINEAR DIMENSIONS ARE LOCALIZED HORIZONTAL DISTANCES VERTICAL DATUM USED IS NGVD 29

⊙ INDICATES GEODETIC CONTROL MONUMENTS USED OR SET FOR HORIZONTAL PROJECT CONTROL BY THE NCDOT LOCATION AND SURVEYS UNIT.
 PROJECT CONTROL ESTABLISHED USING GLOBAL POSITIONING SYSTEM.
 NETWORK ESTABLISHED FROM NGS ONLINE POSITIONING USER SERVICE (OPUS)

NOTE: DRAWING NOT TO SCALE