

GENERAL NOTES

ADAPT THE TRAFFIC CONTROL PLANS, WHEN DIRECTED BY THE ENGINEER, TO MEET FIELD CONDITIONS TO PROVIDE SAFE AND EFFICIENT TRAFFIC MOVEMENT. CHANGES MAY BE REQUIRED WHEN PHYSICAL DIMENSIONS IN THE DETAIL DRAWINGS, STANDARD DETAILS AND ROADWAY DETAILS ARE NOT ATTAINABLE, OR RESULT IN DUPLICATE, OR UNDESIRABLE OVERLAPPING OF DEVICES. MODIFICATION MAY INCLUDE: MOVING, SUPPLEMENTING, COVERING OR REMOVAL OF DEVICES.

THE FOLLOWING GENERAL NOTES APPLY AT ALL TIMES FOR THE DURATION OF THE CONSTRUCTION PROJECT, EXCEPT WHEN OTHERWISE NOTED IN THE PLAN, OR DIRECTED BY THE ENGINEER.

TRAFFIC PATTERN ALTERATIONS

- A) NOTIFY THE ENGINEER 21 CALENDAR DAYS PRIOR TO ANY TRAFFIC PATTERN ALTERATION.

SIGNING

- B) PROVIDE PERMANENT SIGNING.
 C) PROVIDE DETOUR SIGNING OFF THE PROJECT LIMITS.
 D) COVER OR REMOVE ALL DETOUR SIGNS OFF THE PROJECT LIMITS, WHEN A DETOUR IS NOT IN OPERATION.
 E) ENSURE ALL NECESSARY SIGNING IS IN PLACE PRIOR TO ALTERING ANY TRAFFIC PATTERN.

TRAFFIC CONTROL DEVICES

- F) PLACE TYPE III BARRICADES, WITH "ROAD CLOSED" SIGN (R11-2) ATTACHED, OF SUFFICIENT LENGTH TO CLOSE ENTIRE ROADWAY. STAGGER OR OVERLAP BARRICADES TO ALLOW FOR INGRESS OR EGRESS.

PAVEMENT MARKING AND MARKERS

- G) INSTALL PAVEMENT MARKINGS AND PAVEMENT MARKERS ON THE FINAL SURFACE AS FOLLOWS:

ROAD NAME	MARKING	MARKER
BROOKWOOD RD. (SR 1972)	POLYUREA	NONE

- H) TIE PROPOSED PAVEMENT MARKING LINES TO EXISTING PAVEMENT MARKING LINES

PAVEMENT MARKING SCHEDULE

SYMBOL	DESCRIPTION	PAY ITEM		TOTAL
		QUANTITY		
	POLYUREA (4", 20MLS)			
VA	WHITE EDGELINE	1810	LF	
VI	YELLOW DOUBLE CENTER	1810	LF	
		TOTAL	3620	LF

PHASING

NOTE: MAINTAIN TRAFFIC ACCESS TO DRIVEWAYS LOCATED WITHIN THE PROJECT LIMITS UTILIZING DRUMS TO DELINEATE THE TRAVELWAY.

- STEP 1: USING RSD 1101.03, SHEET 1 OF 9, DETAIL BELOW AND TCP-3 CLOSE BROOKWOOD RD. (SR 1972) TO THRU TRAFFIC.
- STEP 2: CONSTRUCT PROPOSED STRUCTURE, GUARDRAILS AND ROADWAY UP TO AND INCLUDING FINAL LAYER OF SURFACE COURSE FROM -L- STA. 9+45.00 TO -L- STA. 18+50.00.
- INSTALL FINAL PAVEMENT MARKINGS (POLYUREA) ON BROOKWOOD RD. (SR 1972) FROM -L- STA. 9+45.00 TO -L- STA. 18+50.00.
- STEP 3: REMOVE TRAFFIC CONTROL DEVICES AND OPEN BROOKWOOD RD. (SR 1972) TO FINAL TRAFFIC PATTERN.

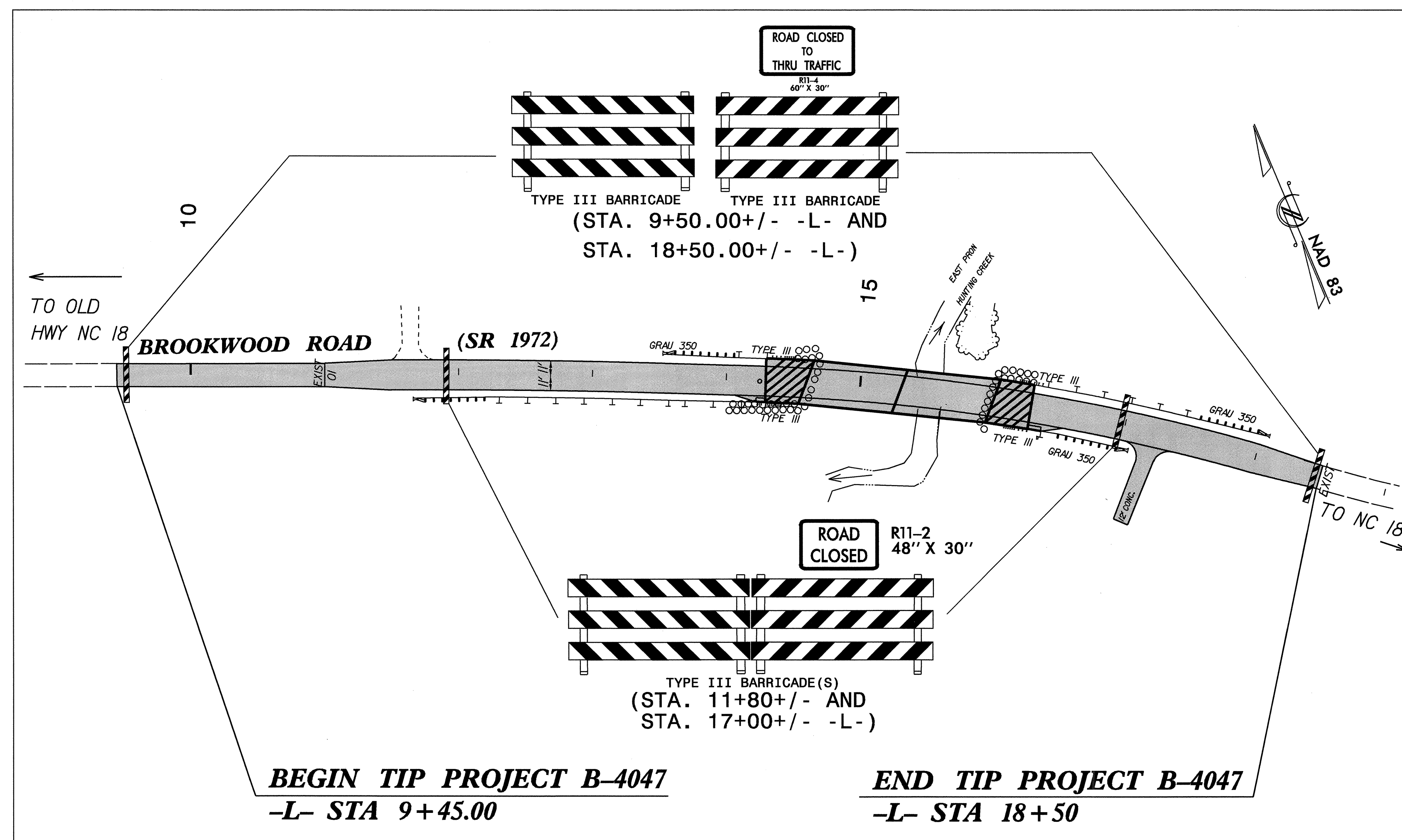

APPROVED:	DATE: 11/10/04	GENERAL NOTES / PHASING / BARRICADE DETAIL PAVEMENT MARKING SCHEDULE	
	SCALE: NONE		REVISIONS
	DATE: NOV 2004		
	DWG. BY: MM		
	DESIGN BY: MM		
	REVIEWED BY: JG		CADD FILE