

T.I.P. PROJECT: B-3530

CONTRACT: C200960

STATE OF NORTH CAROLINA
DIVISION OF HIGHWAYS

WAKE COUNTY

LOCATION: BRIDGE NO.174 ON SR 2320 OVER BUFFALO CREEK

TYPE OF WORK: GRADING, DRAINAGE, PAVING, AND STRUCTURE

STATE	STATE PROJECT REFERENCE NO.	SHEET NO.	TOTAL SHEETS
N.C.	B-3530		
STATE PROJ. NO.	F.A. PROJ. NO.	DESCRIPTION	
33138.1.1	BRZ-2320(2)	PE	
33138.2.1	BRZ-2320(2)	RW, UTIL	
33138.3.1	BRZ-2320(4)	CONST.	

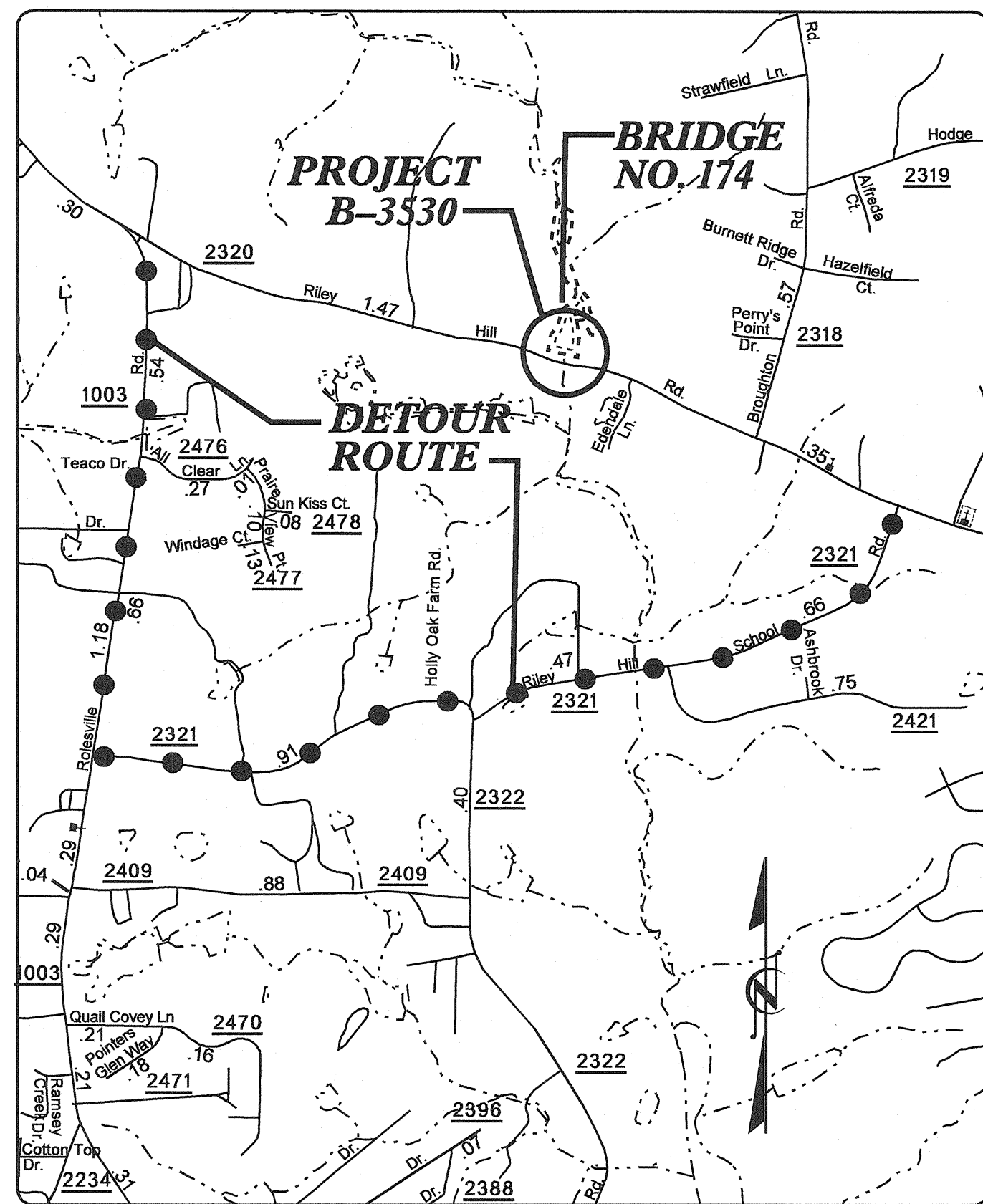

VICINITY MAP OF B-3530

●●●●● DETOUR

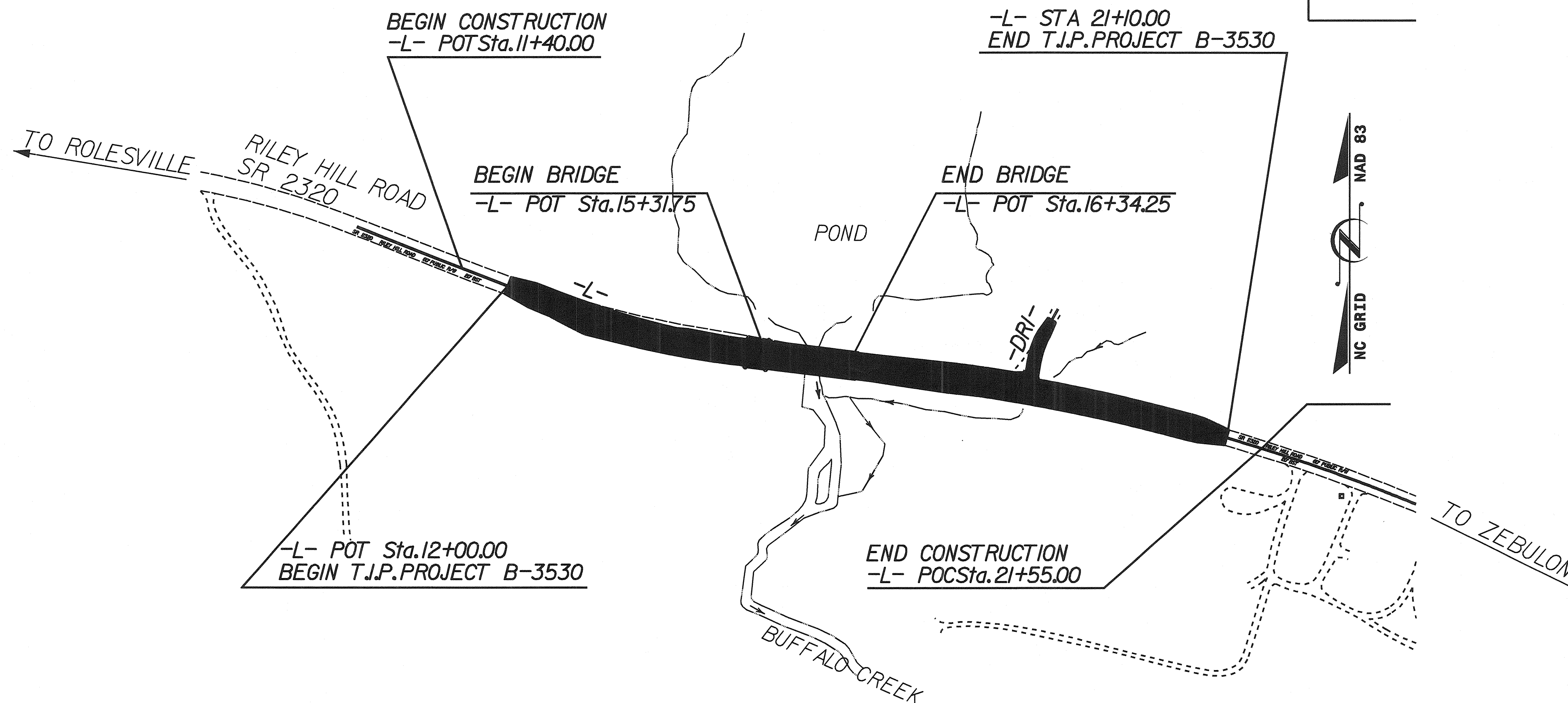

STRUCTURE

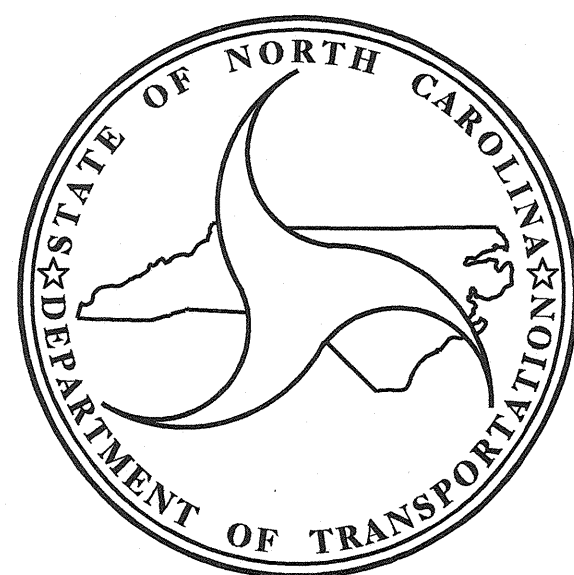

DESIGN DATA	
ADT 2004 =	7515
ADT 2024 =	11977
DHV =	10 %
D =	60 %
T =	3 %
V =	50 MPH
TTST 1%	DUAL 2%

PROJECT LENGTH	
LENGTH ROADWAY TIP PROJECT B-3530	= 0.153 MILES
LENGTH STRUCTURE TIP PROJECT B-3530	= 0.019 MILES
TOTAL LENGTH TIP PROJECT B-3530	= 0.172 MILES

Prepared In the Office of: DIVISION OF HIGHWAYS	
2002 STANDARD SPECIFICATIONS	
LETTING DATE: JANUARY 18, 2005	R. M. GIROLAMI, PE PROJECT ENGINEER
	L. E. SUTTON, PE PROJECT DESIGN ENGINEER

STRUCTURE DESIGN UNIT
1000 BIRCH RIDGE DR.
RALEIGH, NC. 27610

12-07-04

DIVISION OF HIGHWAYS STATE OF NORTH CAROLINA	
	P.E.
STATE DESIGN ENGINEER DEPARTMENT OF TRANSPORTATION FEDERAL HIGHWAY ADMINISTRATION	
APPROVED DIVISION ADMINISTRATOR	DATE