

TIP: B-3522

CONTRACT: C201140

See Sheet 1-A For Index of Sheets  
See Sheet 1-B For Conventional Symbols

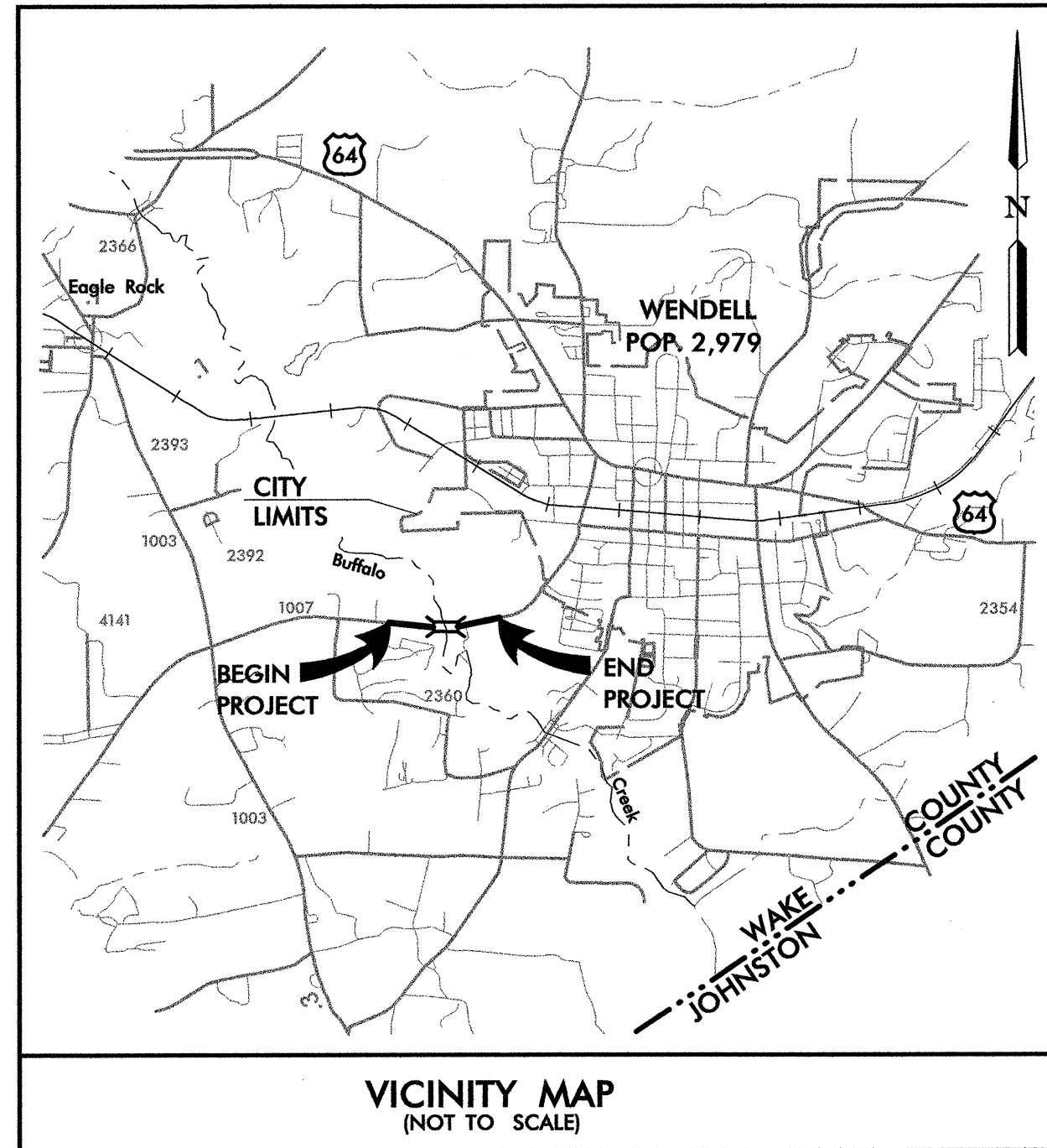

STATE OF NORTH CAROLINA  
DIVISION OF HIGHWAYS  
**WAKE COUNTY**

STATE	STATE PROJECT REFERENCE NO.	SHEET NO.	TOTAL SHEETS
N.C.	B-3522	1	
WBS NO.	F.A. PROJ. NO.	DESCRIPTION	
33131.1.1	BRSTP-1007(5)	P.E.	
33131.2.1	BRSTP-1007(5)	RW, UTIL	
33131.3.1	BRSTP-1007(11)	CONST	

LOCATION: BRIDGE NO. 215 OVER BUFFALO CREEK AND APPROACHES ON SR 1007 (POOLE ROAD) SOUTH OF WENDELL

TYPE OF WORK: GRADING, DRAINAGE, PAVING, AND STRUCTURE

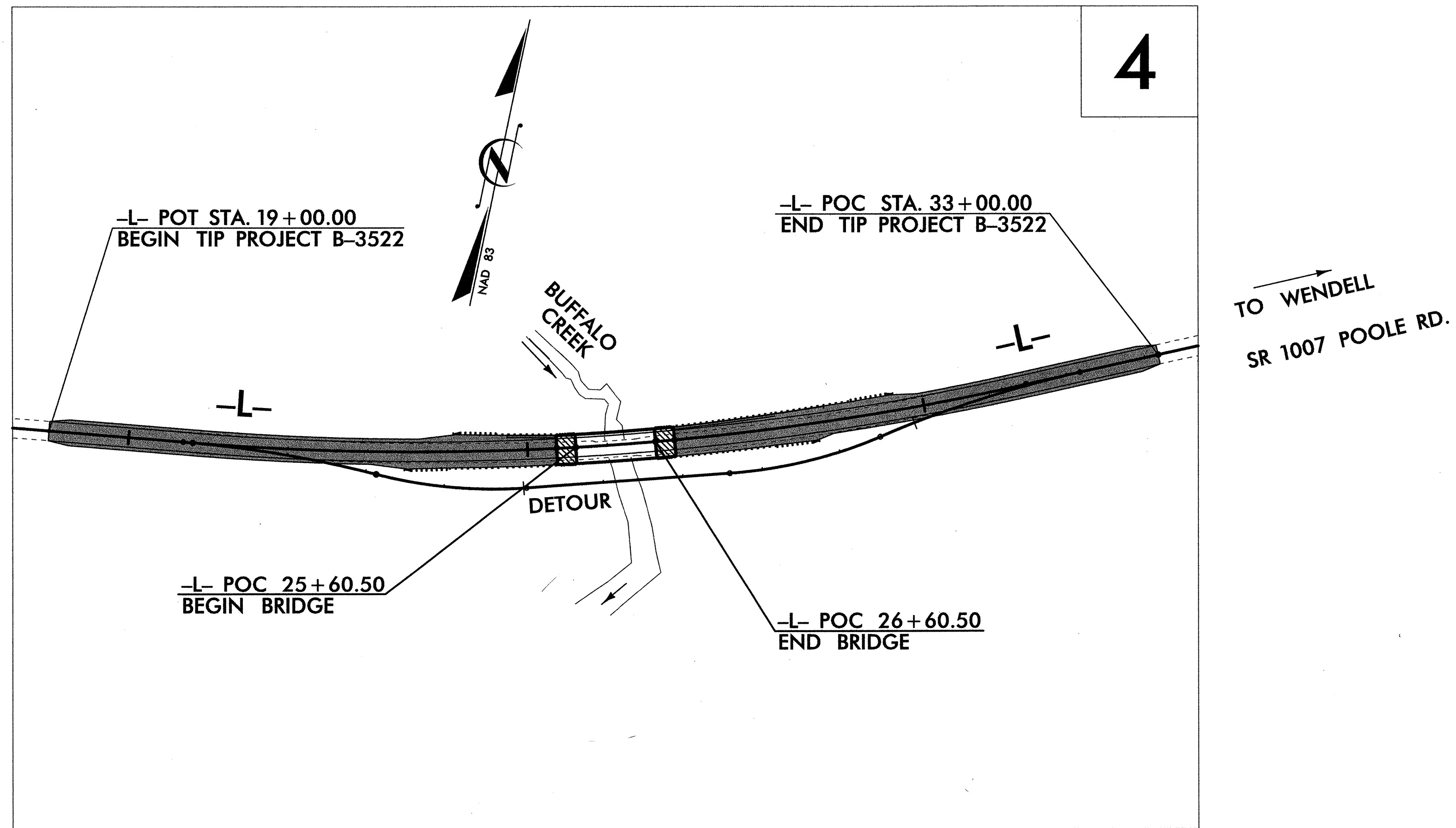

**MULKEY**  
ENGINEERS & CONSULTANTS  
PO BOX 33127  
RALEIGH, NC 27636  
919 851-1912  
919 851-1915 (FAX)  
WWW.MULKEYINC.COM

**GRAPHIC SCALE**

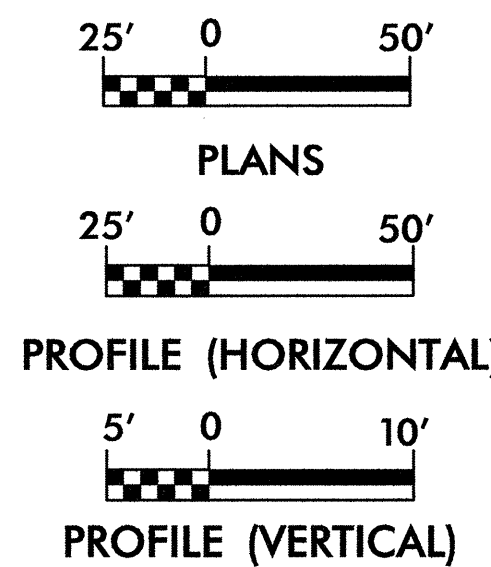

**DESIGN DATA**

ADT 2004 = 5,525  
ADT 2024 = 10,645  
DHV = 12%  
D = 65%  
T = 4% \*  
V = 50 mph

\* (Duals = 3% + TTST = 1%)

**PROJECT LENGTH**

LENGTH ROADWAY TIP PROJECT B-3522 = 0.246 MILES  
LENGTH STRUCTURES TIP PROJECT B-3522 = 0.019 MILES  
TOTAL LENGTH TIP PROJECT B-3522 = 0.265 MILES

Prepared In the Office of:  
**Mulkey Engineers & Consultants**  
FOR THE NORTH CAROLINA DEPARTMENT OF TRANSPORTATION

2002 STANDARD SPECIFICATIONS

**RIGHT OF WAY DATE:**  
SEPTEMBER 19, 2003

**LETTING DATE:**  
JANUARY 18, 2005

**NC DOT CONTACT:** TERESA BRUTON, P.E.  
DESIGN SERVICES - PROJECT ENGINEER

T. S. HAYES, P.E.  
MULKEY E & C  
PROJECT MANAGER

JOHNNY BANKS  
MULKEY E & C  
PROJECT DESIGN ENGINEER

**HYDRAULICS ENGINEER**

**ROADWAY DESIGN**

Professional Engineer Seal: JENNY SUMMERLIN FLEMING, SEAL 25506, SIGNATURE: J. S. Hayes, PE 11/15/04

Professional Engineer Seal: JOHNNY BANKS, SEAL 19563, SIGNATURE: Johnny Banks, PE 11/15/04

**DIVISION OF HIGHWAYS**  
STATE OF NORTH CAROLINA

Professional Engineer Seal: T. S. Hayes, SEAL 25506, SIGNATURE: T. S. Hayes, PE 11/15/04

Professional Engineer Seal: JOHNNY BANKS, SEAL 19563, SIGNATURE: Johnny Banks, PE 11/15/04

APPROVED FOR DIVISION ADMINISTRATOR