

CONTRACT: C201351 TIP PROJECT: B-3651

CULVERT

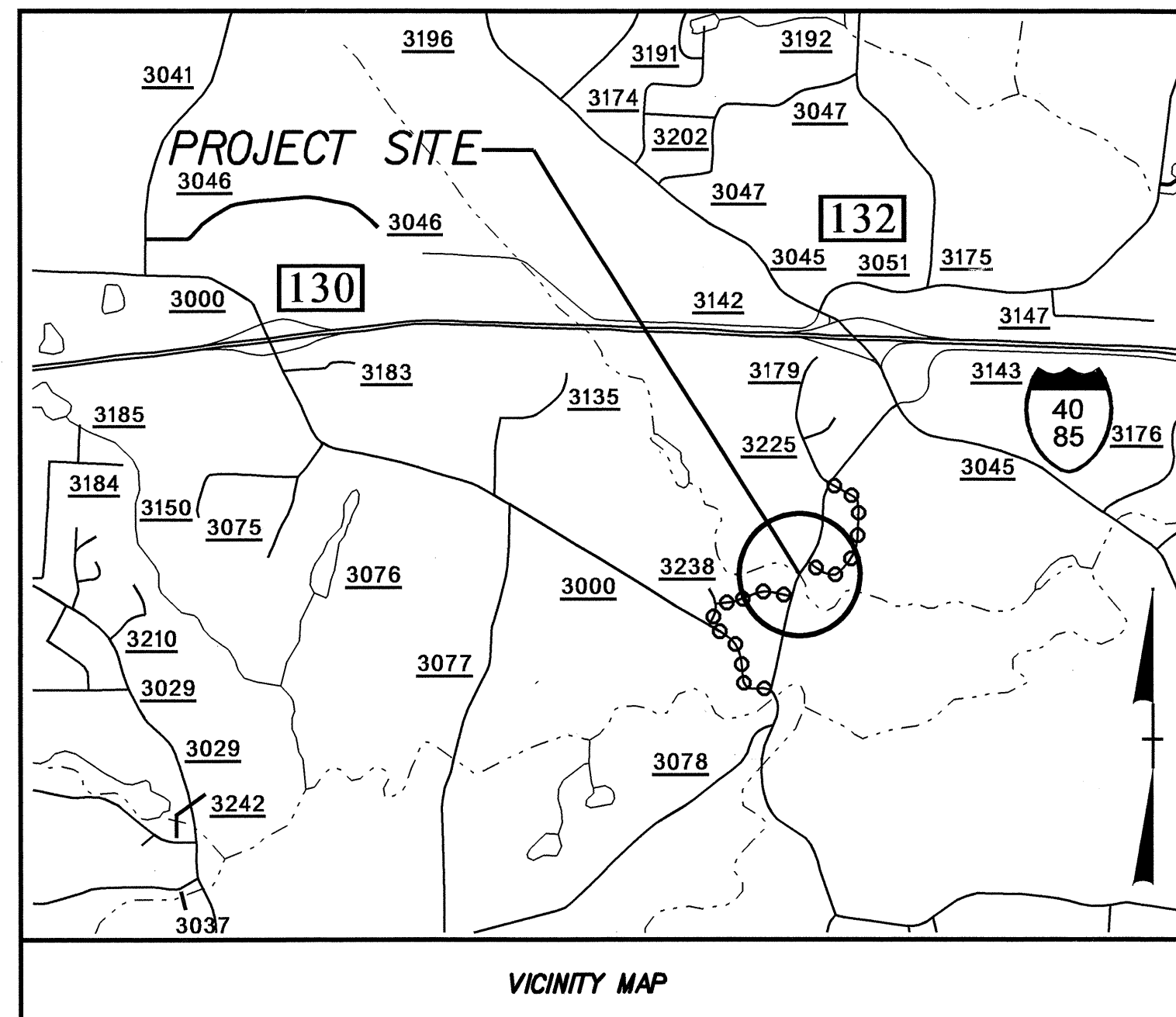

--- OFF-SITE DETOUR ROUTE FOR -Y1- & -Y2-

STATE OF NORTH CAROLINA
 DIVISION OF HIGHWAYS
GUILFORD COUNTY

STATE	STATE PROJECT REFERENCE NO.	SHEET NO.	TOTAL SHEETS
N.C.	B-3651		
STATE PROJ. NO.	P.A. PROJ. NO.	DESCRIPTION	
33197.1.1	BRZ-3143(7)	P.E.	
33197.2.2	BRZ-3143(8)	RIGHT-OF-WAY	
33197.2.2	BRZ-3143(8)	UTILITY	
33197.3.1	BRZ-3143(9)	CONSTRUCTION	

**LOCATION: BRIDGE NO. 359 OVER PRONG ALAMANCE CREEK
 ON SR 3143 (MILLSTREAM RD)**

TYPE OF WORK: GRADING, PAVING, DRAINAGE, AND CULVERT

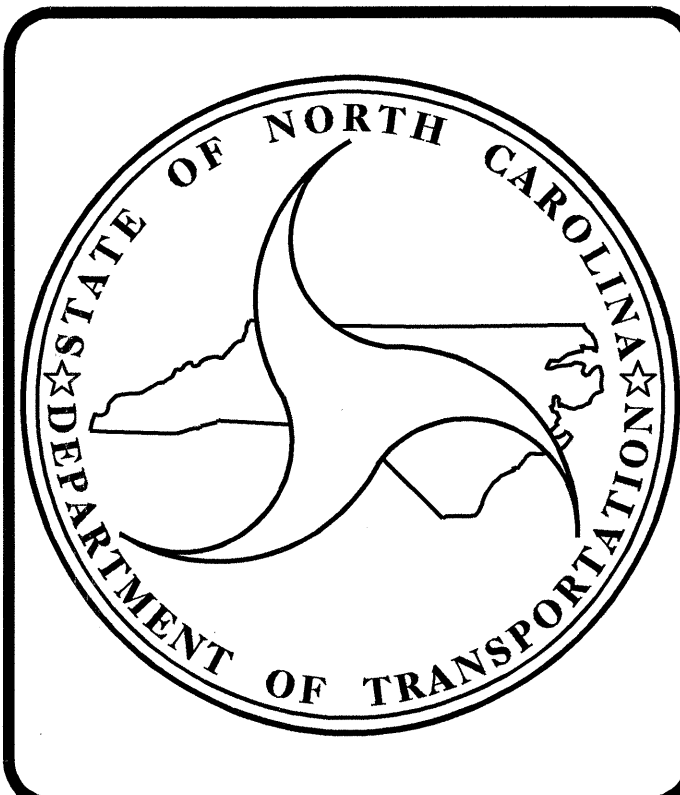
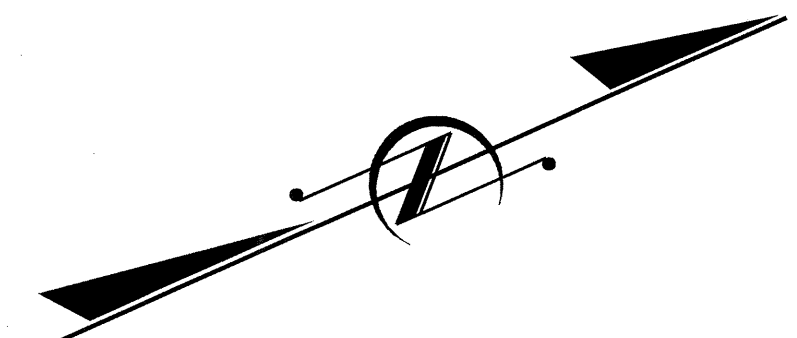
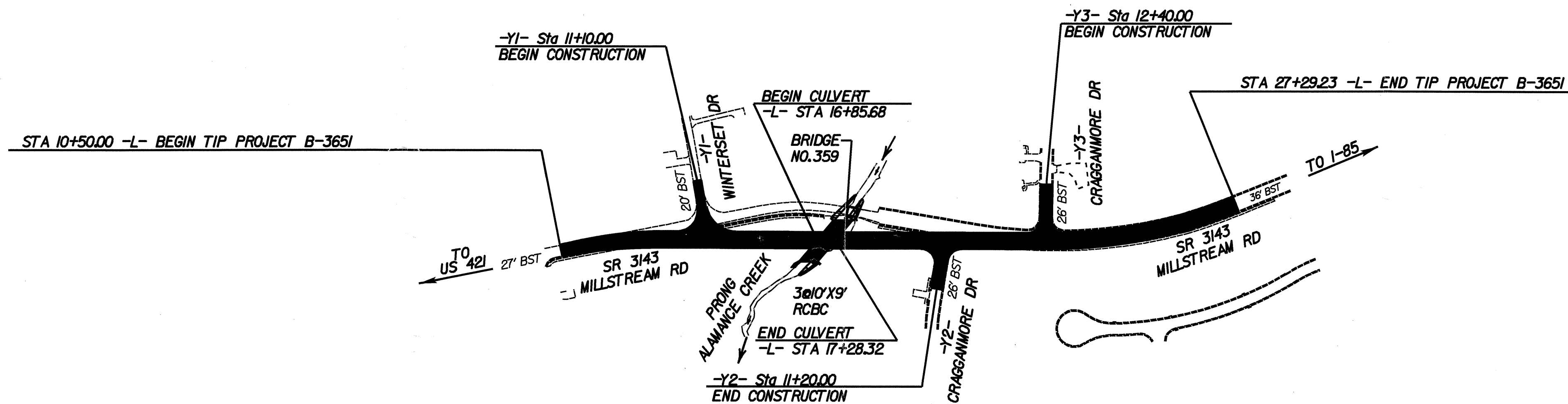

DESIGN DATA

ADT 2005 = 2,100 VPD
 ADT 2025 = 3,800 VPD
 DHV = 11%
 D = 65%
 T = 4% *
 V = 50 mph
 VERTICAL CURVE AND
 MAXIMUM GRADE
 DESIGN EXCEPTIONS
 * (TTST 1% + DUAL 3%)

PROJECT LENGTH

LENGTH OF ROADWAY TIP PROJECT B-3651 = 0.310 MILES
 LENGTH OF STRUCTURE TIP PROJECT B-3651 = 0.008 MILES
 TOTAL LENGTH OF TIP PROJECT B-3651 = 0.318 MILES

Prepared in the Office of:
DIVISION OF HIGHWAYS
 1000 Birch Ridge Dr., Raleigh NC, 27610
 2002 STANDARD SPECIFICATIONS

LETTING DATE:
 JANUARY 18, 2005

STRUCTURE DESIGN UNIT

NORTH CAROLINA
 PROFESSIONAL
 SEAL
 14552
 ENGINEER
 GREGORY R. PERFETTI

Girolami
 7/21/04

DIVISION OF HIGHWAYS
 STATE OF NORTH CAROLINA
 STATE DESIGN ENGINEER P.E.
 DEPARTMENT OF TRANSPORTATION
 FEDERAL HIGHWAY ADMINISTRATION
 APPROVED DIVISION ADMINISTRATOR DATE