

**ALL WATER LINES AND SANITARY SEWER LINES OWNED BY THE CITY OF GASTONIA**

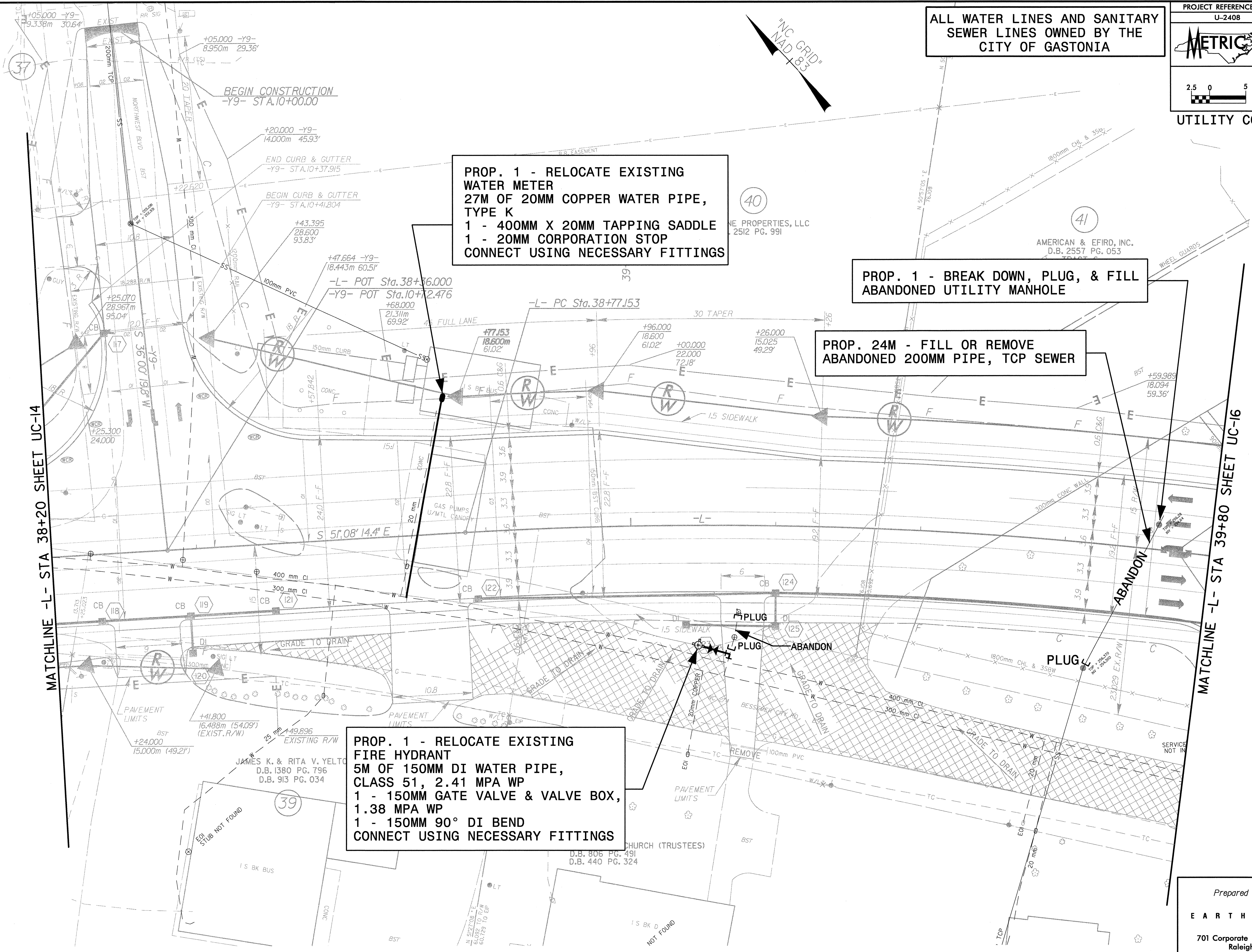
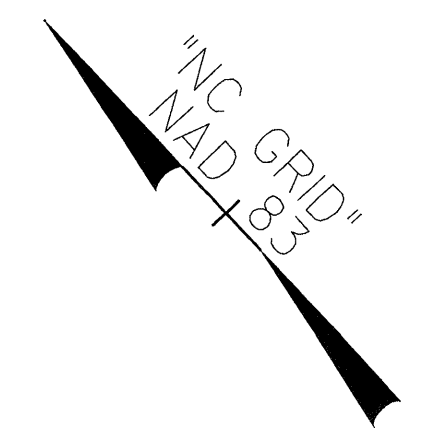

**PROP. 1 - RELOCATE EXISTING WATER METER**  
 27M OF 20MM COPPER WATER PIPE, TYPE K  
 1 - 400MM X 20MM TAPPING SADDLE  
 1 - 20MM CORPORATION STOP  
 CONNECT USING NECESSARY FITTINGS

**PROP. 1 - BREAK DOWN, PLUG, & FILL ABANDONED UTILITY MANHOLE**

**PROP. 24M - FILL OR REMOVE ABANDONED 200MM PIPE, TCP SEWER**

**PROP. 1 - RELOCATE EXISTING FIRE HYDRANT**  
 5M OF 150MM DI WATER PIPE, CLASS 51, 2.41 MPA WP  
 1 - 150MM GATE VALVE & VALVE BOX, 1.38 MPA WP  
 1 - 150MM 90° DI BEND  
 CONNECT USING NECESSARY FITTINGS

MATCHLINE -L- STA 38+20 SHEET UC-14

MATCHLINE -L- STA 39+80 SHEET UC-16

C:\76845\cadwork\15\2408\UC-15.dwg 10/07/2004 11:33:12 AM