

CONTRACT: C200962 TIP PROJECT B-3690

See Sheet 1-A For Index of Sheets
See Sheet 1-B For Conventional Symbols

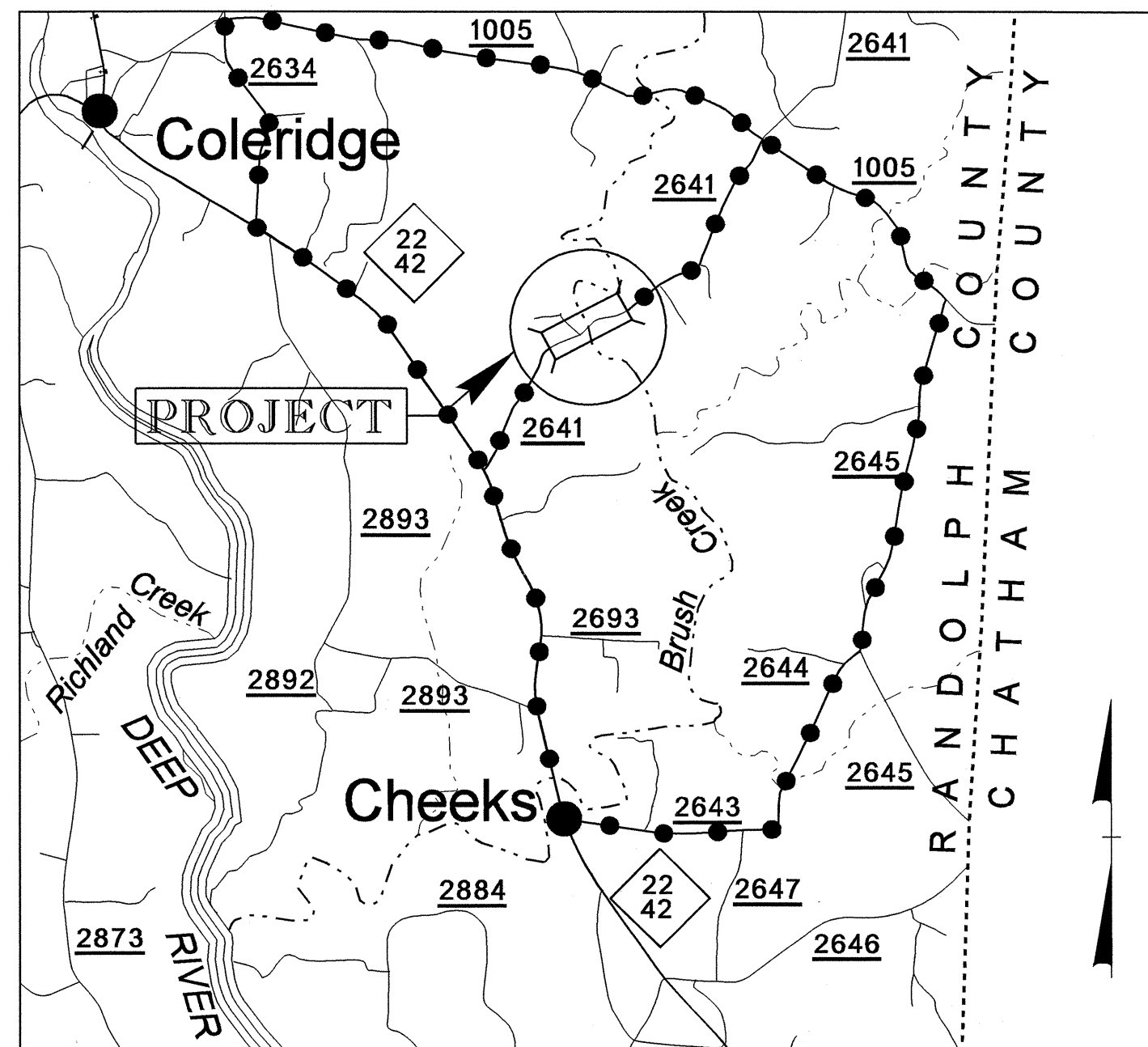

VICINITY MAP



STATE OF NORTH CAROLINA
DIVISION OF HIGHWAYS

RANDOLPH COUNTY

**LOCATION: BRIDGE NO. 163 OVER BRUSH CREEK
ON SR 2641**

**TYPE OF WORK: GRADING, PAVING, DRAINAGE,
AND STRUCTURE**

STATE	STATE PROJECT REFERENCE NO.	SHEET NO.	TOTAL SHEETS
N.C.	B-3690	1	
STATE PROJ. NO.	F.A. PROJ. NO.	DESCRIPTION	
33230.1.1	BRZ-2641(1)	P.E.	
33230.2.2	BRZ-2641(1)	R\W & UTIL	
33230.3.1	BRZ-2641(2)	CONST.	

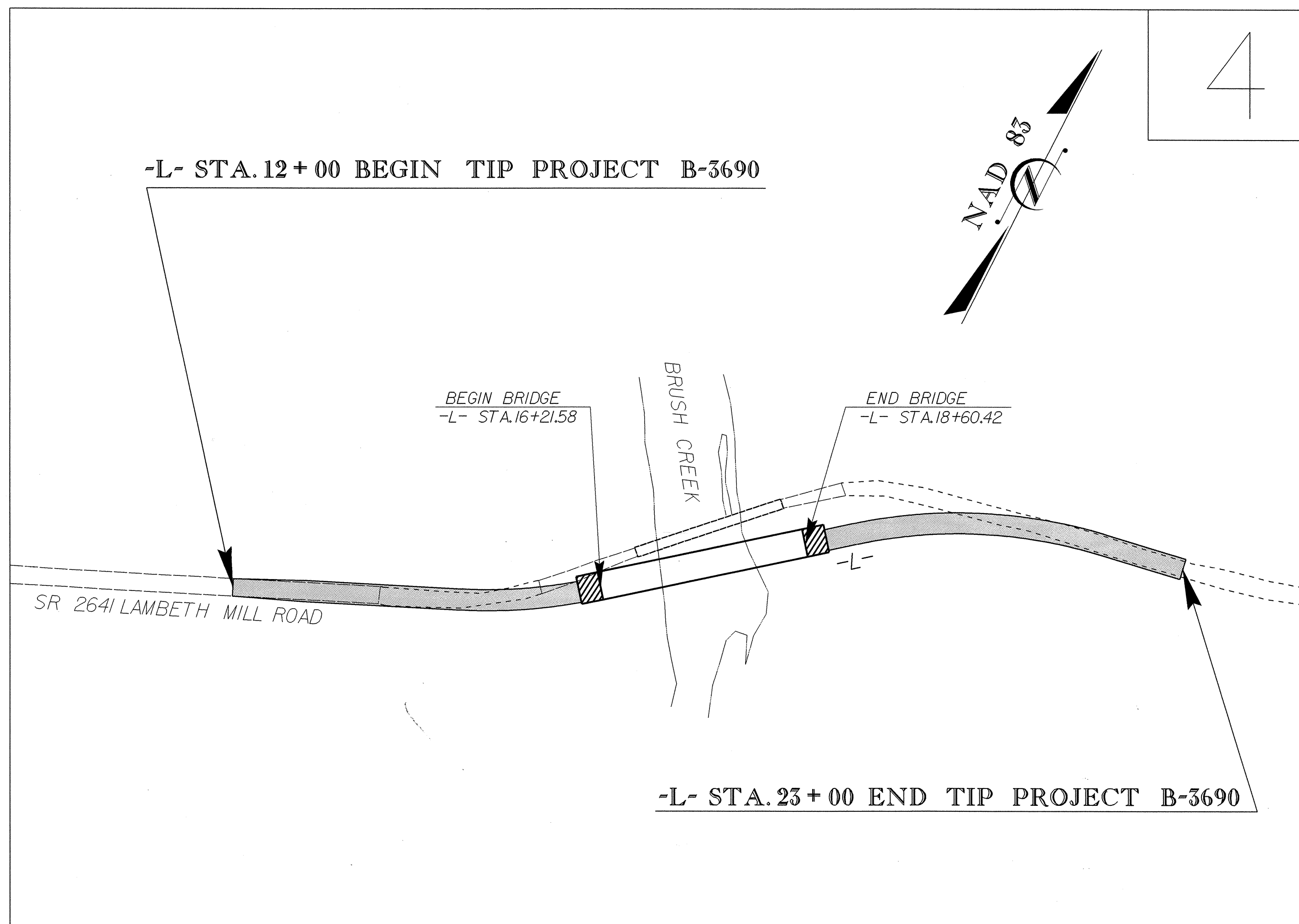

☆ DESIGN EXCEPTION REQUIRED FOR DESIGN SPEED AND SUPERELEVATION

GRAPHIC SCALES

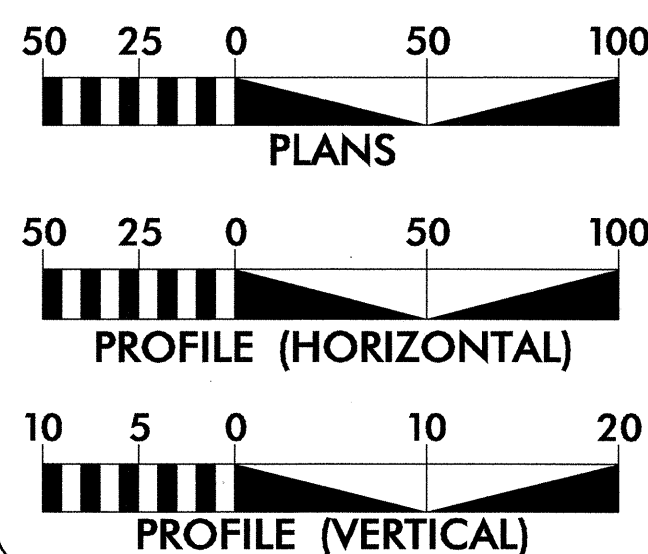

DESIGN DATA

ADT 2004 = 195
ADT 2025 = 300
DHV = 10 %
D = 60 %
T = 3 % *
V = 40 MPH ☆
* TTST 1 % DUAL 2 %

PROJECT LENGTH

LENGTH ROADWAY TIP PROJECT B-3690 = 0.163 MI.
LENGTH STRUCTURE TIP PROJECT B-3690 = 0.045 MI.
TOTAL LENGTH OF TIP PROJECT B-3690 = 0.208 MI.

Prepared in the Office of:
DIVISION OF HIGHWAYS
1000 Birch Ridge Dr.
Raleigh, NC 27610

2002 STANDARD SPECIFICATIONS
RIGHT OF WAY DATE:
SEPTEMBER 25, 2003

LETTING DATE:
SEPTEMBER 21, 2004

ROGER D. THOMAS, P.E.
PROJECT ENGINEER

MICHAEL W. LITTLE, P.E.
PROJECT DESIGN ENGINEER

HYDRAULICS ENGINEER
NORTH CAROLINA PROFESSIONAL ENGINEER
SEAL 24451
SIGNATURE: *Stacey H. Bailey* 6/30/04
P.E.

ROADWAY DESIGN ENGINEER
NORTH CAROLINA PROFESSIONAL ENGINEER
SEAL 22557
SIGNATURE: *Michael W. Little* 6/21/04
P.E.

DIVISION OF HIGHWAYS
STATE OF NORTH CAROLINA
Art McMillan P.E.
STATE DESIGN ENGINEER
DEPARTMENT OF TRANSPORTATION
FEDERAL HIGHWAY ADMINISTRATION

APPROVED
DIVISION ADMINISTRATOR
DATE