

-L-

LEFT DITCH -----
 RIGHT DITCH -----

BM #1 RR SPIKE SET IN BASE OF 12" ELM TREE
 -BL- STA 13+21.87, 112.15' RT
 ELEV. 433.53

BM #2 RR SPIKE SET IN BASE OF TRIPLE PINE
 -BY- STA 8+12.92, 92.77' LT
 ELEV. 472.23'

**DESIGN EXCEPTION REQUIRED FOR A SAG
 VERTICAL CURVE (50 MPH).

BEGIN GRADE -L- STA. 12+45.00
 EL. 438.09'

PI = 13+20.00
 EL = 437.86'
 VC = 150'
 K = 111
 **V = 54 MPH

PI = 18+00.00
 EL = 442.85'
 VC = 290'
 K = 98
 **V = 50 MPH

PI = 22+48.00
 EL = 460.76'
 VC = 110'
 K = 20
 V = 30 MPH

END GRADE -L- STA. 23+04.81
 EL. 459.95'

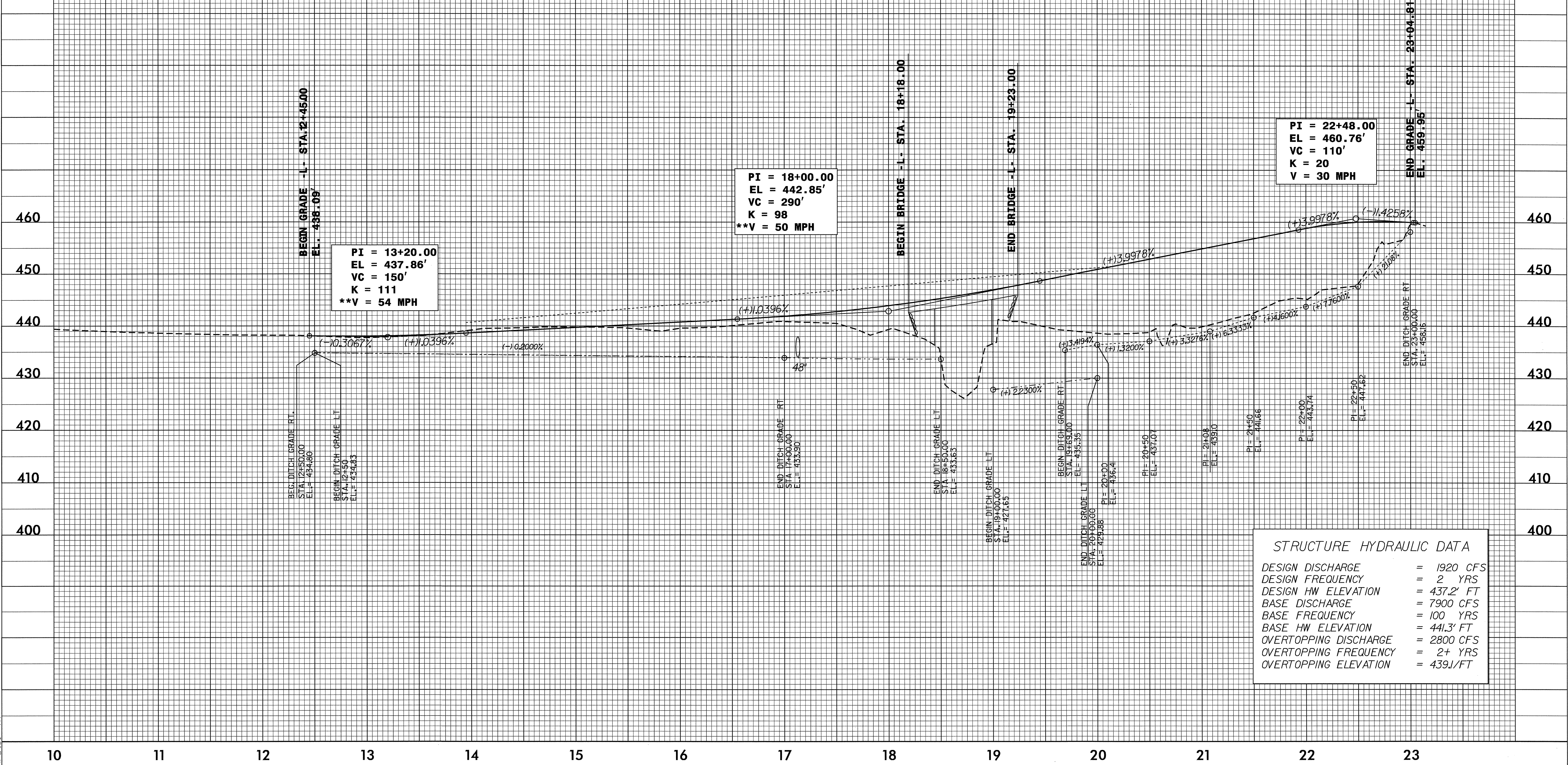

STRUCTURE HYDRAULIC DATA	
DESIGN DISCHARGE	= 1920 CFS
DESIGN FREQUENCY	= 2 YRS
DESIGN HW ELEVATION	= 437.2' FT
BASE DISCHARGE	= 7900 CFS
BASE FREQUENCY	= 100 YRS
BASE HW ELEVATION	= 441.3' FT
OVERTOPPING DISCHARGE	= 2800 CFS
OVERTOPPING FREQUENCY	= 2+ YRS
OVERTOPPING ELEVATION	= 439.1/FT