

09/08/99

See Sheet 1-A For Index of Sheets

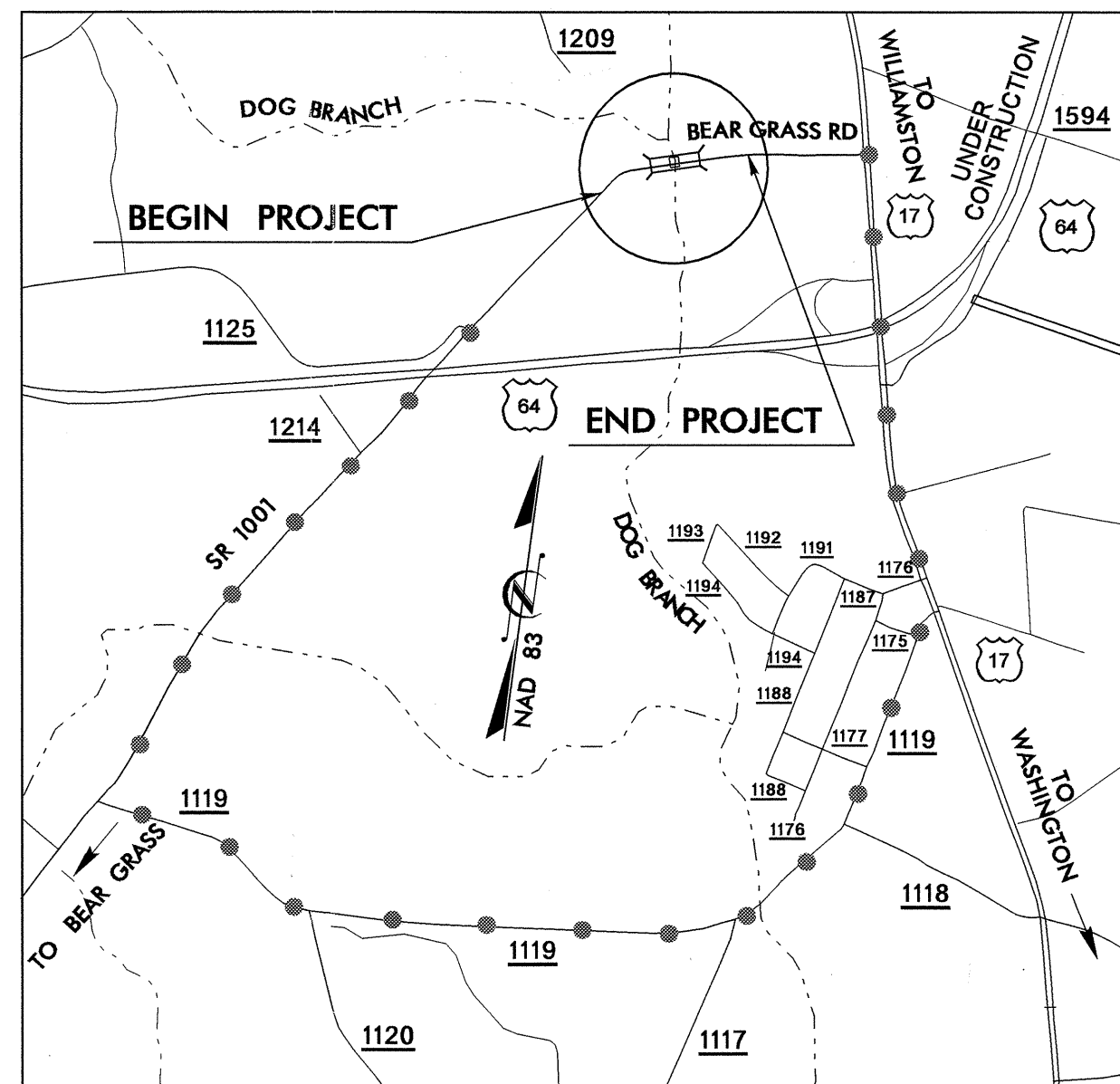

OFF SITE DETOUR
VICINITY MAP

STATE OF NORTH CAROLINA
DIVISION OF HIGHWAYS

MARTIN COUNTY

**LOCATION: BRIDGE NO. 64 OVER DOG BRANCH
ON SR 1001 (BEAR GRASS ROAD)**

**TYPE OF WORK: GRADING, PAVING, DRAINAGE, AND
AND STRUCTURE**

STATE	STATE PROJECT REFERENCE NO.	SHEET NO.	TOTAL SHEETS
N.C.	B-3871	1	
STATE PROJ. NO.	F.A. PROJ. NO.	DESCRIPTION	
33315.1.1	BRSTP-1001(19)	PE,	
33315.3.1	BRSTP-1001(35)	RW, UTIL	
33315.2.2	BRSTP-1001(35)	CONST	

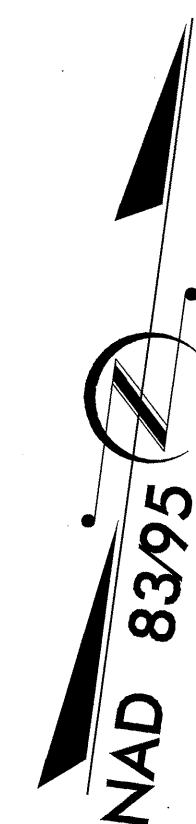
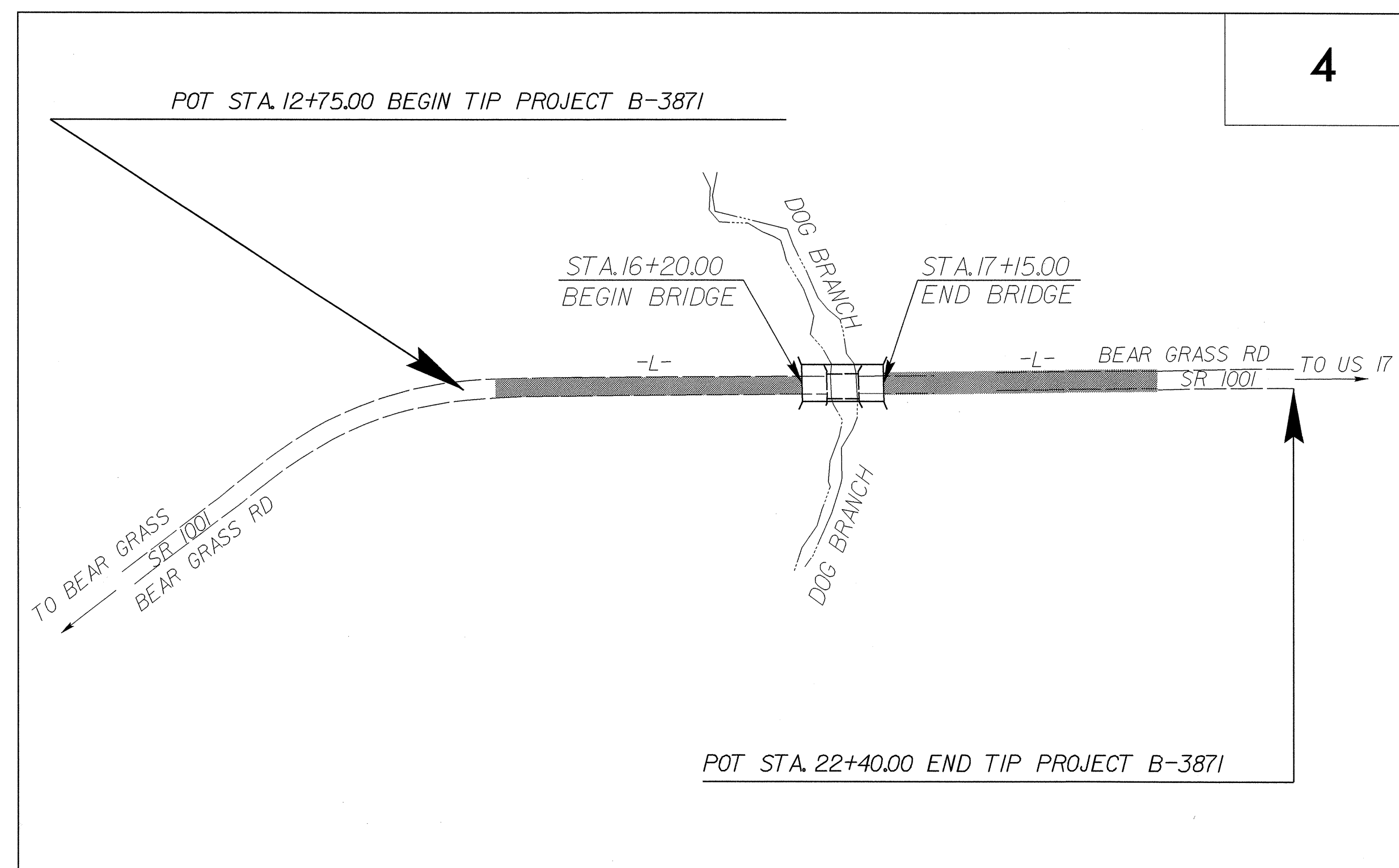

** DESIGN EXCEPTION REQUIRED FOR VERTICAL ALIGNMENT AND BRIDGE WIDTH

GRAPHIC SCALES

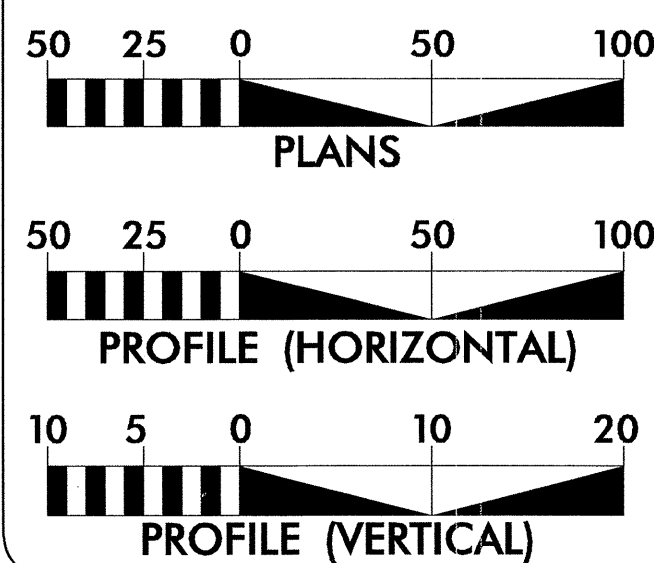

DESIGN DATA

ADT 2005 = 3500
 ADT 2025 = 6300
 DHV = 10 %
 D = 60 %
 T = 6 % *
 ** V = 55 MPH
 * TTST 2% DUAL 4%
 FUNC. CLASS = MAJOR COLLECTOR

PROJECT LENGTH

LENGTH ROADWAY TIP PROJECT B-3871 = 0.165 MI
 LENGTH STRUCTURES TIP PROJECT B-3871 = 0.018 MI
 TOTAL LENGTH TIP PROJECT B-3871 = 0.183 MI

Prepared in the Office of:
DIVISION OF HIGHWAYS
 1000 Birch Ridge Dr., Raleigh NC, 27610

2002 STANDARD SPECIFICATIONS

RIGHT OF WAY DATE:
 MAY 30, 2003

LETTING DATE:
 SEPTEMBER 21, 2004

G. E. BREW, PE
 PROJECT ENGINEER

W. T. BEST
 PROJECT DESIGN ENGINEER

HYDRAULIC ENGINEER

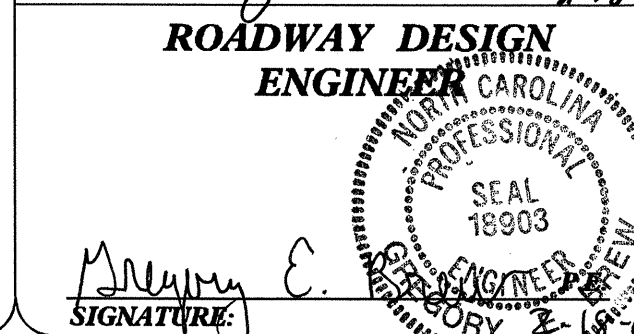
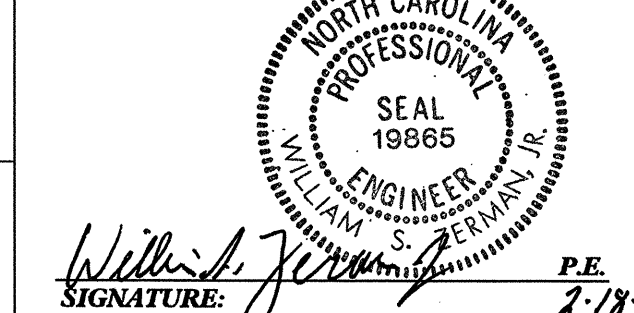

DIVISION OF HIGHWAYS
 STATE OF NORTH CAROLINA

STATE DESIGN ENGINEER
 DEPARTMENT OF TRANSPORTATION
 FEDERAL HIGHWAY ADMINISTRATION

APPROVED
 DIVISION ADMINISTRATOR
 DATE

13-FEB-2004 12:07
 R:\Roadway\PROJ\B-3871\RDY_TSH.dgn
 WBest AT RD212299

B-3871

C201264

PROJECT: