

STATE	STATE PROJECT REFERENCE NO.	SHEET NO.	TOTAL SHEETS
N.C.	B-3865	1	
STATE PROJ. NO.	F.A. PROJ. NO.	DESCRIPTION	
33311.1.1	BRSTP-1002 (8)	PE	
33311.2.2	BRSTP-1002 (8)	R/W, UTILITIES	
33311.3.1	BRSTP-1002 (8)	CONSTRUCTION	

STATE OF NORTH CAROLINA
DIVISION OF HIGHWAYS

JOHNSTON COUNTY

LOCATION: BRIDGE NO. 212 OVER LITTLE RIVER
AND APPROACHES ON SR 1002

TYPE OF WORK: GRADING, DRAINAGE, GUARDRAIL, PAVING AND STRUCTURE

See Sheet 1-A For Index of Sheets
See Sheet 1-B For Conventional Symbols

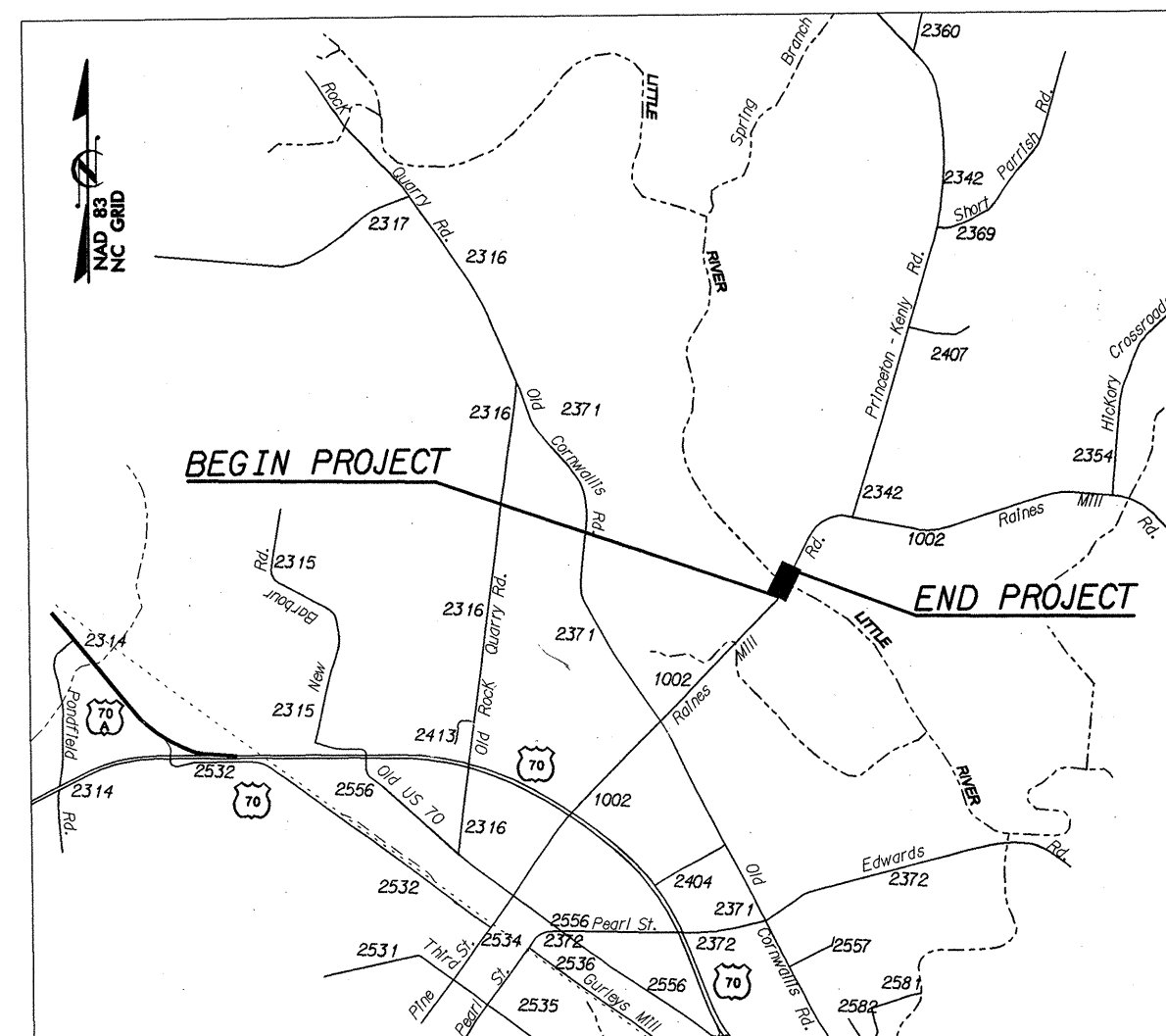

VICINITY MAP

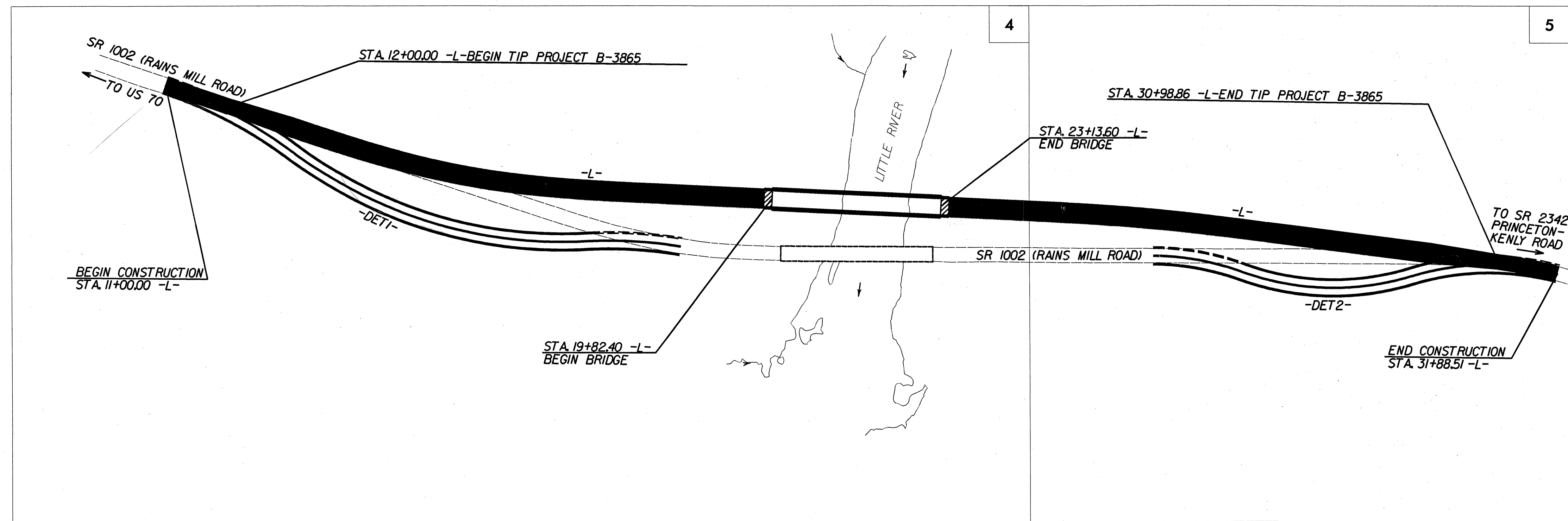
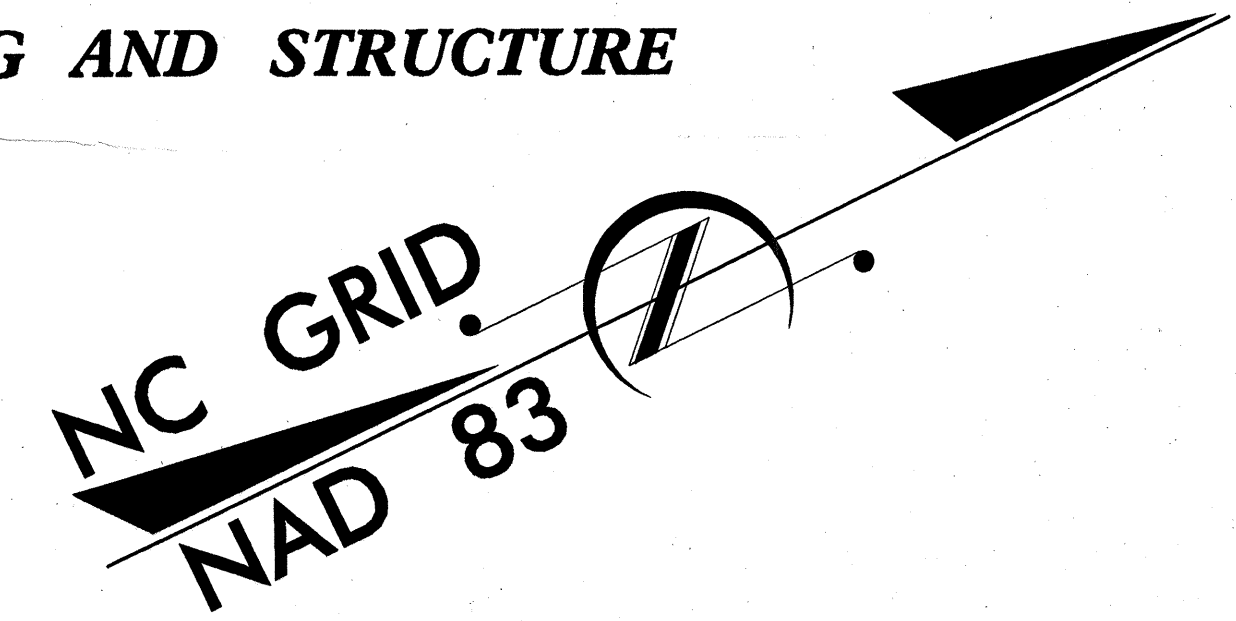

NCDOT CONTACT: MS. CATHY S. HOUSER, PE, PROJECT ENGINEER

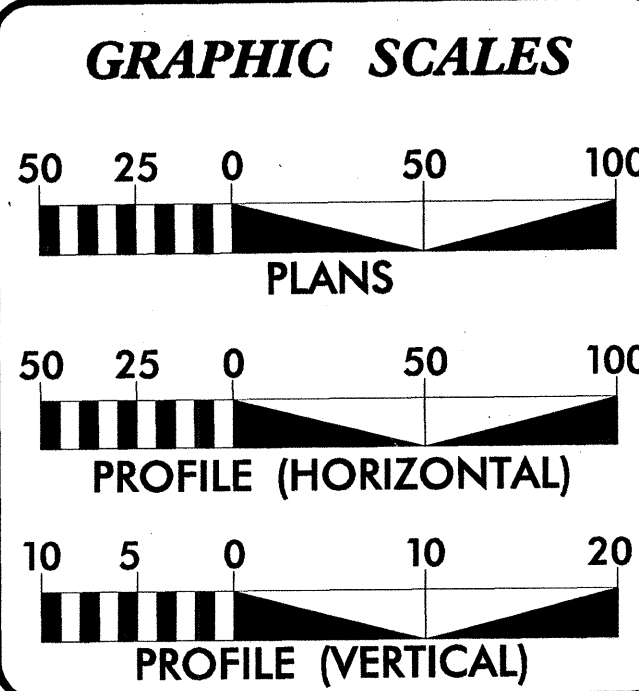

DESIGN DATA

ADT 2003 =	3900 VPD
ADT 2023 =	6600 VPD
DHV =	9%
D =	60%
T =	6% *
V =	60 MPH
* TTST	2% + DUAL 4%

PROJECT LENGTH

LENGTH ROADWAY TIP PROJECT B-3865 =	0.297 MILE
LENGTH STRUCTURE TIP PROJECT B-3865 =	0.063 MILE
TOTAL LENGTH OF TIP PROJECT B-3865 =	0.360 MILE

Prepared for NCDOT In the Office of:
KCI Associates of North Carolina, P.A.
RALEIGH OFFICE ENGINEERS • PLANNERS • ECOLOGISTS

SUITE 200, LANDMARK CENTER I
460 SIX FORKS RD.
RALEIGH, N.C. 27609-5210
(919) 783-9294

2002 STANDARD SPECIFICATIONS

RIGHT OF WAY DATE: APRIL 18, 2003

LETTING DATE: SEPTEMBER 21, 2004

MICHELLE R. BRAME, P.E.
PROJECT ENGINEER

JENNIFER M. SPOHN
PROJECT DESIGN ENGINEER

HYDRAULICS ENGINEER

ROADWAY DESIGN

JEFFREY L. RECK
ENGINEER
P.E.

MICHELLE R. BRAME
ENGINEER
P.E.

DIVISION OF HIGHWAYS STATE OF NORTH CAROLINA

cut m. millan
STATE DESIGN ENGINEER
P.E.

DEPARTMENT OF TRANSPORTATION
FEDERAL HIGHWAY ADMINISTRATION

APPROVED
DIVISION ADMINISTRATOR
DATE

CONTRACT: C200846 TIP PROJECT: B-3865