

8-1-2003

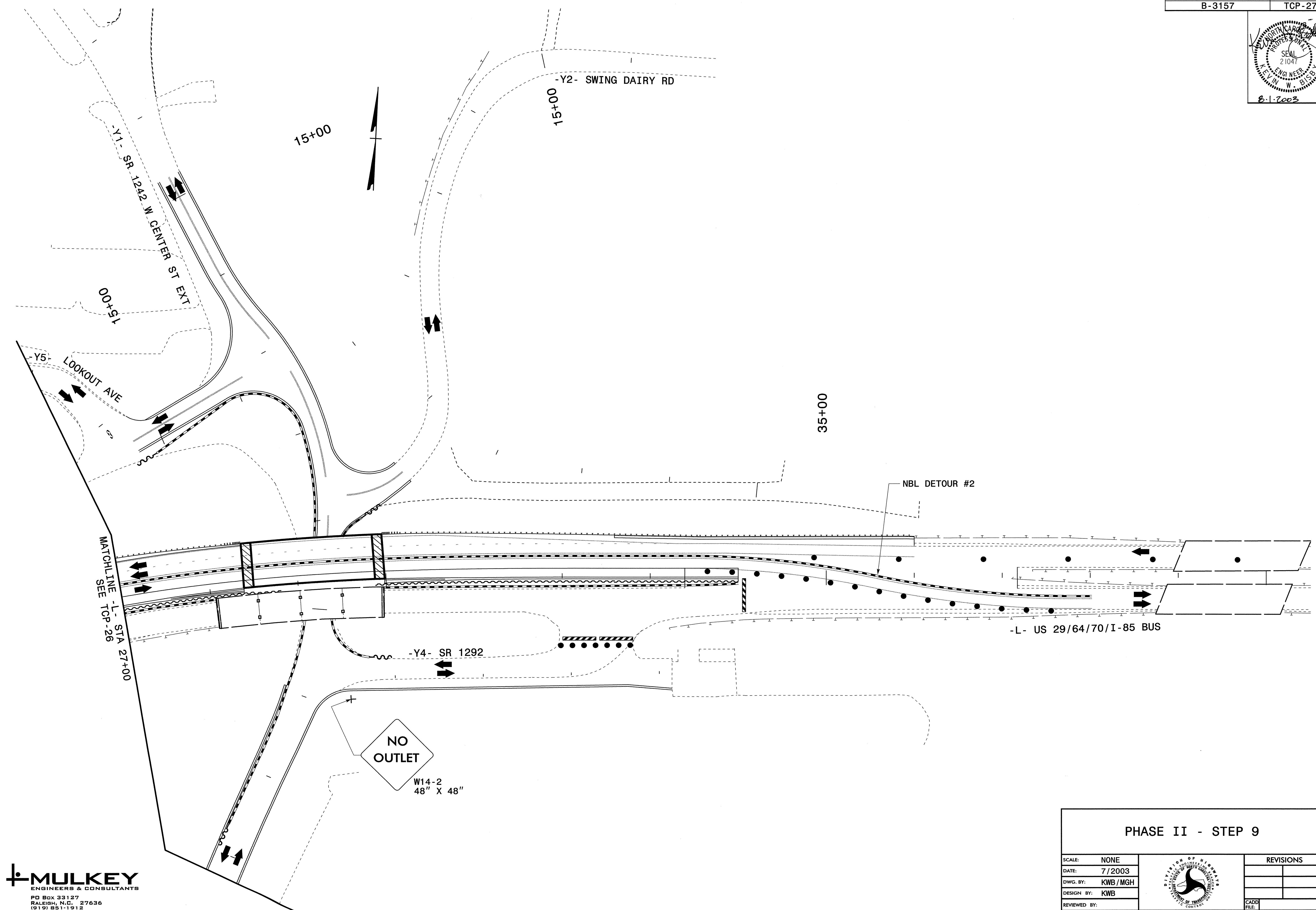

**MULKEY**  
ENGINEERS & CONSULTANTS  
PO Box 33127  
RALEIGH, N.C. 27636  
(919) 851-1912  
(919) 851-1918 (FAX)  
WWW.MULKEYINC.COM

<b>PHASE II - STEP 9</b>												
SCALE: NONE		<table border="1"> <tr><th colspan="2">REVISIONS</th></tr> <tr><td> </td><td> </td></tr> <tr><td> </td><td> </td></tr> <tr><td> </td><td> </td></tr> <tr><td> </td><td> </td></tr> </table>	REVISIONS									
REVISIONS												
DATE: 7/2003												
DWG. BY: KWB/MGH												
DESIGN BY: KWB												
REVIEWED BY:	<table border="1"> <tr><td> </td><td> </td></tr> <tr><td> </td><td> </td></tr> </table>											

08/07/2003 09:46:51 AM g:\p\o\pact\2001\24.00.0357\tr\officcom\tr\03357-fcp-p27sht2.dgn