

SEE SHEET 31 FOR -L- PROFILE

|   |  |                         |  |
|---|--|-------------------------|--|
| PROJECT REFERENCE NO.<br>U-0620   |  | SHEET NO.<br>16         |  |
| RW SHEET NO.  |  |                         |  |
| ROADWAY DESIGN ENGINEER<br>   |  | HYDRAULICS ENGINEER<br> |  |
| <b>Carter=Burgess</b><br>Consultants in Planning, Engineering, Architecture, Construction Management and Related Services<br>5811 Glenwood Avenue, Suite 300<br>Raleigh, North Carolina 27612 |  |                         |  |
| <b>TRANSITE CONSULTING</b><br>ENGINEERS, INCORPORATED<br>ENGINEERS • PLANNERS • CEI<br>1300 Paddock Drive, Suite G-10<br>Raleigh, N.C. 27609<br>OFFICE 919-873-2401 FAX 919-873-2404          |  |                         |  |

ALL DRIVEWAYS ARE 20' WIDE UNLESS OTHERWISE NOTED

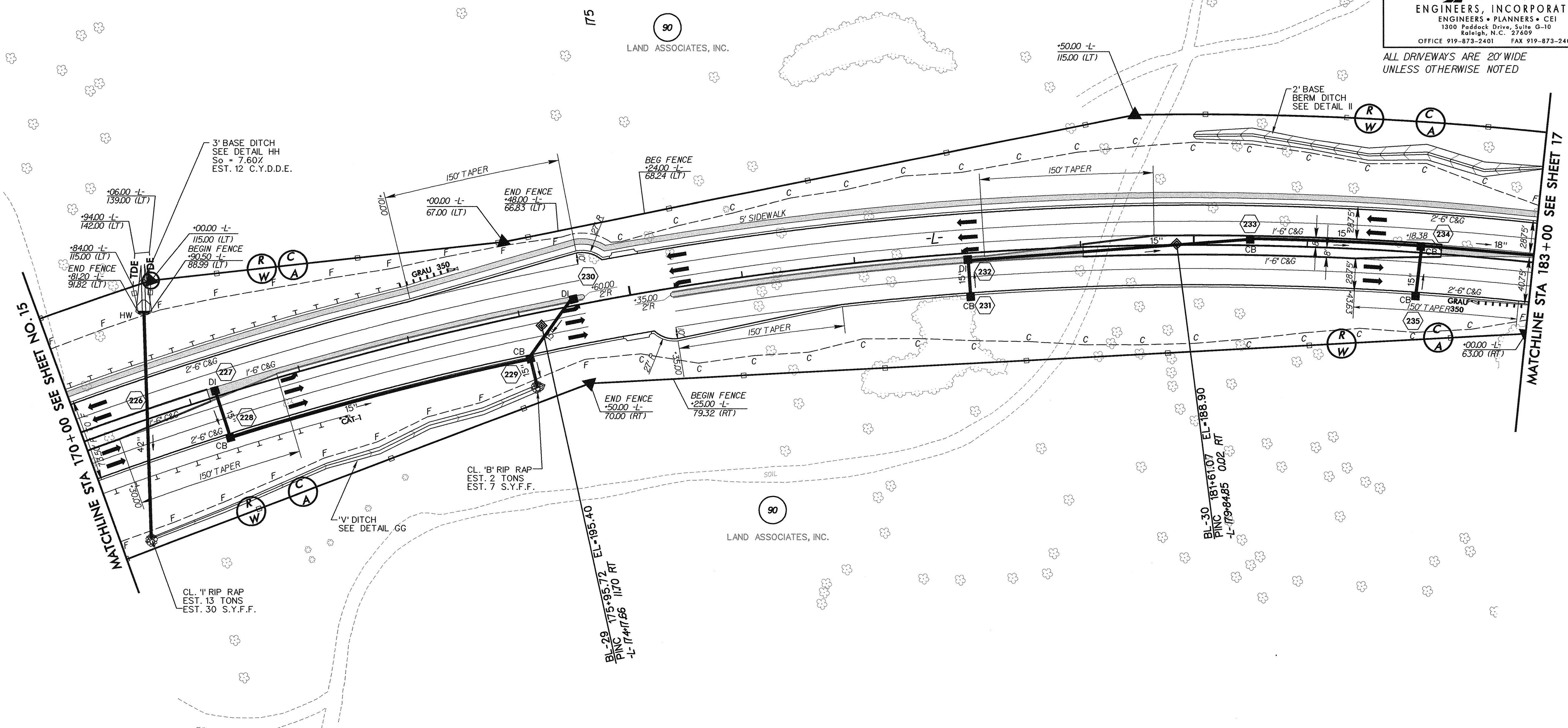

| -L-               |                        |                   |
|-------------------|------------------------|-------------------|
| PIs Sta 157+68.32 | PI Sta 172+07.60       | PIs Sta 184+58.60 |
| Es = 1' 45" 00.0" | Δ = 51' 28" 19.8" (RT) | Es = 1' 45" 00.0" |
| Ls = 175.00'      | D = 2' 00" 00.0"       | Ls = 175.00'      |
| LT = 116.67'      | L = 2,573.61'          | LT = 116.67'      |
| ST = 58.34'       | T = 1,380.95'          | ST = 58.34'       |
|                   | R = 2,864.79'          |                   |
|                   | SE = 0.035             |                   |
|                   | INC = 50               |                   |

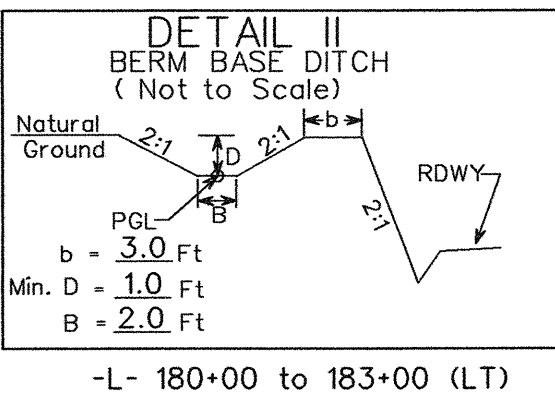
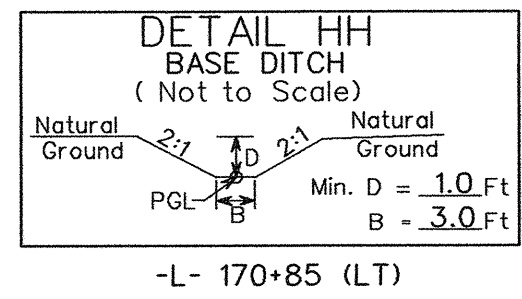
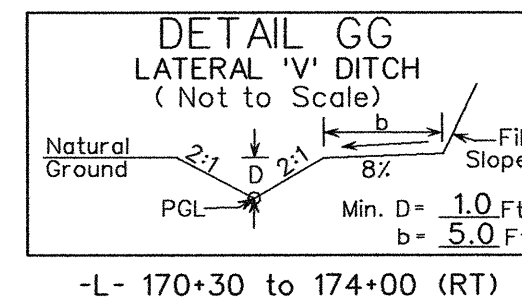

- 5' MONOLITHIC ISLAND (KEYED IN) & SIDEWALK
- PAINT STRIPED LANE CLOSURE
- PAVEMENT REMOVAL

7/2/99

12:55:42 PM Proj\U0620\_rdy\_psh\_16.dgn 07/23/2004