

7/2/99

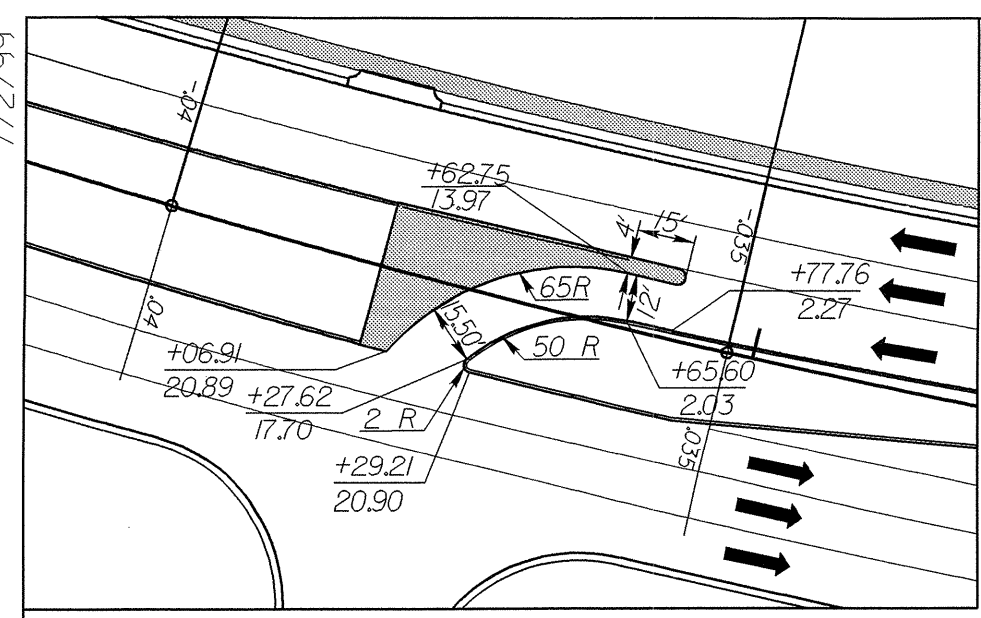

-L-
 Pls Sta 24+53.30 $\Delta = 18^\circ 15' 47.5" (LT)$
 $\Delta s = 1^\circ 29' 59.8"$ $D = 2^\circ 00' 00.0"$
 $\Delta s = 1^\circ 52' 30.2"$ $Ls = 150.00'$
 $LT = 77.80'$ $T = 460.49'$
 $ST = 72.24'$ $SE = 0.035$
 $INC = 50$

-Y2-
 Pls Sta 14+39.83 $\Delta = 15^\circ 38' 28.9" (RT)$
 $\Delta = 6^\circ 45' 00.0"$
 $L = 231.72'$
 $T = 116.59'$
 $R = 848.83'$
 $SE = 05$
 $INC = 36$

SEE SHEET 25 FOR -L- PROFILE
 SEE SHEET 33 FOR -Y1- PROFILE
 SEE SHEET 33 FOR -Y2- PROFILE
 SEE SHEET 33 FOR -DET2- PROFILE
 SEE SHEET 37 FOR -SERVI- PROFILE

PROJECT REFERENCE NO. U-0620	SHEET NO. 5
RW SHEET NO.	
ROADWAY DESIGN ENGINEER NORTH CAROLINA PROFESSIONAL SEAL 300761 5/10/06	HYDRAULICS ENGINEER NORTH CAROLINA PROFESSIONAL SEAL 18442 5-19-06

Carter-Burgess
 Consultants in Planning, Engineering, Architecture, Construction Management and Related Services
 581 Glenwood Avenue, Suite 300
 Raleigh, North Carolina 27609
 OFFICE 919-873-2401 FAX 919-873-2404

TRANSITE CONSULTING ENGINEERS, INCORPORATED
 ENGINEERS & PLANNERS & CEI
 1300 Paddock Drive, Suite G-10
 Raleigh, N.C. 27609
 OFFICE 919-873-2401 FAX 919-873-2404

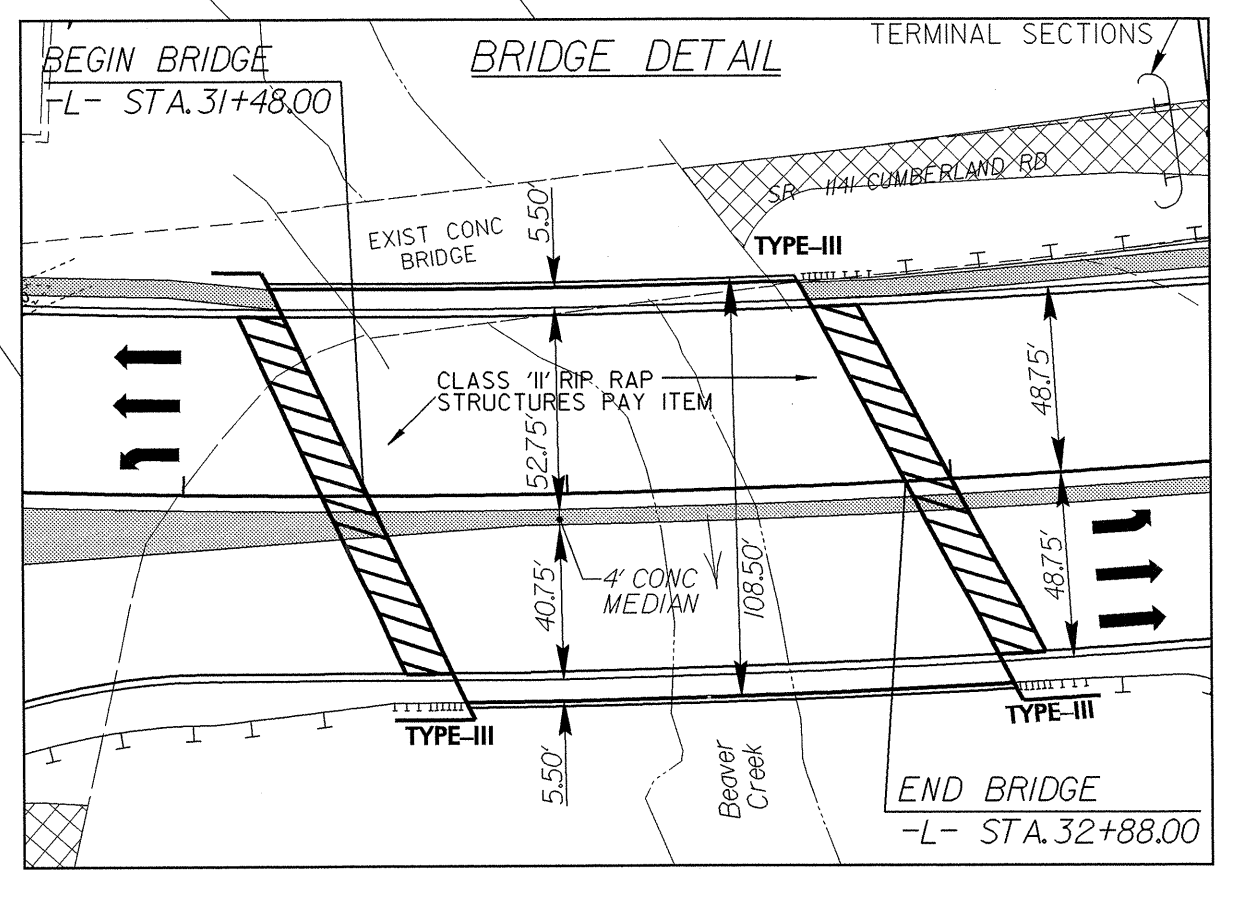
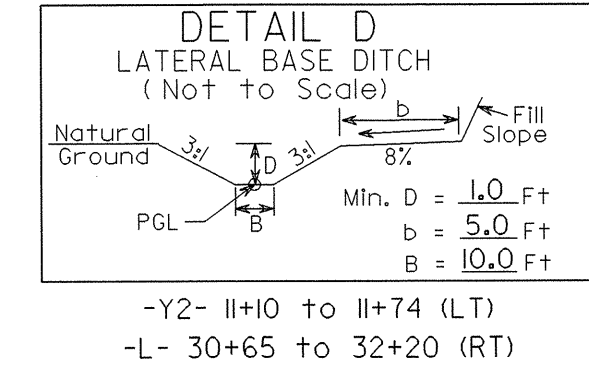
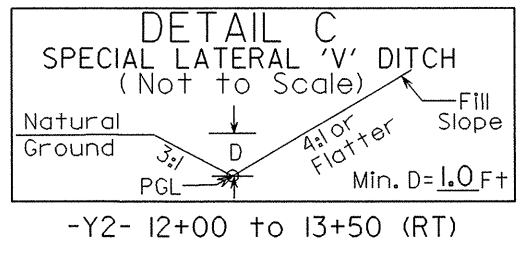
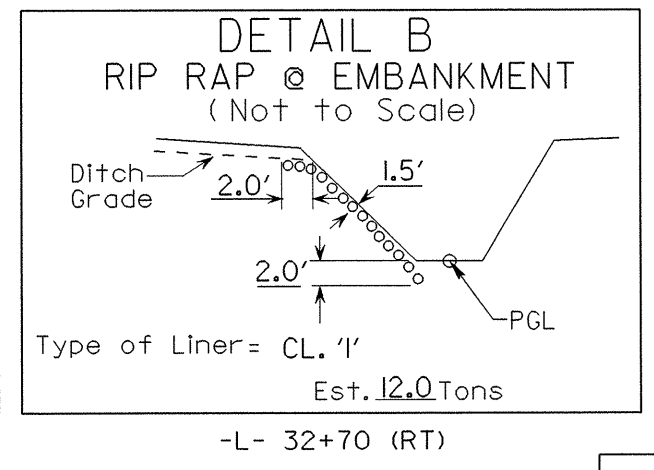
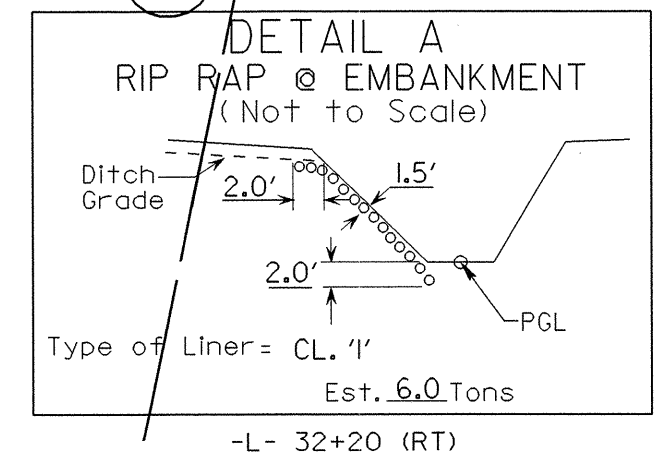
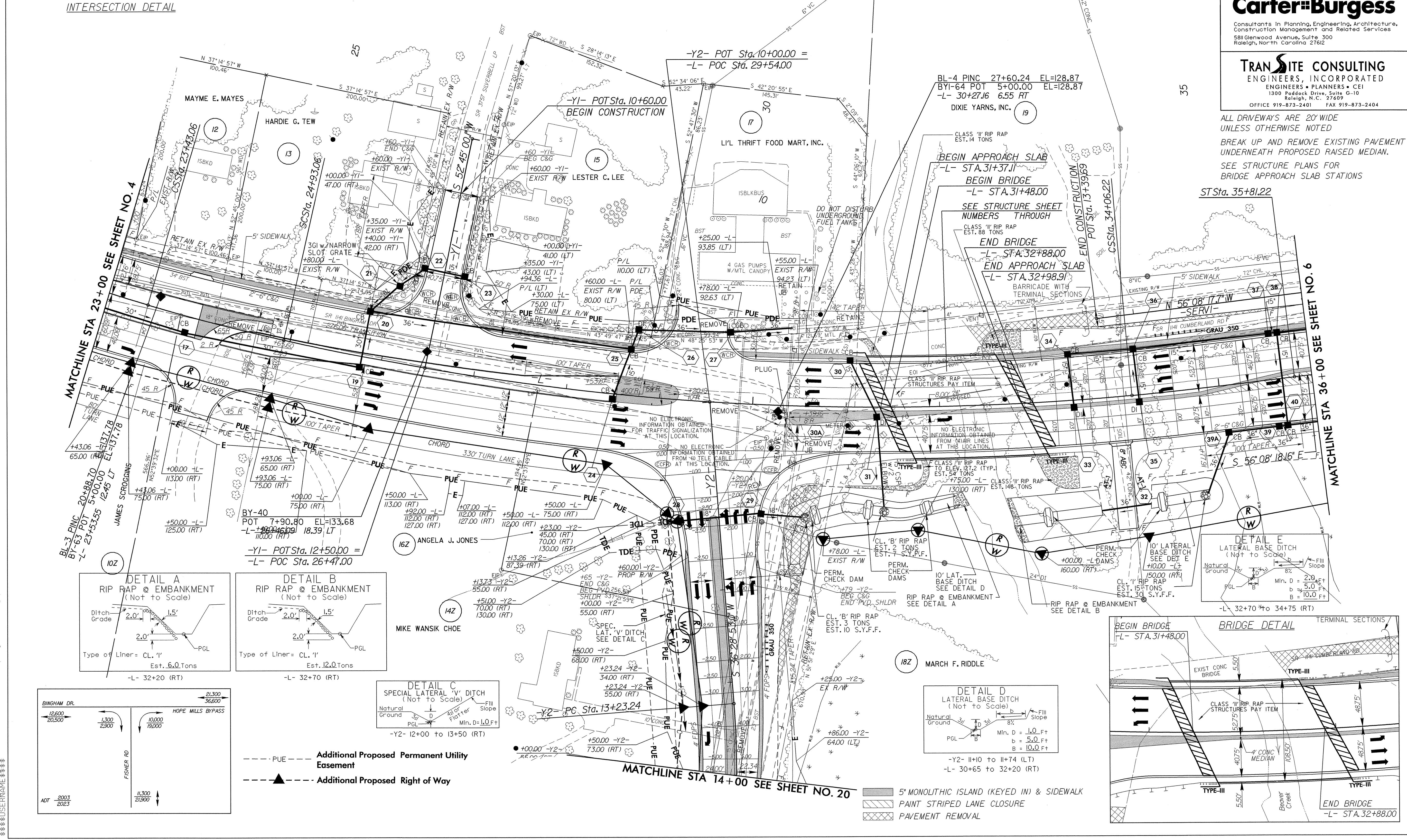

03-MAY-2006 11:03 up to date fisher road\proj\0620_rdy_psh_05-3lane.dgn

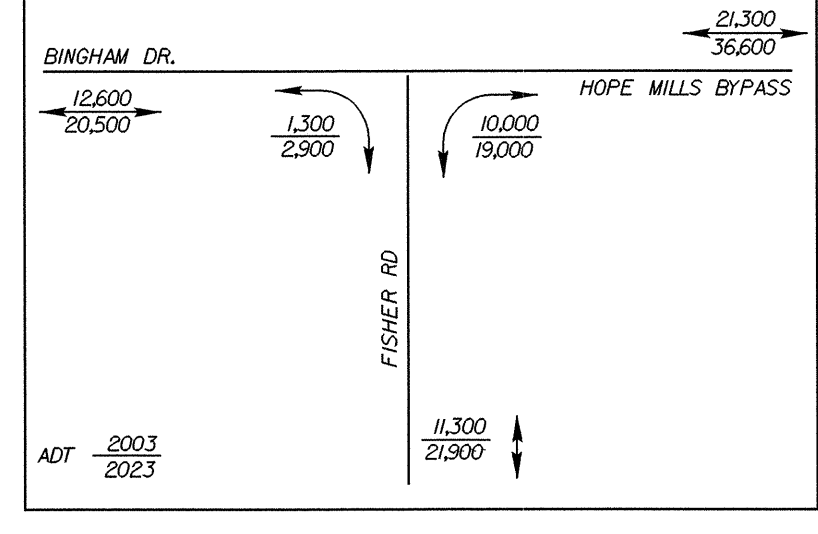

--- PUE --- Additional Proposed Permanent Utility Easement
 ---▲--- Additional Proposed Right of Way

5" MONOLITHIC ISLAND (KEYED IN) & SIDEWALK
 PAINT STRIPED LANE CLOSURE
 PAVEMENT REMOVAL

ALL DRIVEWAYS ARE 20' WIDE UNLESS OTHERWISE NOTED
 BREAK UP AND REMOVE EXISTING PAVEMENT UNDERNEATH PROPOSED RAISED MEDIAN.
 SEE STRUCTURE PLANS FOR BRIDGE APPROACH SLAB STATIONS