

PROJECT REFERENCE NO.	SHEET NO.
U-0620	EC-6/CONST.7
RW SHEET NO.	
ROADWAY DESIGN ENGINEER	HYDRAULICS ENGINEER

ALL DRIVEWAYS ARE 20' WIDE UNLESS OTHERWISE NOTED
 BREAK UP AND REMOVE EXISTING PAVEMENT UNDERNEATH PROPOSED RAISED MEDIAN.

SEE SHEET 26 FOR -L- PROFILE
 SEE SHEET 34 FOR -Y5- PROFILE
 SEE SHEET 34 FOR -Y6- PROFILE

<p>-L- PI Sta 53+40.29 $\Delta = 5'06'' 39.9''$ (LT) $D = 1'15'' 00.0''$ $L = 408.89'$ $T = 204.58'$ $R = 4,583.66'$ $SE = 0.025$ $INC = 60$</p>	<p>-L- PI Sta 65+53.29 $\Delta = 2'21'' 32.9''$ (LT) $D = 0'15'' 00.0''$ $L = 943.66'$ $T = 471.90'$ $R = 22,918.31'$ $SE = NC = 0.025$</p>	<p>-Y5- PI Sta 12+22.86 $\Delta = 24'02'' 57.2''$ (RT) $D = 25'00'' 00.0''$ $L = 96.20'$ $T = 48.82'$ $R = 229.18'$ $SE = EXIST$</p>
---	--	---

NOTE: PLACE TEMPORARY ROCK SEDIMENT DAMS TYPE-B AND TEMPORARY ROCK SILT CHECKS TYPE-A AT DRAINAGE OUTLETS.

CLEARING AND GRUBBING EROSION CONTROL FOR CONSTRUCTION SHEET 7

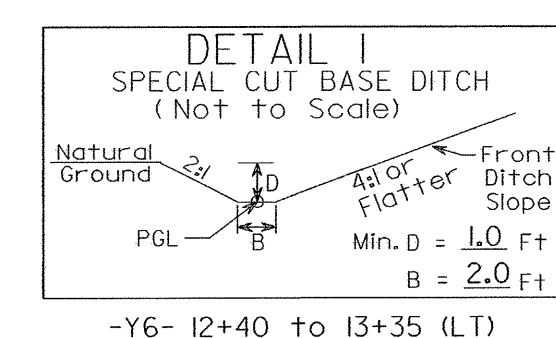
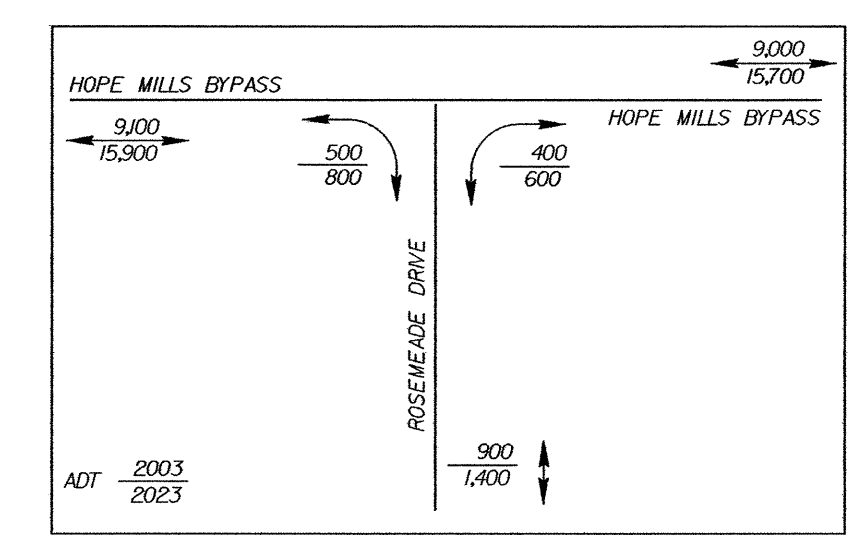
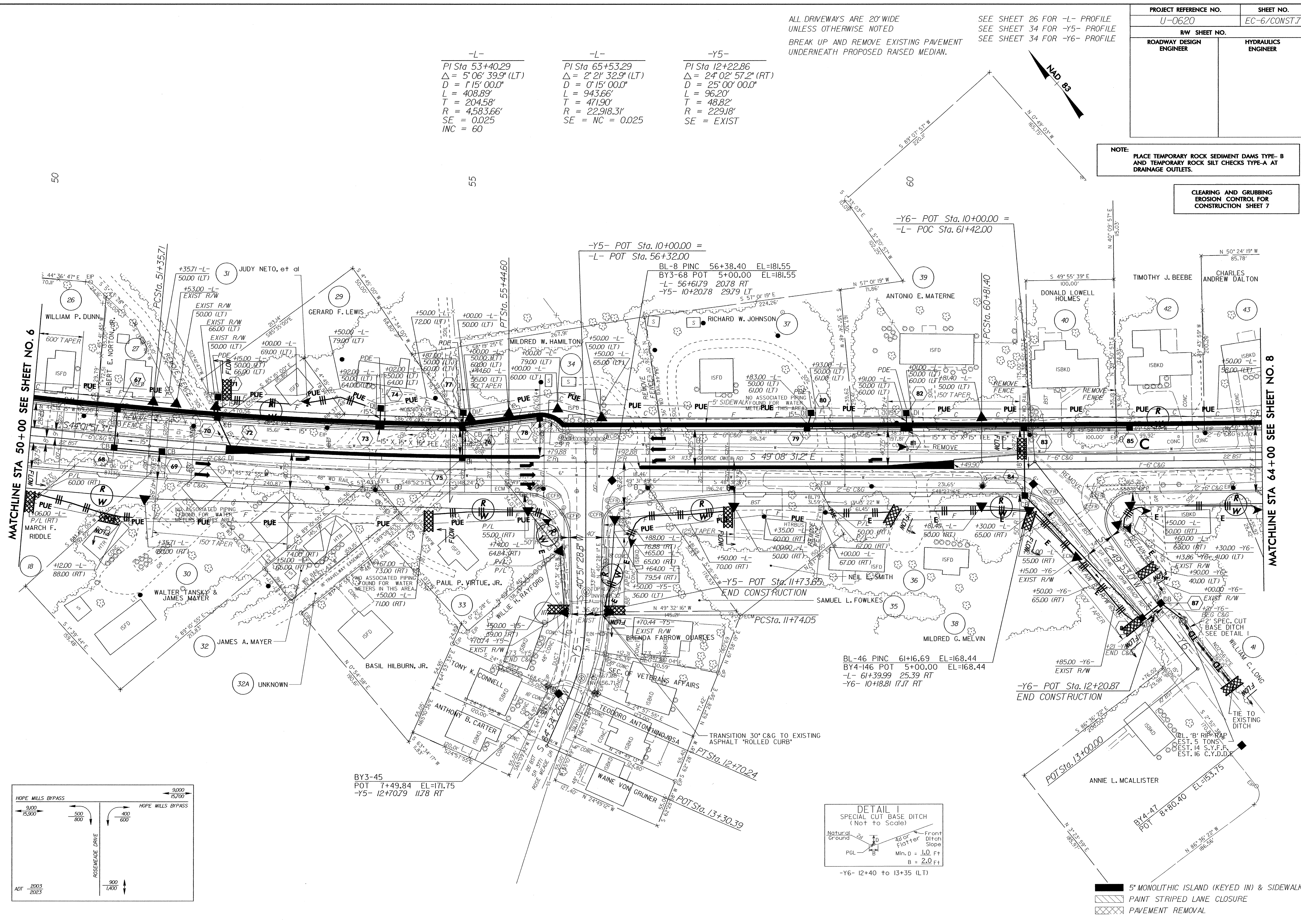

- 5' MONOLITHIC ISLAND (KEYED IN) & SIDEWALK
- PAINT STRIPED LANE CLOSURE
- PAVEMENT REMOVAL

MATCHLINE STA 50+00 SEE SHEET NO. 6

MATCHLINE STA 64+00 SEE SHEET NO. 8