

07/26/2008

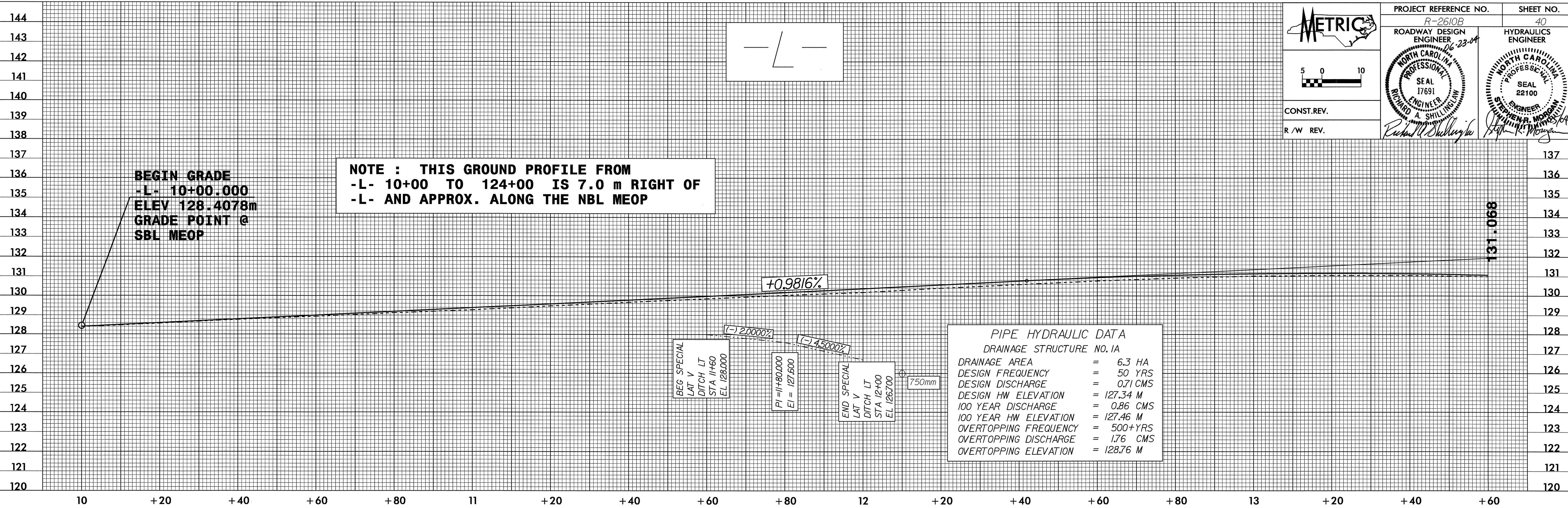

**METRIC**

PROJECT REFERENCE NO. R-2610B  
ROADWAY DESIGN ENGINEER  
06-23-04

SHEET NO. 40  
HYDRAULICS ENGINEER

5 0 10

CONST. REV.  
R / W REV.

**PROFESSIONAL SEAL**  
NORTH CAROLINA  
17691  
RICHARD A. SHILLINGHAM  
ENGINEER

**PROFESSIONAL SEAL**  
NORTH CAROLINA  
22100  
STEPHEN W. MORROW  
ENGINEER

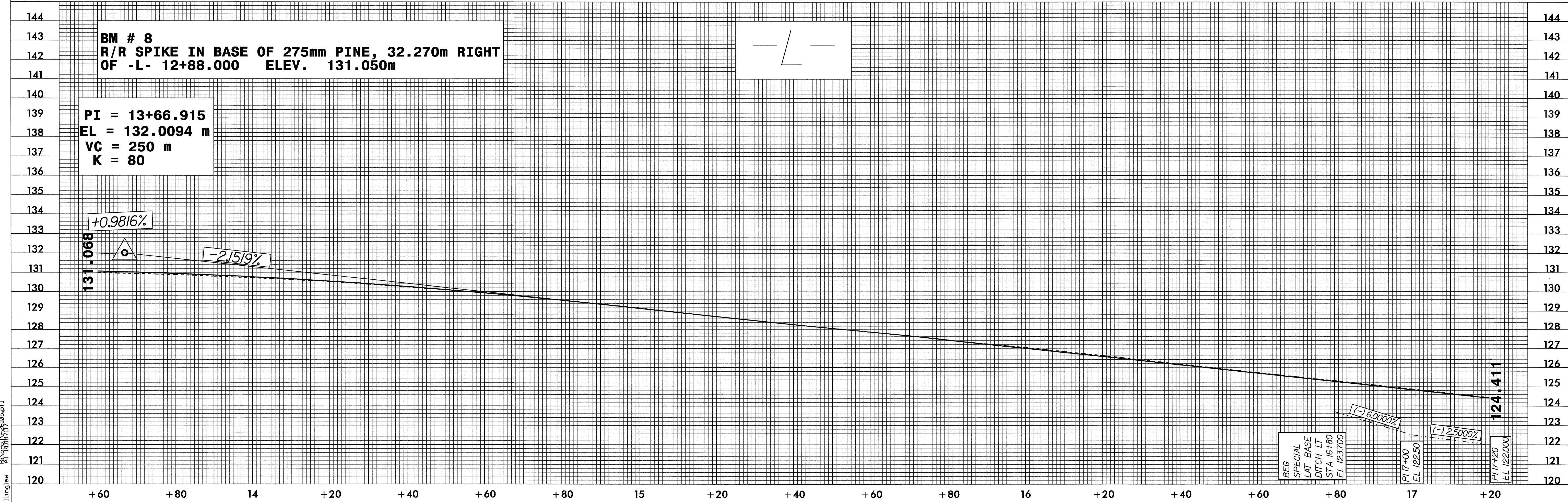

29-MAR-2004 13:55  
RShillingham At R001717