

STATE OF NORTH CAROLINA
DIVISION OF HIGHWAYS

STATE	STATE PROJECT REFERENCE NO.	SHEET NO.	TOTAL SHEETS
N.C.	R-2610B	3	59
STATE PROJ. NO.	F.A. PROJ. NO.	DESCRIPTION	
6.529005T		P.E.	

METRIC
ALL DIMENSIONS IN THESE PLANS ARE IN METERS AND/OR MILLIMETERS UNLESS OTHERWISE SHOWN

PRELIMINARY PLANS
DO NOT USE FOR CONSTRUCTION
INCOMPLETE PLANS
DO NOT USE FOR R/W ACQUISITION

R-2610B
PROJECT: 6.529005T

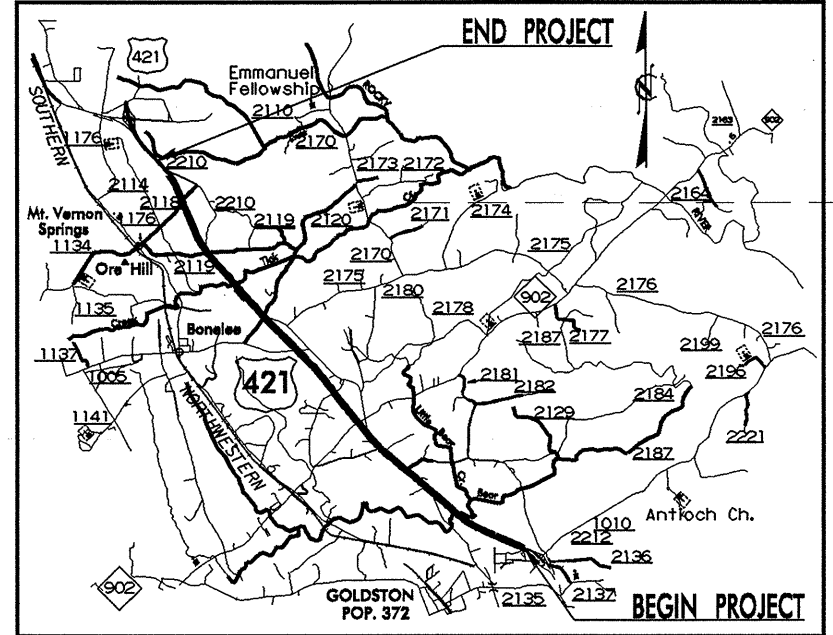

PROJECT VICINITY MAP

LOCATION: US 421 FROM APPROX 1.0 KM NORTH OF SR 1010 TO THE 4 LANE BYPASS SOUTH OF SILER CITY
TYPE OF WORK: GRADING, DRAINAGE, PAVING, GUARDRAIL, AND STRUCTURES

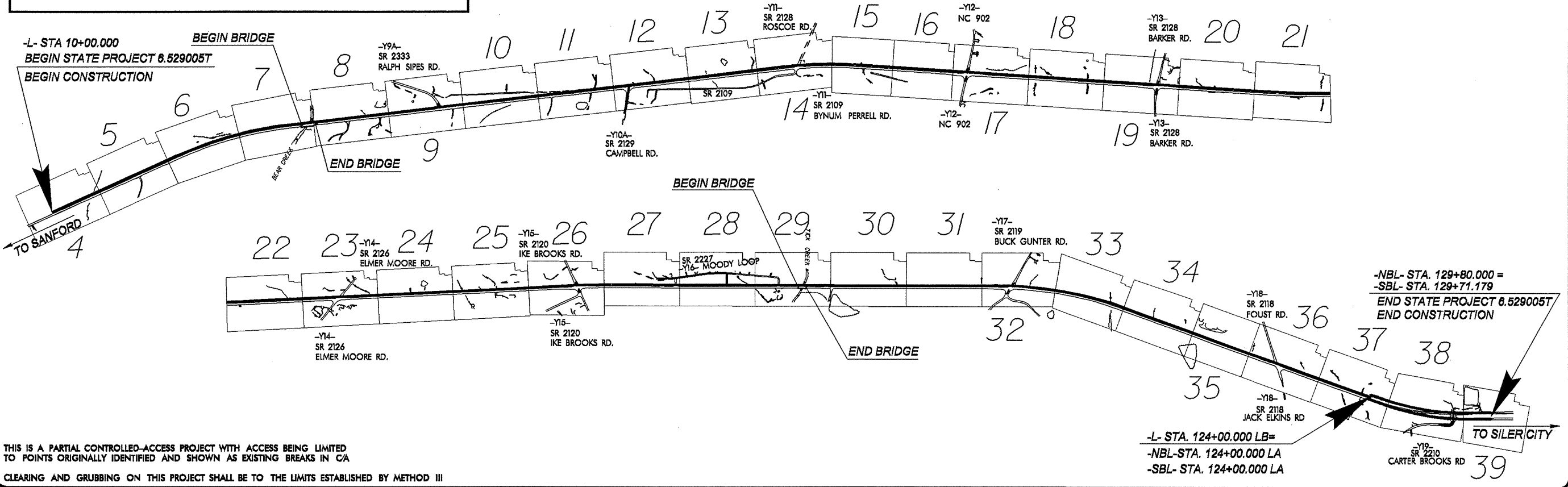

THIS IS A PARTIAL CONTROLLED-ACCESS PROJECT WITH ACCESS BEING LIMITED TO POINTS ORIGINALLY IDENTIFIED AND SHOWN AS EXISTING BREAKS IN CA
CLEARING AND GRUBBING ON THIS PROJECT SHALL BE TO THE LIMITS ESTABLISHED BY METHOD III

GRAPHIC SCALES 	DESIGN DATA	
	ADT 2004 = 11776-13297	
	ADT 2024 = 18466-20538	
	DHV = 10 % D = 60 % T = 17 % * V = 100 km/h * TTST 13% DUAL 4 %	

PROJECT LENGTH	
LENGTH ROADWAY PROJECT 6.529005T	= 11.882 km
LENGTH STRUCTURE PROJECT 6.529005T	= 0.098 km
TOTAL LENGTH OF STATE PROJECT 6.529005T	= 11.980 km

Prepared in the Office of: DIVISION OF HIGHWAYS 1000 Birch Ridge Dr., Raleigh, NC 27610	
1995 STANDARD SPECIFICATIONS	
RIGHT OF WAY DATE: APRIL 19, 2002	S.R. FLOWERS PROJECT ENGINEER
LETTING DATE: FEBRUARY 17, 2004	R.A. SHILLINGLAW, PE PROJECT DESIGN ENGINEER

HYDRAULICS ENGINEER	DIVISION OF HIGHWAYS STATE OF NORTH CAROLINA
SIGNATURE: _____ P.E.	STATE DESIGN ENGINEER
ROADWAY DESIGN ENGINEER	DEPARTMENT OF TRANSPORTATION FEDERAL HIGHWAY ADMINISTRATION
SIGNATURE: _____ P.E.	APPROVED DIVISION ADMINISTRATOR
	DATE