

10/26/28

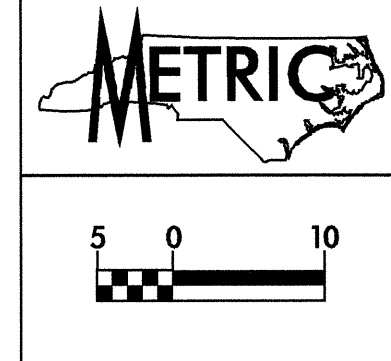

PROJECT REFERENCE NO. R-2610A	SHEET NO. 2-F
R/W SHEET NO.	
ROADWAY DESIGN ENGINEER	
NORTH CAROLINA PROFESSIONAL ENGINEER SEAL 17691	
RICHARD A. SHILLING	

**-Y7- S.MAIN STREET SR 2333**

-Y7-			
DUALS	4%	1,807	
TTST	10%	3,324	
DHV	10%		2004 ADT
DIR	60%		2024 ADT

S.MAIN ST. SR 2333

-L-			
DUALS	4%		
TTST	13%		
DHV	10%		
DIR	60%	1,062	745
		2,717	607

US 421 12,321 20,872      US 421 12,003 18,762

-Y7A-	-Y7-
PI Sta 10+30.475	PI Sta 11+15.159
$\Delta = 34^{\circ} 01' 16.6''$ (RT)	$\Delta = 44^{\circ} 45' 04.7''$ (RT)
L = 34.380	L = 136.395
T = 17.714	T = 71.890
R = 57.900	R = 174.629

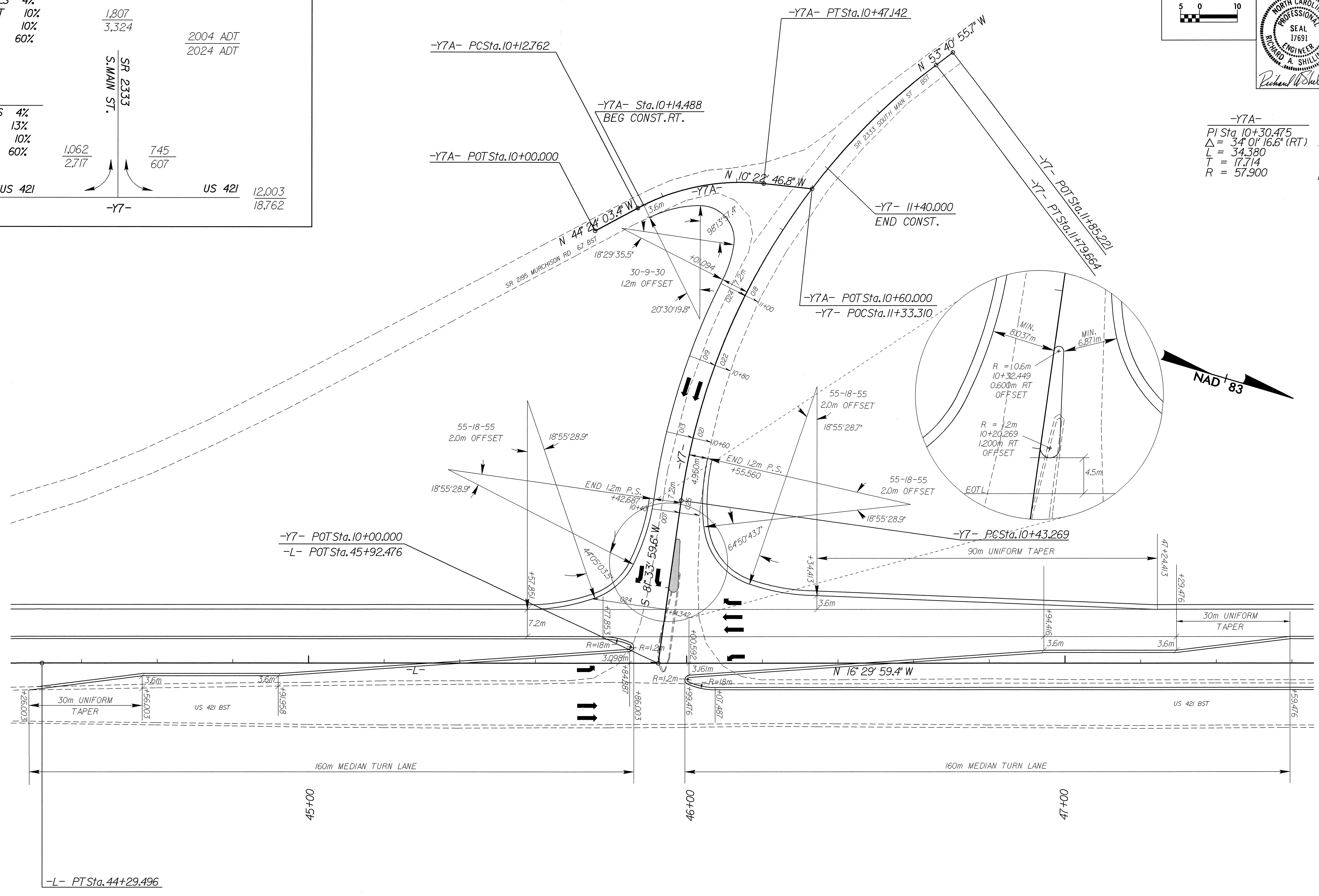

05-NOV-2023 11:39 Y7-DETAIL\_030807.DGN