

8/17/03

REVISIONS

03-NOV-2003 01:56
D:\projects\2610\plan\8812

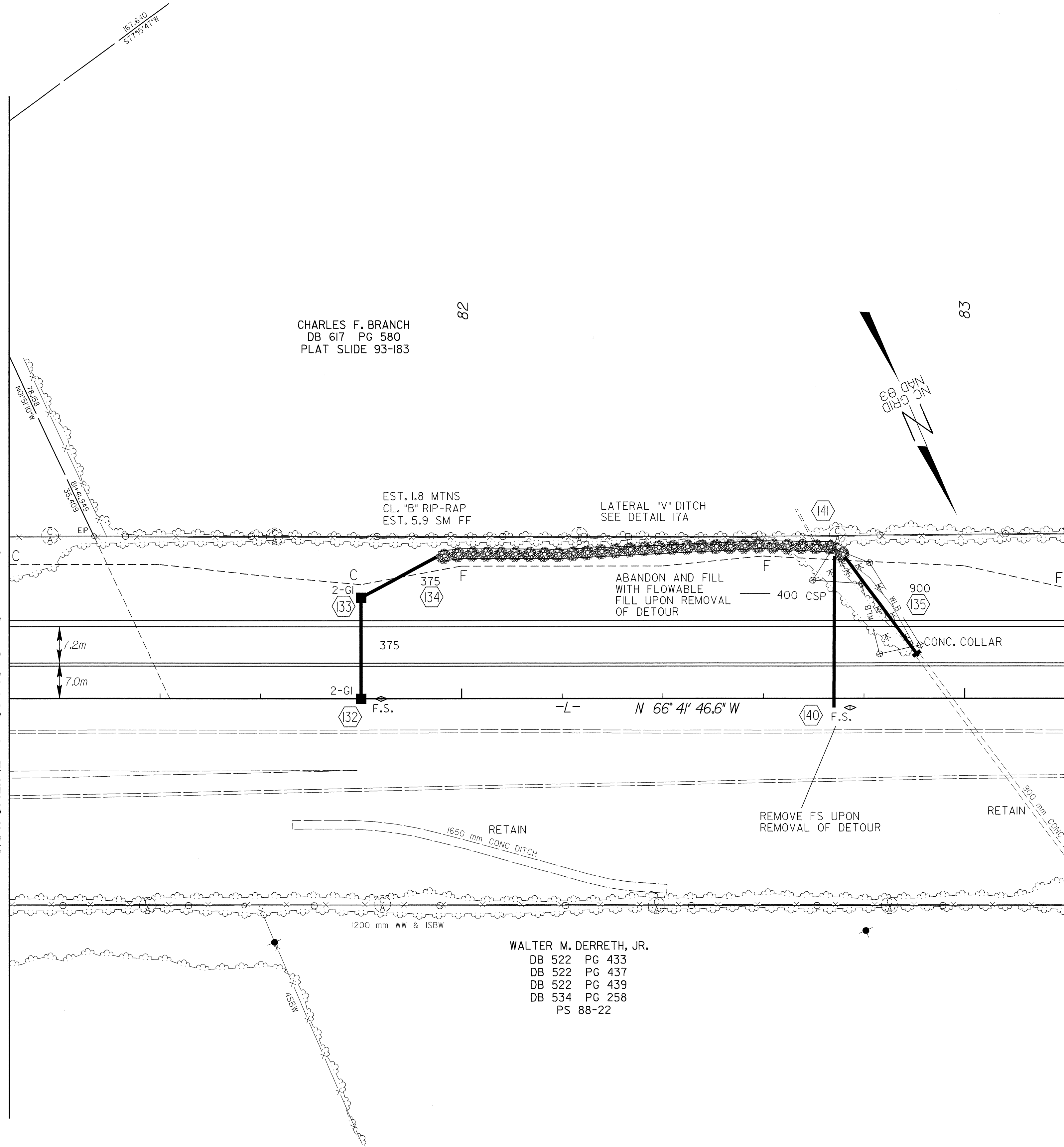

CHARLES F. BRANCH
DB 617 PG 580
PLAT SLIDE 93-183

WALTER M. DERRETH, JR.
DB 522 PG 433
DB 522 PG 437
DB 522 PG 439
DB 534 PG 258
PS 88-22

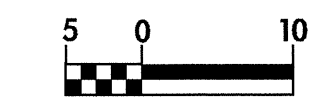
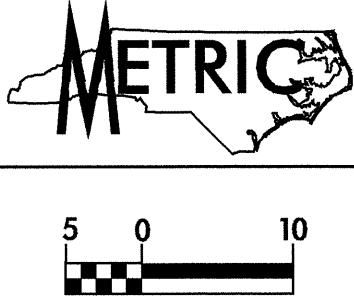

CONST. REV.

R / W REV.

PROJECT REFERENCE NO. R-2610 A	SHEET NO. 26
R / W SHEET NO.	
ROADWAY DESIGN ENGINEER Richard A. Shillingham NORTH CAROLINA PROFESSIONAL SEAL 17691 12-11-03	HYDRAULICS ENGINEER STEVE M. BONDOR NORTH CAROLINA PROFESSIONAL SEAL 12786 12-15-03

SEE SHEET 37 FOR -L- PROFILE
SEE SHEETS 2-H & 2-I FOR DITCH DETAILS
SEE SHEET 37 FOR DITCH PROFILES